

Pizza Hut

**\$15 large Pizza
3 toppings**

**Monday-Friday
8pm-close**

901 E 7th St. | Wayne | 402-375-2540

MidwestLand

COMPANY

206 Main St. | Wayne, NE 68787 | Office: 402-375-3385

**Protect your investment
for future generations!**

Farm Management – Farm Sales

Call for info: 402.375.3385
www.midwestlandco.com

SHOE SALE!

BUY 1, GET 2ND

50% OFF

1/2 Off Less Priced of 2 pairs

KEEN

TeVa

SKECHERS

joybees

ACE
Hardware & Home



**Elkhorn Valley
BANK**

AND TRUST

Member FDIC

411 East 7th Street | Wayne, NE 68787

402-375-2525

www.elkhornvalleybank.com

Presorted Standard
ECRWS
U.S. Postage Paid
morning shopper



morning shopper

A publication of The Wayne Herald • 402.375.2600 • 114 Main • Wayne, NE 68787 • Tuesday, August 20, 2024 • Vol. 90 No. 34

TWO LUCKY VOTERS WILL WIN

\$100



Visit thewayneherald.com EVERY day to vote!



THE WAYNE HERALD



morning shopper

Voting ends September 2, 2024!

You can vote once per category per day

All voting will take place on thewayneherald.com

All registered voters will be eligible
to win \$100!

*Help us recognize the people,
businesses and organizations that
show the best of our community!*



Adult Clothing
Consignment,
Household
Donations, New
Retail Items/
Gifts...Old, New,
and everything in
between!

121 Main St. Wayne, NE

402-833-1810

Open Monday-Saturday 10 am - 5 pm

Time To Start Voting!

Voting Runs from August 6 to September 2



402-369-6820 414 Main St. Winside NE

WAYNE COUNTRY CLUB

302 East 21st St. | Wayne, Nebraska 68787 | 402-375-1152
www.waynecountryclub.com



Kyle Schellpeper
PGA Golf Professional



MAIN STREET

Full Service

Major &
Tune-ups . Oil Changes . Engi

24/7 Towing & Rep

614 Main Street

402-3



Fresh & Silk Floral
Gifts & Home
Decor



301 Main Street • Downtown Wayne • 531-519-6770

Store Hours: Monday-Friday 9:00-5:30 • Saturday 10:00-3:00



STATE NATIONAL INSURANCE COMPANY

BRIAN BOWERS & MARY JENKINS

1010 N Main Street, Suite 110

Wayne, NE

402-375-4888



banking that feels right



fmbankne.bank
800.235.5331

Gretna . Sioux City . South Sioux City . Wayne . West Point

FRAHM & SONS

TREE & YARD SERVICES, LLC



- Family owned
- Fully insured
- Serving Winside & surrounding area
- Bucket Truck Services
- Tree Trimming & Removal
- Storm Clean-Up
- Stump Grinding

SHANE FRAHM

402.851.0524 • POB 246 • WINSIDE, NE

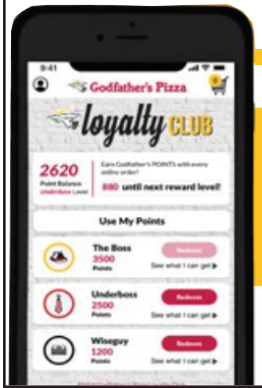

Order
our
star

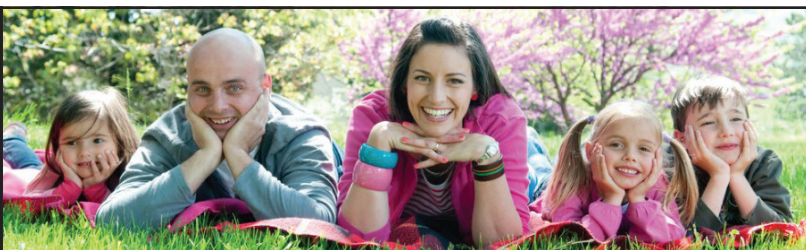

A *Healthy* SMILE IS A *Beautiful* SMILE
Let Us Help You Start Every Morning With A **SMILE!**

FAMILY 1ST DENTAL

402.375.2889 | "Where Your Family Comes First!" | Mitchell Knudsen, DDS



KINSHIP POINTE
Independent Living and Assisted Living
Wayne



Please Vote For Us For Best Assisted Living 2024.



Scan the QR code to vote for us
starting August 6th.

402-375-1500 | www.KinshipPointe.com | 1500 Vintage Hill Dr, Wayne, NE 68787

JAEGER

402-3
85142
Winsid



402.833.1500

311 Main Street | Wayne, NE

M-W: 10am - 10pm | T-Sat: 10am - 11pm | Sun: 12pm - 9pm

@hippiechickn
Scan for our website!



Johnnys Pest Control



Call... 402-369-2938



603 Main Street • 402-375-

T GARAGE
 Repair Shop
 Repairs
 Air . Brake Repair . Alignments
Side Assistance
 Wayne, NE 68787
-4420

AUTO ANATOMY
alternatives LLC

 1320 W. 7th Street | Wayne, NE 68787 | 402-833-1117
 Painting - Bodywork
 Glass Repair & Replacement
 Frame & Unibody Straightening

face time
 AESTHETICS
 Licensed Esthetician Jessi Hochstein
 120 W. 3rd St. | Wayne, NE | 402-360-1253
 face-time-aesthetics.square.site for online booking

Larry Korth
 owner
 Cherry St. Creston, NE 68631
402-910-9878
 korthroofing@gmail.com
 Serving Creston, Norfolk, Columbus and
 surrounding areas.
 Exterior Improvements
 Free Insurance Inspections
 Free Estimates Insured
ROOFING LLC

ALLOFIBER.COM/WAYNE

 (531) 519-6050

Campbell's Service LLC
 Contact us for all your
 plumbing, electrical and
 HVAC needs
 108 East 2nd • Laurel
402-256-3572



Godfather's Pizza
 402-833-5077
 Through
 to
 Learning
 S MAIN STREET
 WAYNE, NE

Wayne Community Schools

 "Learning for Life,
 Every Student,
 Every Day"
www.wayneschools.org

Carhart LUMBER CO.
 105 Main Street | Wayne | 402-375-2110
www.carhartlumber.com

SEEDS
 -0601
 th Ave.
 E 68790



we treat people like people.
 because, they're people.
 simple human sense
Northeast Nebraska Insurance Agency
 Wayne 375-2696 • Wakefield 287-9150
 Laurel 256-9138 • Pender 385-6500

Wayne

 Care and
 Rehabilitation
 402-375-1922 | 811 E. 14th Street | Wayne | waynecountryview.com

Stop in and see us
 for your next fill up!

Fastwyre
 Broadband



HAPPY TASTES GOOD
 708 Main St.
 402-375-1404

- Residential Trash & Recycling
 - Commercial Trash & Recycling
 - Recycling
 - Roll-Offs
 - Portable Restrooms
 - Demolition
 - Industrial Waste Removal



Recycling • Refuse • Roll-offs



New Service Areas:
Wayne
Wakefield
Laurel
Pender

402.727.6806
S2rolloffs.com

preloved is reloved

Refind & Refresh

Stop in to refresh your space!

Consignment, Thrift and Upcycling



104 W 2nd Street
Wayne, NE 68787
402.518.8227



EST. 1998
SCOOTER'S COFFEE



527 EAST 7TH STREET
WAYNE, NE

PAC N SAVE



GROCERY STORE

1115 West 7th Street • Wayne, NE • 402-375-1202
www.pacnsavegrocery.com

SIDELINES
Bar & Grille



206 MAIN ST 402.287.2957

Providence Community Pharmacy



Friendly Faces

Open Monday-Friday
9:00am- 6:00pm.

Saturdays
9:00am- 2:00pm

Convenient Drive-Thru

Curbside Deliveries

803 Providence Rd. Suite 101 | 402-375-8862 | providencecommunitypharmacy.com



24 HOURS EMERGENCY WATER RESTORATION

STANLEY STEEMER

Mon - Sat
8 AM - 5 PM
Sunday:
Emergencies Only!

VISA MasterCard

STANLEY STEEMER
402-641-9851 • 119 Maple St. • Concord

PRIME STOP

CONVENIENCE STORES

Open 24 hours a day, 7 days a week!



1330 East 7th Street | Wayne
402-375-1449



WASTE CONNECTIONS OF NEBRASKA
www.NorfolkWasteConnections.com

Serving Northeast Nebraska:

- Trash & Recycling
- Residential, Commercial & Roll-off
- Curbside, Co-mingled Recycling Service

Professional Customer Service
Safety • Integrity

Call 402-644-8300 • 800-871-5566



Come and take a tour by calling us at
402-287-2244
or visit us online at
www.wakefieldcarecenter.com

WAKEFIELD HEALTH CARE CENTER
306 Ash St.
Wakefield, NE



morning shopper

Tuesday, August 20, 2024

SECTION B

Backhoe - Septic Services

Certified installer for
Septic, Drain Fields,
Holding Tanks & Repair

Trenching, Footings,
Concrete Removal & Demolition
Dump Truck Services Available

Ross Lund

712-898-4499
402-945-2161



LET'S TAILGATE, WAYNE HIGH! FALL SPORTS KICK OFF

Wayne Kern Track

Friday, Aug 23 at 7:00pm

Serving hot dogs, hamburgers &
chips @ 6:30pm
Coaches will speak & introduce
their fall line-ups!

*Purchase a Wayne Booster Membership and
sponsorships to support the many
Wayne High School activities we will have this year!
Adult and Student passes will be available to purchase.*

*Bring your lawn chair



Kinship Pointe Wayne

- Large Spacious Floor Plans
- Established Care Team 24/7
- Great Food & Engaging Activities
- Excellence In Senior Living Every Day

CALL
402-375-1500
TO SCHEDULE
A TOUR

402-375-1500

1500 Vintage Hill Dr. Wayne, NE 68787

kinshippointe.com



Deadpool & Wolverine R TWO WEEKS!

Thursday - 8:15 pm | Friday - 7 pm | Saturday - 2pm & 7pm | Sunday - 2pm

Aug 22-Aug 25

Aug 29-Sept 1

ADMISSION IS JUST \$5!

(Box office opens 1 hour before each show)

Ad Courtesy of **Tom Hansen, CPA**

MAJESTIC
THEATRE

(Non-Profit)

310 Main Street • Wayne

402-833-1833

www.majesticonmain.org

** ATTENTION **

The second half of 2023 Wayne County Real Estate & Personal Property Taxes become delinquent on September 4th, 2024.

The ruling is, if someone pays ON or after September 4th, they will be required to pay interest. The County Treasurer does not have the authority to grant a grace period. Since August 31st falls on a weekend followed by a holiday, the taxpayer will have the following business day (September 3rd, 2024) to pay without incurring interest.

Please send payment along with your statement stub and phone # to:

Wayne County Treasurer

510 N Pearl Street, Ste 4 - Wayne, NE 68787-1939

(The Wayne County Courthouse is closed on Monday, September 2nd, 2024)

You may also use our drop box on the north side of the Courthouse.

A paid receipt will be mailed upon request.

Lisa Lindsay, Wayne County Treasurer

160 ACRES - WAYNE COUNTY LAND AUCTION

THURSDAY, SEPTEMBER 5, 2024 • 10 A.M.

Sale Location: American Legion Hall Post 252, Winside, Neb.

LEGAL DESCRIPTION

Northwestern Quarter (NW 1/4) Section 21-T25N-R2E, Wayne, County, Neb.

2023 REAL ESTATE TAXES

\$10,360.28

FSA INFORMATION

Cropland: 141.50 Acres

Corn Base: 105.10, PLC Yield: 135 bu.

Soybean Base: 36.40, PLC Yield: 47 bu.

TERMS:The successful bidder will enter into a real estate contract immediately upon conclusion of the auction, with a 10% down payment on the day of the auction. The balance will be due on or before October 7, 2024. Landlord possession on date of closing subject to tenant's rights until March 1, 2025. Full possession available March 1, 2025. Seller's agents shall order an owner's policy or title insurance in the amount of the sale price from a title company of their choice. The cost of title insurance will be shared equally by the seller and buyer. Sale is not contingent upon buyer's financing. 2024 real estate taxes will be paid by the seller.

CONDITIONS:This sale is subject to all easements, covenants and restrictions of record. All property is sold "as is - where is" with no warranties or guarantees expressed or implied by sellers or the auctioneers.

DISCLOSURE ACKNOWLEDGEMENT:It is understood the agents involved in the sale of this property are seller's agents and represent the seller as clients with buyers as customers.

ANNOUNCEMENTS:Property information provided herein was obtained from sources deemed reliable, but the auctioneer or seller makes no guarantees as to it's accuracy. All prospective bidders are urged to fully inspect the property, its condition and to rely on their own conclusions. All sketches, dimensions and acreage figures in this information are approximate or "more or less." Any announcements made auction day by auctioneer will take precedence over previous material or oral statements. Bidding increments are solely at the discretion of the auctioneer. No absentee or telephone bids will be accepted at the auction without prior approval of the auctioneer. All decisions of the auctioneer are final.

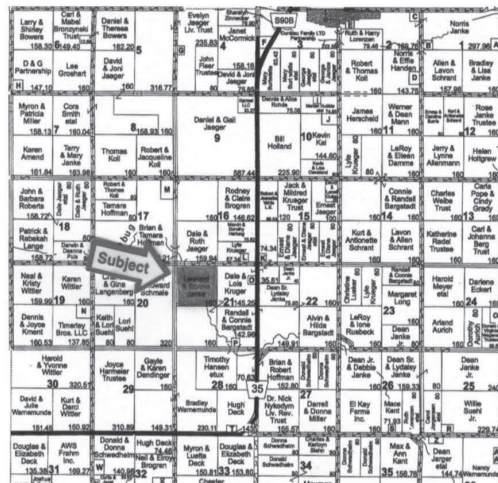

SELLERS:

LEONARD M.D. JANKE & BONNIE J. JANKE REVOCABLE TRUST
HAROLD S. JANKE TTEE & KRISTEN K. KRAUSE TTEE

Robertson, Nelson & Schuetze
Real Estate & Auction Service
Tekamah, Neb.

LAND AUCTION
Thurs., Sept. 5
Winside, Neb.

Seller: Leonard M.D. Janke & Bonnie J. Janke
Revocable Trust
Harold S. Janke TTEE & Kristen K. Krause TTEE

PLEASE POST



Contact:
Jan Schuetze, West Point, Neb., 402-380-0563
Bruce Robertson, Tekamah, Neb., 402-374-2545

Robertson, Nelson & Schuetze
Real Estate & Auction Service
402-374-2545
www.srnson.com

FOR RENT

GRAIN VAC for rent. Call Chuck Rutenbeck, Wayne at (cell) 402-375-7864.

FOR RENT: Nice 1, 2, 3, and 4 bedroom apartments. All new heat pumps and central air. No parties. Call 402-369-0771. tfn

FOR RENT or Lease at midcity plaza 202 W 2nd street and pearl in Wayne. Large office area or other uses. Contact Dawn at 402-518-0658. tfn

FOR RENT: Very nice 1 and 2 bedroom apartments for rent in Laurel and Wayne. Call Dawn at (402)518-0658. tfn

FOR RENT OR LEASE at Midcity Plaza 202 W 2nd Street and Pearl in Wayne. Large office area or other uses. Contact Dawn at 402-518-0658. tfn

FOR RENT: 4 bedroom house, 2 bath 1 block from campus, no pets, no parties, no smoking. 402-375-3657. tfn

Herman CHIROPRACTIC

Headaches • Sciatica • Low Back Pain
Athletic Injuries • Industrial Injuries
Smoking Cessation • Prenatal Care
Colic • Ear Infection • Bed Wetting

~ Same Day Service ~
~ New Patients Welcome ~

BCBS, Medicare, Medicaid, Midlands Choice, UHC, Workmans Comp, Coventry and most other insurances accepted

Chiropractic Care • Massage Therapy • Acupuncture
Orthotics • Health Products

1302 W. 7th Street
Wayne, Nebraska
(402) 375-3450

309 Main Street
Pender, Nebraska
(402) 385-0183

www.hermanchiro.com

we protect your house. because to you it's home.

simple human sense

Northeast Nebraska Insurance Agency

Wayne 375-2696 • Wakefield 287-9150 • Laurel 256-9138 • Pender 385-6500

Auto-Owners INSURANCE

LIFE • HOME • CAR • BUSINESS

Welcome Home!



214 West 2nd Street
\$225,000



612 Oak Drive
\$200,000



220 West 4th Street
\$239,000



513 Hillcrest Road
\$238,000



314 Sherman Street
\$170,000



714 Main Street
\$199,000



801 Pine Heights Road
\$199,000



85671 Highway 57, Carroll
\$150,000



86177 565 Avenue, Carroll
\$575,000



514 West 3rd Street
\$148,000



402 East 6th Street
\$175,000



312 Chapin Street, Winside
\$160,000

SOLD - 710 Michener Street, Wakefield



Trisha Peters
Broker/Owner
(402) 518-0675



Marie Janke
Sales Associate
(402) 369-2182

www.whitefarmhouserealty.com



219 Main Street, Wayne • (402) 375-HOME (4663)

BARGHOLZ AUCTION CALENDAR

FOR ALL YOUR SALE NEEDS CONTACT
RANDY BARGHOLZ 402-375-3258
www.bargholzauction.com

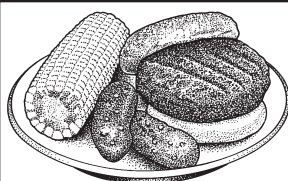

Thank You....
We'd like to thank all those that
attended Pilger's Annual Sweet
Corn & Hamburger Feed!

Thank you to all our dedicated and hard-working volunteers this year who helped us get Pilger's 22nd Annual Sweetcorn & Hamburger Feed set up! We know without you there is no way this event could happen. We want to thank all those who donated money towards all the supplies that are needed in order for us to have this event. Thank you to the Wisner-Pilger FFA students and their advisor who came to help husk and clean the corn. Every year, we have people from the Pilger, Wisner and Winside and surrounding areas who show up on Wednesday morning to husk and clean the corn. Some of those same morning volunteers come back Wednesday evening to grill burgers, cook corn and serve attendees. Also, thank you to the volunteers that stayed late and helped clean up the Cooper Center, mopped the floor and washed the large cooking kettles after this event. You are truly appreciated! THANK YOU to all of you! Giving your time and energy again this year is why we were able to clean over 3,000 ears of corn, grill 1,450 hamburgers and serve over 1,100 people.

The Louis and Abby Faye Dinklage Foundation graciously matched \$10,000. In addition to that, the Midwest Bank root beer floats raised \$1,677.23 —and along with some other additional donations — we deposited approximately \$25,779.13 into the Pilger Pool Fund account. A huge thank you goes out to everyone who donated to both the corn feed and the root beer floats, which are separate donations.) We want to thank each and every one of you for attending and giving your donations and for your continued support of this event.

Your donations continue to give children and families a fun, safe place to be on a hot, summer day. This summer approximately 120 kids took swimming lessons at the Pilger pool. The older teens are learning very important, life-saving water skills, which in turn can lead to them becoming lifeguards that will work at our local pool. Having a pool in Pilger provides an attraction to our village. It also provides numerous summer jobs for some of our young people in the area. Once again, THANK YOU for attending and for your support

We look forward to seeing you all again on the first Wednesday of August: August 6, 2025 for the 23rd year!

Sincerely, Ron and Barb Wolverton and Family

Bean Walkers

We Have Several Crews
Walk pastures with Canadian thistles, etc.
•Any type of farm work
•Put up, tear down fencing
(any fence work) •Cut Cedar trees
•Cover silage piles •Detasslers
•Over 29 years experience
200 mile radius of Wayne
For more info: 712-943-2084
712-251-3277



Look who's
turning 50!

May this year bring you
as much joy and laughter
as you have brought to
our lives.
Happy birthday,
Mindy!



Love,
Your Family



Wed. August 21, 2024
Top Crop Shop
88610 Hwy 57
Hartington, NE 68739
Begins at 5 pm

402-254-9500 www.topcropinc.com

Customer
Appreciation
Day



HELP WANTED

Farmers Cooperative

Wayne, Winside & Pilger

Part-time/Seasonal help for harvest

Help with unloading and loading grain trucks.

Help keep grain facilities clean and assist with any maintenance.

Competitive pay and overtime available.

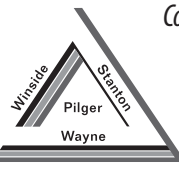

If you are interested in becoming part of our growing cooperative, please submit your application/resume to
325 W. 1st St. Pilger, NE 68768
or call Aaron Becker at 402-396-3414

RANCH HELP WANTED

Open Immediately

Remote Northeast Wyoming Ranch is looking for a

Full-Time Farm/Ranch Employee

Applicant must be self motivated, reliable and responsible with knowledge of haying and farming. Mechanical skills are a must. Farming duties include:

Swathing, baling and raking hay, etc. This is not a cowboy position, but applicant will need to assist in all aspects of cattle work as well. Those duties

include calving heifers, feeding hay, branding and gathering, etc.

Nearest big town is 60+ miles and nearest K-12 school is 30+ miles away.

Housing is provided and on a school bus route.

Please send resume with references by mail or e-mail to:

PeeGee Ranch

1251 Lower Powder River Road | Arvada, Wyoming 82831

pgranch@rangeweb.net | 307-736-2431

HELP WANTED

- FULL TIME L
- CHILD SUPPORT
CASE

- Legal Background/E
- Full Family Health Insu

Qualified applicants:

letter &

BRENT

HOLT COU

BRENT@

(Please, M

Employment Opportunities



WSC is accepting applications for the following positions.

WSC offers a competitive salary and an excellent benefits package including health/dental/vision insurance, retirement, tuition assistance (employee/family), paid leave time and paid holidays.

Violence Against Women Grant Project Director: Coordinate the work of the "Reduce Sexual Assault, Domestic Violence, Dating Violence, and Stalking on Campus Grant Program." The Director will work closely with Federal Grant Partners, Student Affairs and Academic Affairs, and the Coordinated Community Response team (CCR) to provide training for faculty and staff, plan violence prevention programs for students, and foster partnerships with law enforcement and service providers. The Project Director will also work with student educators and staff to assist with the planning, implementation, and assessment of gender-based violence prevention programs

Maintenance Repair Worker II-Grounds: This is a skilled classification level to perform general maintenance, repair, and construction activities within the grounds department or related disciplines. Work requires some independent judgment and decision-making skills in routine matters to determine proper work methods, time and materials required for each project. Work requires initiative, the ability to self-direct work and problem solve. Work requires the ability to inspect and diagnose the general nature of problems. Work must be performed in accordance with all applicable building codes, departmental policies, procedures, and protocols. Work environments will consist of indoor, outdoor, independent work or as a part of a team. Attractive & comprehensive fringe benefit package. Starting minimum wage for this position is \$36,845.

Office Assistant III (Business Services): This is an advanced classification that performs specialized clerical work of an administrative nature of varied scope and complexity requiring a broad knowledge of standardized policies and procedures, and confidentiality in the disposition of work matters. Work requires significant independent judgment, problem solving, and decision making skills within prescribed limitations. Interprets guidelines to specific situations that are not covered by policies or procedures. Work includes the maintenance of various record systems, the creation of reports involving payroll, employee, student, departmental records, and statistical data. Work also includes composing routine memoranda, correspondence and written materials requiring knowledge of institutional policies and procedures, scheduling meetings, and making travel arrangements. Limited leadership may be exercised over small teams of co-workers or student employees.

Required Qualifications: Graduation from High School or educational equivalent, college coursework in Business Administration or related field, and two years of clerical experience.

Office Assistant II (School of Education and Behavioral Sciences): This is an advanced classification that performs complex clerical and reception work involving common office practices and procedures and requiring knowledge of standardized policies and procedures and confidentiality in the disposition of work matters. Work requires some independent judgment, problem solving, and minor decision making skills based on established policies and guidelines. Performs varied tasks such as maintaining and processing employee or student records and information and reception and clerical support for the office or department. Work includes producing reports and documents from rough draft or verbal instruction; transcribing and distributing meeting minutes; and coordinating appointments, meetings and travel arrangements. Limited leadership may be exercised over small teams of co-workers or student employees.

For a complete listing of job requirements and application procedures, visit our Website at www.wsc.edu/hr, call 402-375-7403 or email hr@wsc.edu. WSC is an EOE.

First in food

MICHAEL FOODS INC.

BENE
ADVA
GREA

Electrical Maintenance

\$2,000 BONUS

- Up to \$34/ hour (DOE)
- Set Schedule

Looking for an Electrician with mechanical skills to be able to maintain and troubleshoot logic and general industrial wiring.

APPLY TODAY!

WWW.MICHAELFOODS.COM

Are you looking for a company that provides you stability and support for long term career growth? Provides excellent benefits? Recognizes employee

SEEKING RO IN WAYNE

Ap
norfolkwaste

•• NEW STAR

Sign-on bonus \$7,500. L

CDL preferred. Will provi

Benefits include health, d

paid holidays



www.M

Que

WANTED

ASSISTANT
ENFORCEMENT
OFFICER

Strongly Preferred
& Retirement Available

Interested to email a cover
letter to:

KELLY
ATTORNEY
@WAKEFIELD.NE.ORG
(please call)

Looking for a new job?!

City Administrator

Resumes may be sent to wakenemayor@gmail.com for consideration.

City of Wakefield (Pop. 1,508) City of the second class is accepting applications for the position of City Administrator. The City Administrator reports to the Mayor and City Council and oversees all departments and phases of municipal government. Successful candidate must possess good written and verbal communication skills as well as good organization and people skills.

Minimum qualifications for the position include bachelor's degree in public administration or related field and a minimum of one year of experience in government or a related private field. These basic requirements may be waived in favor of comparable experience at the sole discretion of the Mayor and Council. This is a full-time exempt position with full benefits. Salary will be negotiated based on background and experience.



Seeking a Full-Time Carpenter

Currently hiring for our Norfolk construction crew.
Based out of Wayne, NE.

Benefits:

- Excellent Pay
- Paid Travel Time
- Health & Dental Insurance
- 401K
- Paid Holidays
- PTO

Contact: Chris Ruda
at 402-375-4770
chris@heritageind.com



HERITAGE HOMES
OF NEBRASKA, INC.



Come See for Yourself At:
Michael Foods
105 N Main Street
Wakefield, NE
402.287.5000
EOE: M/F/V/D

TECHNICAL DRIVER NORFOLK

WAGE! ●●
experience & Class B
license acquiring CDL.
insurance, 401K, uniforms,
and time off.

Apply online:
WasteConnections.com
Call: (402) 644-8300

NorthStar Services in Wayne

***NOW HIRING PART TIME DIRECT SUPPORT PROFESSIONALS**

Starting Wage — \$15.00 per hour

ALL SHIFTS AVAILABLE (mornings, evening, weekend, and overnight shifts available)

As an organization, we support persons with developmental disabilities to access and participate in their community, develop social networks and teach life skills, so people are successful in their homes, community and with employment opportunities

We are looking for dependable, self-motivated, organized persons with the ability to positively interact with persons with disabilities. All applicants must be 18 years of age, have a valid driver's license, the ability to lift 45 lbs., and be able to read, write and comprehend the English language.

Applicants should have good interpersonal skills and the ability to work with a wide variety of people.

All positions must be available to work some holidays.

Positions will be opened until filled.

Applicants are **REQUIRED** to attend job training, and pass background checks. All required training is paid for by NorthStar.

NorthStar does not hire temporary or seasonal help.

Interested parties can pick up an application and apply at:



NorthStar Services
209 South Main Street,
Wayne, NE 68787

Or apply on-line at: www.northstarservices.net



NOW HIRING!

WITH SIGN ON BONUS FOR FT & PT

- Outpatient Clinic/ Surgery Registered Nurse (full-time)
- Registered Nurse (full-time & part-time)
- Registered Nurse, OB preferred (PRN)
- Unit Secretary (part-time)
- Licensed Mental Health Therapist (full-time)
- Speech Therapist (PRN or part-time)
- Sleep Services Tech (PRN)
- Respiratory Therapist (PRN)
- Clinic RN/LPN/CMA (PRN)
- Patient Service Representative (PRN)



SCAN FOR MORE INFO!

View more openings online!
Apply today at pchne.org.

THIS INSTITUTION IS AN EEO/AA EMPLOYER AND PROVIDER, PROTECTED VETERANS AND INDIVIDUALS WITH DISABILITIES.

FOR SALE**NEW ACREAGE LISTING!**

56287 858th Rd - Carroll
\$245,000

3 bedrooms, 2 bathrooms, sits on almost 8 acres! (5± acres is pasture) antique barn, a couple outbuildings, and storm shelter. Very well maintained!
L-2400429

To discuss real estate opportunities, please contact your local FNC representatives:



Office: 402-256-9320

103 West 2nd Street
PO Box 368
Laurel, Nebraska

Connect with us!



Wendi Schutte
Broker

(402) 518-0115



Steve Schutte
AFM/Agent

(402) 518-0111

www.FarmersNational.com/Laurel

Real Estate Sales • Farm and Ranch Management
Energy Management • Appraisals • Insurance • Consultations
Forestry Management • Hunting Lease Network • FNC Ag Stock



KEL Physical Therapy & Wellness

JOIN US!

Hip & Knee Pain Workshop

Thursday, Sept 12th • Noon

Learn how to get rid of pain
NATURALLY

Contact **KEL-PT** to register
402-999-4564 KEL-PTwell.com

Private Treatment Rooms | Convenient Downtown Wayne Location



Karen Longe PT, DPT
Julie Vilkas, PT, MPT

SERVICES

SMALL ENGINE REPAIR. General repair. Welding. Stump grinding. ALSO: have a few several used riding and push mowers. Call 402-375-2471. tfn

Heithold Family Trucking LLC: Contact us for any trucking need. Hopper bottom, Grain, Side Dump, and Flatbed available. Contact Mike: 402-833-8087 or Jesse: 402-833-8186 for further information. tfn

SEEKING one night stand... Possibly two because i have two lamps

DOES YOUR basement or crawl space need some attention? Call Thrasher Foundation Repair! A permanent solution for waterproofing, failing foundations, sinking concrete and nasty crawl spaces. FREE Inspection & Same Day Estimate. \$250 off ANY project with code GET250. Call 1-855-605-1034. MB

CHOOSE EARTHLINK Fiber Internet for speeds up to 5 Gigs, no data caps, no throttling. Prices starting at \$54.95. Plus, a \$100 gift card when you make the switch. Call 1-866-670-2364. MB

HAIL, WIND OR STORM DAMAGE?

“WE’VE GOT YOU COVERED”

H&H ROOFING

ROOFING | SIDING | GUTTERS

(402) 992.8133

FAMILY OWNED & OPERATED

602 1/2 W. BENJAMIN AVE., NORFOLK, NE

LICENSED • BONDED • INSURED

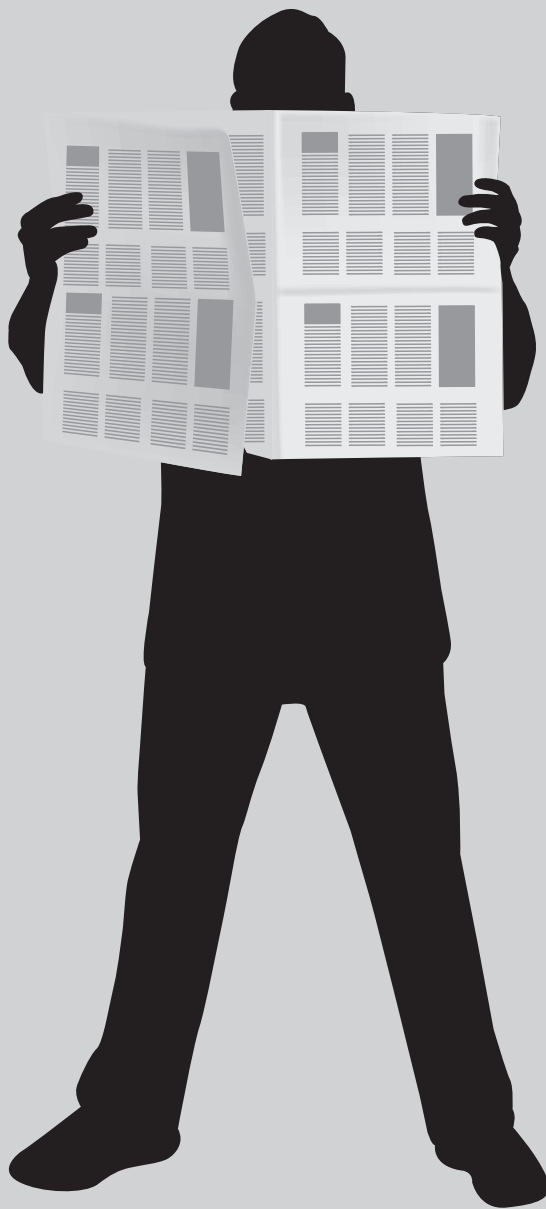

Apply today!

OFFICE HELP WANTED

Need Computer and Phone Skills

Send applications and resumes to 114 Main Street, Wayne, NE 68787

HELP WANTED

RETHWISCH FARMS Help Wanted for Seasonal Harvest. Full-time employment opportunity also. Call Jesse Rethwisch for more information. 402-369-0506. 10/10

HELP WANTED

Full-Time Pharmacy Cashier

Seeking energetic individual with courteous attitude to help deliver excellent customer service.

402-375-2922

WE ARE HIRING

JOIN OUR TEAM

- Dietary Aid
- PT day & evening shift
- Transportation

WWW.WAKEFIELDHCARECENTER.COM

**306 Ash Street
Wakefield, NE 68784
402-287-2244**

Harvest Help
Wanted
Truck driver or grain cart operator

Call
402-640-6248

Looking for
Part time Truck Driver. Primarily Grain. Modern Equipment.
Call
402.380.1540

Are you looking for a fun atmosphere to work in?

HELP WANTED

Part-Time Help Wanted (may lead to full-time)

Apply in person or call 402-529-3801 • Wendy Wemhoff

Two Blooms & A Bud LLC

922 Avenue E | Wisner, NE | 402.529.3801

Continuing a Legacy of Quality Care
VA Certified Nursing Home

If you are looking for a great paying job in a caring environment apply and be a part of our team!

NOW HIRING for the following position

Med Aide / CNA

Full/Part-time -- Days and Overnights
Shift Differential

RN/LPN

Full-time -- Overnight
Shift Differential - \$5,000 SIGN-ON BONUS

Apply by calling (402) 529-3286 or apply online at [Indeed.com](https://www.indeed.com)

Owned & operated by the City of Wisner
Wisner Care Center • 1105 9th St., Wisner, NE 68791

JANKE FARMS

STARTING IMMEDIATELY

Full-time or part-time help
Pay and benefits will depend on experience.

Full time trucking, planting, spraying, irrigation work, shop maintenance and harvesting.	Part time trucking or operating a tractor and grain cart.
---	---

Call or text: 402.369.2930
for more details and pay/benefits



20% off
next purchase

@hippiechickn 
Scan for our website!

402.833.1500
311 Main Street | Wayne, NE

M-W: 10am - 10pm | T-Sat: 10am - 11pm | Sun: 12pm - 9pm

Valid until 9.30.24
must have coupon

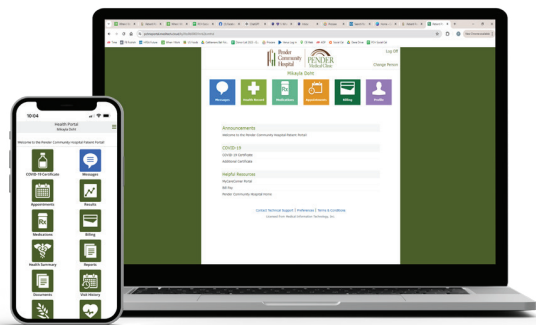

New Features Include:



Schedule and Cancel Appointments:
Stay on top of your primary care appointments.



Direct Chat Option:
Communicate directly with your primary care healthcare team.



Access to Health Records:
Quickly see lab results, medical imaging results, past immunization info, and more.



Pre-Register for Appointments:
Save time and speed up the check-in process by pre-registering for your visits.

SIGN UP FOR OUR PATIENT PORTAL TODAY!
pchne.org/portal

YOUR HEALTH, 24/7

Enhanced Patient Portal Features Now Available

Manage your health anytime, anywhere with the updated Pender Community Hospital & Medical Clinics Patient Portal. Through this platform, you can access essential health information and services around the clock, making your healthcare more convenient than ever.

Ask how you can enroll in our Patient Portal at your next appointment. If you'd like to enroll prior to your next appointment, please email portal@pchne.org to request your account activation.



WEST POINT LIVESTOCK AUCTION

"Eastern Nebraska's newest and most modern Livestock Market"

Monday, August 19 BBQ/Customer Appreciation Auction 10:30 AM
Thursday, August 22 Weekly

Market Report: Aug. 15, 2024:

Had a shorter run of fats for our Thursday August 15th auction but did gather good activity all the way through, sending those top fats out at 192.50. We followed another good run of weigh cows and bulls, finding the cows to be fully steady, the bulls took a step back. We finished the afternoon with a short run of feeders and some awful good sets of fall bred cows. We did find good activity on those bred sending them out from 3200 to 3400. We will be having our BBQ/Customer Appreciation auction on August 19th, with a hamburger cookout and an outstanding run of calves and yearlings. The auction will start at 10:30 A.M. If you are wanting to move some cattle, please give us a call and we would be happy to stop out and visit with you about our upcoming specials.

Weigh cows/ Finish Cattle	211 HD
Drug Free	No Test
Top Fats	192.50
Choice/Select	188-192
2-way Cattle	190-194
Hol/Jer/LH	No Test
Top Cows	138-155
Bulk	120-137
Low Yield	100-119
Bulls	150-179
Young	150-170
Feeding Cows	

Office: 402-372-2493 • www.WestPointLivestock.com
Brian Brester (Mg): 402-750-5821 Martey Stewart: 402-375-8913
Jim Schaben Jr.: 712-263-9449 Jon Schaben: 712-263-0755



FORT RANDALL CASINO AUGUST ENTERTAINMENT

8.2.2024 **REDFERRIN WITH LUCAS HOGE** OUTDOOR CONCERT

8.30.2024 **NEAL MCCOY** OUTDOOR CONCERT

8.8-10.2024 **MOJO GYPSY** OUTDOOR CONCERT

8.15.2024 **JOSEPH HALL** BANQUET HALL

8.16-17.2024 **MEAN STREAK** LUCKY'S LOUNGE

8.16-17.2024 **KING & QUEEN OF THE HILL** OUTDOORS

8.23-24.2024 **MARSHALL STAR** OUTDOOR CONCERT

8.31.2024 **RON KEEL BAND WITH CRASHING WAYWARD** OUTDOOR CONCERT

NEW! AUGUST 30TH 2024 **NEAL MCCOY** AUGUST 30TH 2024. \$45 AT DOOR. DOORS @ 5PM. SHOW @ 7PM.

REDFERRIN DOORS OPEN: 5PM. OPENING ACT: 7PM. TICKETS ON SALE NOW! EVENTS.FORTRANDALLCASINO.COM

LUCAS HOGE

BING & QUEEN OF THE HILL \$7,500 (in prize payments!) FOUR MEN'S OPEN DIVISION. ONE WOMEN'S OPEN WEIGHT DIVISION. PRIZES: \$1000.00. \$500.00. \$250.00. \$100.00. \$50.00. \$25.00. \$10.00. \$5.00.

VERY SPECIAL GUEST - LAS VEGAS' #1 ROCK BAND CRASHING WAYWARD



morning shopper

Tuesday, August 20, 2024

SECTION C

Help us celebrate Nancy Nettleton for her 80th birthday on **Saturday, Aug 24th** at the *Allen Fire Hall in Allen NE* from 4 pm - 7 pm



Larry Korth
Owner
109 Cherry St. Creston, NE 68631
402-910-9878
korthroofing@gmail.com
Serving Creston, Norfolk, Columbus and surrounding areas.

EXTERIOR IMPROVEMNETS
FREE INSURANCE INSPECTIONS
FREE ESTIMATES INSURED

KORTH ROOFING LLC

FREE UPGRADE to Class 4 Impact Resistant Shingles
10 Year Workmanship Warranty
Preferred by Insurance Companies

Out of Town Deliveries!

Pizza-Hut®

Call 402.375.2540

by 3pm for delivery between 5:00-6:00pm

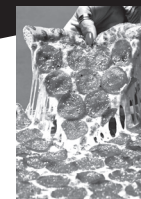

Mondays - Wakefield - Dollar General Parking Lot 5-5:30pm
Tuesdays - Laurel - Dollar General Parking Lot 5-5:30pm
Wednesdays - Pender - Pender Community Parking Lot 5:30-6pm
Thursdays - Winside - Coming soon!



Download our app and order online to receive FREE pizza!

901 E 7th Street | Wayne | 402-375-2540
Dine-In, Carry-Out or Delivery

SEWER CLEANING NOTICE

During the next several days, the City of Wayne Sewer Department will be having sewer mains cleaned in various parts of the City. While a considerable amount of cleaning will be done in the NW part of the City, there are a number of other small areas that will also be cleaned. This sewer cleaning project may include the sewer main that serves your property.

In this process, high pressure water is forced through the sewer pipe to clean it. This pushes solid materials to the manholes so they can be removed by vacuuming. This entire process is necessary to keep obstructions out of the sewer system and insure proper drainage of waste.

Residents should be aware that when this process is done, the high pressure water pushes the air in the sewer line which occasionally enters the private sewer lines into homes and businesses. If this happens, it can result in the air exiting through the toilet bowl, shooting the water out of the toilet bowl. This air should exit through the sewer vent of the building, but inadequate venting or location of toilets can cause the air to exit through the toilet. This is a rare occurrence and keeping the lid closed on the toilet during this time will keep most of the water in the bowl rather than the floor.

If you have any questions about the sewer cleaning process or the areas the sewer main cleaning will take place, you can call the Wastewater Treatment Plant at 375-5250. Thank you. City of Wayne Water/Wastewater Dept.





Providence Community Pharmacy

803 Providence Road Suite 101
Wayne, NE

Store Hours:

Monday-Friday
9:00am- 6:00pm

Saturdays
9:00am- 2:00pm

-  Convenient Drive-Thru
-  Curbside Deliveries
-  Friendly Faces



(402) 375-8862

www.providencecommunitypharmacy.com

Please join us for our

Ground Breaking Event

For Your NEW
Northeast Nebraska
Public Health
Department
801 Milo Drive
Wayne, NE 68787
Friday, August 23rd
11:30AM



The building site is located behind Magnuson Hopkins Eyecare.



PRICED AT
\$ 500,000

ACREAGE FOR SALE



About Property

Located just minutes from Wayne, this 4.79 acre property features a 1,298 sf open floor plan house with another 933 sf finished in the basement, plus a 1,673 sf barn with loft built in 2019 and a garden shed. Between both levels, there are three bedrooms and two bathrooms. Enjoy the open living/dining/kitchen, or get away in the basement family room. This home is move in ready!

Property Features

- 3 Bedroom
- Open Kitchen
- Living Room
- 2 Bathroom
- 2-Car Attached
- 24/7 Security

CONTACT TODAY 402-375-2134

www.propertyexchangepartners.com

All Day Special
Small 1-topping Pizza, Side Salad,
20 oz drink - *Only \$12*



Pizza Hut®
901 E 7th Street | Wayne | 402-375-2540
Dine-In, Carry-Out or Delivery



GERKIN™
WINDOWS & DOORS

**NEW CONSTRUCTION
CUSTOM REPLACEMENT**

402-375-5386
Mon-Thur 7:30-5:30
Friday 7:30-5
Saturday 8-1

BUILDERS RESOURCE
2 miles west of Wayne on Hwy 35

Come in We're OPEN

MISCELLANEOUS

MAKE MONEY from stuff you don't want any more! Did you just read this ad? Then so did hundreds of other people! Snap ads are cheap and effective, call the Wayne Herald--Morning Shopper today @ 402-375-2600 and start making money from your old stuff today!

▼▼▼
It's SIMPLE! It Gets RESULTS!
It's VERY COST EFFECTIVE!
Place your snap ad in over 175 Nebraska newspapers for only \$235.00
Call the Wayne Herald today for the details! 402-375-2600.

▲▲▲
☆☆☆☆☆
\$24 for two weeks worth of ads in the Shopper, Herald!
Call for details 402-375-2600
☆☆☆☆☆

ALL REAL estate advertised herein is subject to the Federal Fair housing Act which makes it illegal to advertise "any preference, limitation, or discrimination because of race, color, religion, sex, handicap, familial status or national origin, or intention to make any such preference, limitation, or discrimination." State law also forbids discrimination based on these factors. We will not knowingly accept any advertising for real estate which is in violation of the law. All person are hereby informed that all dwellings advertised are available on an equal opportunity basis.



Life is full of uncertainty, but the value of a handshake at Blu Roofing is a constant.



BLU
ROOFING
BETTER than good.

Serving Northeast Nebraska

JESSE BRODERSEN, owner | c: 402.741.9344 | e: jesse@blu-roofing.com
www.blu-roofing.com



HELP WANTED

RETHWISCH FARMS Help Wanted for Seasonal Harvest. Full-time employment opportunity also. Call Jesse Rethwisch for more information. 402-369-0506. 10/10

SERVICES

DOES YOUR basement or crawl space need some attention? Call Thrasher Foundation Repair! A permanent solution for waterproofing, failing foundations, sinking concrete and nasty crawl spaces. FREE Inspection & Same Day Estimate. \$250 off ANY project with code GET250. Call 1-855-605-1034. MB

CHOOSE EARTHLINK Fiber Internet for speeds up to 5 Gigs, no data caps, no throttling. Prices starting at \$54.95. Plus, a \$100 gift card when you make the switch. Call 1-866-670-2364. MB

READERS BEWARE! Job opportunities being offered that require cash investment should be investigated before sending money. Contact the Better Business Bureau to learn if the company advertised is on file for any wrong doing. The Wayne Herald/Morning Shopper attempts to protect readers from false offerings, but we are unable to screen all copy submitted.

Free Estimates
THE GUTTER CREW
 Seamless Gutters & Downspouts
 28 Years of Experience
 Art Sehi 402-776-2563
 PO Box 27 Oakdale, NE 68761
 402-776-2600 • 1-800-867-7492

FOR SALE

GIFT GIVING and baking are easy with Tupperware. Contact Clara Osten, your local consultant for over 30 years. 402-518-8030 or 585-4323. Leave a message. tfn

FOR RENT: 2, 3 and 4 bedrooms apartments. Close to campus. All appliances. High efficiency. Central air & heat. No Pets or Parties. Call 712-899-0505. tfn

1 BEDROOM house for rent immediately. Pet Friendly. Fridge and Stove included. Ph 712-212-5844 tfn

MR. GOLF CAR, INC.



Large selection New & Used E-Z-GO Golf Cars & Specialty Vehicles
 • Gas or Electric
 • Various Colors
 • Trade-ins Welcome

Financing available
Call or stop in today!



Closed Saturdays

Your complete golf car center!

822 8th St. • Springfield, SD • 605-369-2625 • www.mrgolfcar.net

Weldon & Lois Marotz Estate Sale

605 Kingwood, Stanton, NE

Wednesday, August 21 12 noon - 8 p.m.
Thursday, August 22 8 a.m. - 8 p.m.
Friday, August 23 8 a.m. - 5 p.m.

Maytag washer/dryer, jewelry, crocks, furniture, 2 newer small freezers, table sets, antiques, toys, glassware: antique, molded, clear, etched, crystal, carnival; baskets, figurines, household, black iron patio sets, lamps, linens, and more.

CASH, LOCAL CHECKS ONLY

Mike and Diann Marotz @ 402-750-2811
Arddie and Debbie Marotz @ 402-750-7850

FOR RENT

FOR RENT: Nice 1, 2, 3, and 4 bedroom apartments. All new heat pumps and central air. No parties. Call 402-369-0771. tfn

FOR RENT or Lease at midcity plaza 202 W 2nd street and pearl in Wayne. Large office area or other uses. Contact Dawn at 402-518-0658. tfn

SERVICES

SMALL ENGINE REPAIR. General repair. Welding. Stump grinding. ALSO: have a few several used riding and push mowers. Call 402-375-2471. tfn

Heithold Family Trucking LLC: Contact us for any trucking need. Hopper bottom, Grain, Side Dump, and Flatbed available. Contact Mike: 402-833-8087 or Jesse: 402-833-8186 for further information. tfn

Edward Jones

> edwardjones.com | Member SIPC

Start your next chapter in life with a solid savings plan

Bank-issued,
 FDIC-insured
 3-months APY*

4.90%

CDs may seem uninteresting, but that's their superpower. As an investment vehicle, they offer competitive rates while generally being predictable and dependable. Call us to learn more about our boring CDs with not-so-boring rates.

*Annual Percentage Yield (APY) effective 08/14/24. CDs offered by Edward Jones are bank-issued and FDIC-insured up to \$250,000 (principal and interest accrued but not yet paid) per depositor, per insured depository institution, for each account ownership category. Please visit www.fdic.gov or contact your financial advisor for additional information. Subject to availability and price change. CD values are subject to interest rate risk such that when interest rates rise, the prices of CDs can decrease. If CDs are sold prior to maturity, the investor can lose principal value. FDIC insurance does not cover losses in market value. Early withdrawal may not be permitted. Yields quoted are net of all commissions. CDs require the distribution of interest and do not allow interest to compound. CDs offered through Edward Jones are issued by banks and thrifts nationwide. All CDs sold by Edward Jones are registered with the Depository Trust Corp. (DTC).

Please contact us if you have \$1,000 or more to invest.



Mike Varley
 Financial Advisor
 300 Main Street
 Wayne, NE 68787
 402-375-4172

FDI-19160-A AECSPAD 22917744



Have you been in to see us recently??



We would love to see you!

1106 S. Main St. • Emerson
 402.695.0180
 www.winnebagocasinos.com

The Iron Horse Casino is owned and operated by the Winnebago Tribe of Nebraska. The Iron Horse Casino reserves the right to substitute or change promotion without notice. Must be present to win. Must be legal age. See Casino for details.

FOR SALE BY OWNER



BEAUTIFULLY UPDATED HOME SITTING ON 2 LOTS OVERLOOKING THE WAYNE COUNTRY CLUB

414 E 21st St – Wayne, NE

Total Sq ft: 3708

Asking Price - \$775,000

Call or Text 402-369-0650 to schedule a showing

NOTICE OF SALE OF CITY-OWNED PROPERTY

The City of Wayne will be accepting sealed offers for the purchase of LOT 19, Southview II Addition, City of Wayne, Wayne County, Nebraska, or better known as 400 Chicago Street. The lot is 13,504 sq ft and zoned R2. The successful bidder must agree that a residential structure will be completed within 24 months from property closing. Closing will likely be in mid-fall 2024. Offers will be received until 2:00 p.m. on Friday, August 30, 2024. Offers may be mailed to the City of Wayne, Attn: Betty McGuire, City Clerk, PO Box 8, Wayne NE 68787; emailed to betty@cityofwayne.org; or, submitted in person at the city offices located at 306 Pearl Street. The City of Wayne reserves the right to reject any and all offers and to waive informalities in the offers submitted and to accept whichever offer is in the best interest of the City, at its sole discretion. Please contact the City Offices at 402-375-1733 for property limitations, zoning requirements, etc.

RETIREMENT Farm Equipment AUCTION

Starts at 10 AM

Monday, August 26, 2024

TINKER
CONCESSIONS

LOCATED: AT THE FARM SITE LOCATED AT THE INTERSECTION OF 577 & 860 ROAD – WAYNE, NEBRASKA

Directions: From 7th & Main Street – Wayne, NE – Go 4 Miles North on Hwy 15 to 860 Rd - Then 1 Mile East On 577 Ave – to Auction Site

Auctioneers Note: Please make your plans to join us northeast of Wayne, Nebraska on Monday, August 26th for this outstanding Retirement Auction for Larry G. & Cathy Echtenkamp. The Echtenkamp's have taken great pride in their Farm Equipment; the condition of these auction items is extremely nice. We will begin the Auction @ 10:00am selling Shop Tools & Miscellaneous. At approx. 11:00 am we will move to the major items. At that time, we will simulcast the Auction Live and Online on both bid platforms; **CREAMERBID** -and- **EQUIPMENT FACTS**. For more information & link to catalog, please visit our web site www.CREAMERAUCTIONS.COM Please be on time as this Auction will conclude Very Early!

TRACTORS

MX 245 Case IH Magnum Tractor, SN # MX245Z9RZ03753, 1,501 Hours, Auto Steer Equipped, Pro 700 Monitor, 372 Globe, Inside Rear Wheel Weights, Heavy Draw Bar, 480/80R46 Axle Mount Duals, New 380/85R34 Front Tires, New Batteries, (10) Front Weights, Quick Hitch, 4 Hyd. (2) Extra Power Shafts. - This tractor was purchased with approx. 300 hours. This tractor is extremely nice and ready to go.

Case IH 7220 Tractor SN # AJB0076642, (1995), 18.4R-42 Rear Tires w/ Axle Mount Duals, 14.9R28 Front Tires, 2,844 Hours, (18) Front Weights, 540/1000 RPM PTO Shafts, Sells with Hammer Hitch. This tractor was purchased new by Larry.

International 856 Tractor - SN # 9112 18.4-38 Rear Tires, 11L-15 SL Front Tires 2 Pt/3 pt - 2 Hyd. (Side panel Numbers are not correct on this tractor - It is an 856)

International Farmall Super C Tractor w/Woods 59" Belly Mower - SN # 107924, w/ Good 11.2-36 Rear Tires - New Battery

International Farmall H Tractor SN # 164933, Near New 12.4-38 Titan Rear Tires - & New Battery

International 460 Tractor - Selling for Parts or Salvage - Motor is loose, Swartz Wide Front - No Tin work
Set of 18.4-38 Axle Mount Duals & Hubs Excellent Condition

18.4-38 Tractor Chains
Assortment of Tractor Weights:
(4) IHC Embossed Front Weights,
(6) IHC Rear Wheel Weights,
(2) Sets of IHC 1/2 Moon Wheel Weights, Front Weight Bracket,
(2) Magnum Front Weights
IHC Side Frame Mount Step Tool Box

TRAILERS

2009 H & H Bumper Hitch Utility Trailer 5 Ft x 10 Ft. w/ Drop Down Tail Gate Ramp
Home Built Bumper Hitch Utility Trailer 5 Ft. x 8 Ft.

1991 Keifer 6 Ft. x 20 Ft. Gooseneck Livestock Trailer - VIN # 1DVEP2025MK021613

COMBINE & HEADS

Case IH 6130 AFS - Axial-Flow Combine, SN # YCG007496 (2011) Model. 1,323 Engine Hours, 843 Separator Hours, Folding Grain Tank, Electric Grain Tank Shut Off, Trough Liners in Grain Tank, Combine has new batteries, & Def - Equipped with (3) Cameras at Grain Tank, End of Unload Auger & Rear Platform. 480/80R42 Front Tires w/ Duals - 540-65R30 Rear Tires - Combine is exceptionally clean and is field ready.

Case IH 4408 Corn Head SN # YEH631492 (2015) - 8 Row Narrow Corn Head
Case IH 3020-30 - 30 Ft. Terra Flex Platform Head SN # YBZL59219 (2012)
(2) HT 30 Ft Head Carriers
Short Fingered Bottom Sieve for a 6130 Combine, used for approx. 300 hours
MIS Deflector for Combine Head

MISCELLANEOUS

55 Gallon Endura-Blue Self-Contained Def Tank w/Hose & Stainless-Steel Pump
(2) 500 Gallon Diesel Fuel Tanks w/ Elec. Pumps
Broyhill Saddle Tanks w/Mounting Brackets for Magnum Tractor w/Hyd. Driven Pump
Acetylene Torch on Cart (Smaller Sized Tanks)
Sliding Spout for Elm Creek Bean Caddy Ass't. of Steel & Wood Post & Well Pipe
Hog & Cattle Panels 12 Ft. & 15 Ft. Sweep Augers
Acre Counting Wheel
Planter Graphite & Misc. Kinze Planter Parts
25 Ft. Booster Cables - New
(4) 2" x 17 Ft. Tie Downs
John Deere Grain Moisture Testers
Campbell Hausfeld - Portable Air Compressor w/Gas Engine
300 Gallon Gasoline Tank on Stand
True Force Box End Wrenches, Set of Standard Wrenches, Titan 16 Piece Metric Wrench Set, 3/4 Drive Socket Set, New DeWalt 3/8 Impact Wrench, DeWalt Battery Operated 20 Volt Impact Wrench, Craftsman 12 Pc. Impact Set, 50 Ft. Air Hose Truck Connections, Standing Halogen 2 Lamp Work Light,
(2) John Deere Jacks, Portable Air Tanks, Car Ramps, (2) Hydraulic Jacks, Screw Jacks, Come-along, Truck Flairs, Ass't. of Misc. Hand Tools & Other Misc. Items

FARM EQUIPMENT

Kinze 3600 - 1631 Planter - SN # 62335 - This planter was purchased new by Larry. Planter has planted 7,004 Acres - Has had some reconditioning - Corn & Bean Units, Monitors - Always stored inside & was purchased new. Additional 16 Boxes will be sold separately.

Brent 882 Grain Cart - SN # B27-940-102. With Scale & Roll Over Tarp, 30.5L-32 Tires - Stored Inside
Brent 776 Grain Cart w/ Scale & Tarp SN # B18 200 107 - 30.5L-32 Tires
Case IH 3950 Disk - 28 Ft. - 3 Bar Tined Harrow - Blades measuring approx. 21" - SN # JFH0014014
Case IH 4800 Field Cultivator 27 Ft. Pull Type Field Cultivator w/ 3 Bar Tined Harrow

Peck 10" x 76 Ft. Direct Drive Auger w/ Hyd. Lift, Hyd. Swing Hopper - Model 1004-76 - SN # 217-1857
Peck 8" x 66 Ft. Direct Drive Auger w/ Hyd. Lift & Manual Swing Hopper SN # 307-13298

Westendorf WL 42 Loader w/ 8 Ft. Bucket & IHC Mounts
Front Mount Bale Spear for Westendorf WL 42 Loader
Westendorf Loader Mount Pallet Fork - Like New

Farmhand F-11 Loader w/8 Ft. Bucket & IHC Mtgs
Stan hoist Steel Barge Box w/8 Ton Westendorf Gear & Hoist & Floatation Tires
(2) **Westendorf 8 Ton Running Gear** w/ M10 Hoist w/ 9.5L-15 Tires
Owatonna 205 Elevator - Approx 45 Ft. in Length
Automatic Equipment Model ATA 900 x 4 Roller Mill on Cart - Has not been used for several years.
7 Ft. Road Drag

TRUCK & GRAIN TRAILER

International Model 9200 6 x 4 Semi Tractor VIN # 2HSFMMR1TC056434 This truck was overhauled in 2014 & has approx. 27,000 Miles on Overhaul. Original Odometer is not accurate. 285-75R24.5 Front Driver Tires, & 11R24.5 Rear Tires - Detroit Series 60 Engine - Truck has been DOT inspected, all filters have been changed. Clean Truck & Ready to Go
2008 Wilson DWH-500 Grain Trailer VIN# 1W1MAF1A28A249808, Electric Tarp w/Remote, w/11R-24.5 Good Tires



FOR RENT

FOR RENT: 2, 3 and 4 bedrooms apartments. Close to campus. All appliances. High efficiency. Central air & heat. No Pets or Parties. Call 712-899-0505. tfn

1 BEDROOM house for rent immediately. Pet Friendly. Fridge and Stove included. Ph 712-212-5844 tfn

FOR RENT: Very nice 1 and 2 bedroom apartments for rent in Laurel and Wayne. Call Dawn at (402)518-0658. tfn

FOR RENT OR LEASE at Midcity Plaza 202 W 2nd Street and Pearl in Wayne. Large office area or other uses. Contact Dawn at 402-518-0658. tfn

FOR RENT: 4 bedroom house, 2 bath, 1 block from campus, no pets, no parties, no smoking. 402-375-3657. tfn

SEEKING one night stand... Possibly two because i have two lamps

GRAIN VAC for rent. Call Chuck Rutenbeck, Wayne at (cell) 402-375-7864.

WAYNE VETS CLUB BREAKFAST

Sunday, Aug 25

9:00 a.m. - 12:30 p.m.

Serving Pancakes, Eggs, Sausage or Biscuits & Gravy, Adults \$10

Children under 12 \$5

Dine-In or Curbside Pickup

Call 402-375-9944



Wayne Vets Club
220 Main
Wayne, NE

Leisure Apartments

825 & 829 E 6th St, Wayne

Move-In Special: 1st Month Free!

1- & 2-Bedroom Apartments For Rent
A Building: Elderly (62+)/Disabled, Regardless of Age

B Building: Open to All Ages

Income-Based Rent
Rental Assistance Available
Water, Sewer, & Trash Included

Van Binsbergen & Associates

320-269-6640 Ext. #221

housing@vanblc.com

www.vanblc.com



"This institution is an Equal Opportunity Provider"



I want to thank the thoughtful magician(s) who turned Duane's cargo/motorcycle trailer on the driveway into a "self-dumping" trailer. My kids needed to borrow it, but it contained immense amounts of yard waste. I said sure, but it would need dumping first. When we went out to hook it up to their truck last Saturday, the trailer was magically empty. I was so touched once again by all of the caring actions of many, many people over the last months. Duane thought so much of you all. You're truly dear to us. So, THANK YOU again to everyone and including the magician(s) this time.

- Betty Schroeder

LARRY G. & CATHY ECHTENKAMP – OWNERS

For more information, please call Larry G. Echtenkamp 402.375.8430

TERMS: Cash — or bankable check day of sale with no property to be removed until settled for. Everything sold - as is, where is, and becomes the responsibility of the successful bidder. Proper ID will be required for a bidding number.

NOT RESPONSIBLE FOR ACCIDENTS OR THEFT.

CREAMER AUCTION CO. LLC

AUCTION CONDUCTED BY:

CREAMER AUCTION CO. LLC

RYAN CREAMER 402.254.9753

AUSTIN CREAMER 402.316.6841

ISAAC CREAMER 402.316.6460

ALTON HEIMES 402.254.3315

