

**FREE**

NEW EDITION EVERY FRIDAY!  
VOL. 29 • NO. 83 • AUGUST 26, 2022

# NEMO *Trader*

**THE NEMO TRADER**  
PO BOX 809 • KIRKSVILLE, MO 63501 • PHONE 660-665-8500  
Web Site: [nemotrader.net](http://nemotrader.net) • Email: [sales@nemotrader.net](mailto:sales@nemotrader.net)

A WEEKLY ADVERTISER SERVING ALL OF NORTHEAST MISSOURI AND THE SURROUNDING AREA

**OVER 80 FANS**  
**OVER 30 HEATERS**

<b>FANS</b>		
• 12" 1 hp	\$642	
• 18" 3 hp	\$1364	
• 24" 5-7 hp	\$2082	
• 24" 7-10 hp	\$2363	
• 26" 10-15 hp	\$2961	
• 28" 10-15 hp	\$2994	
• 10 hp Centrifugal	\$3457	
• 10 hp Centrifugal 3-Phase	\$3234	
• 15 hp Centrifugal 3-Phase	\$3662	
• Used 24" fan and transition	\$950	
<b>TRANSITIONS</b>		
• 24", 28", and Centrifugal		\$737
<b>STIRRING MACHINE</b>		
• 36" Fastir w/3 Down Augers		\$8905
<b>DOWN AUGERS</b>		
• 17-4"	\$254	
• 20"	\$287	
• 24"	\$386	
<b>HEATERS</b>		
• 24" Liquid-Thermostat	\$2383	
• 24" Liquid-Mod Valve	\$3021	
• 26" Liquid-Thermostat	\$2428	
• 28" Liquid-Thermostat	\$2472	
• 28" Liquid-Mod Valve	\$3120	
• 28" Super-Low-Temp	\$1928	
• Centrifugal Liquid-Thermostat	\$2630	
• Centrifugal Super-Low-Temp	\$1976	
<b>GRAIN SPREADERS</b>		
• Gravity Grain Spreader		\$972
• Used Spread-All Spreader		\$450

**NUMEROUS SUMP, FLIGHTS, POWER HEADS, AND ELECTRIC MOTORS ON HAND!!**

**GRAINBIN SUPPLY**  
"The Grain Bin People"  
CAIRO, MO (660) 263-6700  
VANDALIA, MO (573) 594-2167

**"FROM THE FARM" is a Full Service locker offering inspected and custom processing of livestock.**  
*Locally grown Locally owned!*  
Dr. David Zimmerman Family

**From the Farm LLC**  
545 W. Hwy 6 • Trenton, MO 64683  
**660-358-1509**

**WE SELL AND INSTALL GARAGE DOORS**  
**LUMBER**  
**FULL WARRANTY**  
RESIDENTIAL & COMMERCIAL • 641-898-2227

**FARM & RANCH**  
ELIZABETH GREGORY  
660.621.2136  
[missourihomeandfarm.com](http://missourihomeandfarm.com)

**CENTURY21** Lifetime Realty  
1605 Baltimore, Suite A  
Kirksville  
660.665.5678

**Rooferman LLC.**  
302 Third Str. Moberly, MO 65270  
660-833-9162  
owner: Wade Sandersson

**CALL TODAY!**  
Free Estimates

**CALL TODAY TO RESERVE YOUR SPOT**

# NEMO *Trader*

*The Meeting Place For Buyers And Sellers!*

*Call Cindy!*

**660-988-6830**

chigh@nemotrader.net  
701 East Laharp Ste. C • Kirksville, Mo 63501



**WE CAN ALSO PRINT YOUR INSERTS!**

CALL OR EMAIL FOR YOUR CUSTOM QUOTE!

**Insert Rates (11,000 pcs):**

8.5" x 11" single sheet	\$385
4-12 page tabloid	\$572

**We are a free publication serving a 20 county coverage area in Missouri, Iowa, and Illinois.**

We distribute 11,000 copies each week to convenience stores, restaurants, and other businesses for readers to pick up.

**NEW ISSUE EACH FRIDAY, ALSO AVAILABLE ONLINE AT NEMOTRADER.NET.**



**FOR SALE**  
**AI Sired Angus Bulls,**  
**14 & 18 Months Old.**  
**Harold Trump**  
**660-341-5730**

**Cattle**  
 For Sale: 12 head of p3 Angus cattle that are older but in great condition. They will start calving in October. Call 660-265-6772 for more information

**Equipment & Supplies**

2-14.9 R28 John Deere tractor wheels and tires. Cylinder bars for JD 7722 combine. 540 PTO shaft for 566 JD baler. 1-18.4 R26 tire. 660-216-5535.

Allis Chalmers D14, narrow front, very straight, original, non running from setting, \$1250. 217-257-1385

White Rollex aluminum soffit panels, new. Other aluminum parts, Call only 217-257-4276, Quincy

**BWS**  
**Brad's Welding Shop**  
 12673 Almond Ave.  
 Marceline, MO 64658  
**660-376-1158**

- Hay Liner Trailers
- Red line Harrows
- Continuous Panels
- Bale Feeders
- Arrowquip Cattle Equipment



[bradsweldingshop.com](http://bradsweldingshop.com)

**Equipment & Supplies**

16 foot Knapheid bed and hoist, rebuilt, in like new condition, new floor, new paint, good hoist, \$1500.00. 660-699-3741.

Call about our classified ad specials. 660-665-8500.

**Equipment & Supplies**

John Deere material cart/power flow complete unit that fits X500, x520, X534 and X540 Tractors. Asking \$300.00. Call 217-257-4276

[NEMOTRADER.NET](http://NEMOTRADER.NET)

**BUCKMAN MACHINERY, LLC**  
**573-881-3557**

John Deere 3020 D, 1968, powershift, 9000 hrs, very straight, 90% rubber, ..... \$12,500

John Deere 4430, QR, 65% rubber, 6500 hrs showing, dual hydr, 6 out of 10. .... \$14,950

John Deere 709 or 609 Brush Hogs, 3 pt, 540 PTO, Cat II, choice, ..... \$1,750

John Deere 3950 Silage Chopper, used this year, very good condition, a green 2 row 30" corn head, low acres, 5.5'pick-up header, ..... \$5,500

John Deere 1008 Brush Hog, 3 pt, 10', 540 PTO, good..... \$4,750

John Deere 3020 Gas, powershift, 90% big rubber, dual hydr, 4100 hrs, one owner, really nice, loader available ..... \$9,500

IHC 484 Utility Diesel, 90% rubber, 4400 hrs and Freeman Loader ..... \$6,250

John Deere 5075 E, MFWD, CAH, with JD H240 SL Loader, 940 hrs, same as new, ..... \$39,500

**Loaders & Duals available for many**

1968 C50 Grain Truck-Master Cylinder out, clutch stuck, good 16" Knapheid hydraulic bed, \$1,000 OBO; International 430 square baler, 540 PTO, always shedded, works very good, \$1,800 OBO; International 37 square baler for parts, \$500 OBO; 1980 555 Ford w/loader and backhoe, good working condition with new battery and some other parts, good hydraulics, good tires, new teeth on bucket and Volumes I and II Mechanical book, \$800 OBO; 1980 JD 535 RB 1000 PTO with monitor, string/net with kicker 1000 PTO \$4500 OBO; 2004 JD 702/10 wheel V-Rake new tires \$1800 OBO; 1975 JD 4430 Quad Range with cab/1 new front tire other tire 75%, 1 new rear tire, other tire 75%, dual PTO 540/1000, new seat and battery, \$12,000 OBO; TA26 Westendorf loader w/quick change bucket, like new, \$4,000 OBO; JD Joystick Kit Fits 4630-4430, \$1800 OBO; 1980's JD 1209 Mower/Conditioner 1000 PTO, \$1,000 OBO.  
**660-216-6088**

**Equipment & Supplies**

Farmall 656, gas, factory wide front, flat tops, good TA, fast hitch, 16.9x38, very straight and original, 4900 hours, with hydraulic bucket loader, \$6900. 217-257-1385

JD 66 silage blower, 82 model, has shaker, 7ft extension pipe, 540 PTO, \$1,000.00. 641-777-9775

**Equipment & Supplies**

10' AC grain drill outboard wheels, Williamstown, MO. \$2750.00. Text and i will call 217-653-7100. Planted wheat food plots.

Kewanee 14' disc, cylinder, used last fall, \$700.00, AC 3 bottom snap coupler plow, \$200.00, Kewanee 8' snap coupler blade, \$350.00. 217-257-1385.

**Buckman Machinery**



MF 235 Diesel, 3000 hrs, restored, new rubber, hydr valve, sharp looking, \$5,750



Woods 3180 Batwing, 15', 1000 PTO, laminated tires, chains, field ready \$12,500



Ground Driven NI/ JD Manure Spreaders, refurbished, \$1,750 choice



John Deere 7230 power quad, reverser, JD 741 Loader, 7400 hrs, above average condition, \$69,500



John Deere 4020, 1966, powershift, 85% rubber, with JD 158 Loader, QT bucket & bale spear, one owner, 9017 hrs, \$18,500



John Deere 5603, 2008, MFWD & 542 Loader, reverser, dual hydr, joystick, 2035 hrs. \$49,500



Bush Hog 12715 Legend, bat wings, 1000 PTO, 4 yrs old, in the field now, \$13,500

**573-881-3557**

**Equipment & Supplies**

New Holland 475 manure spreader, 540 pto, outstanding floor that is original. ready to use, metal sides. \$3200. 217-257-1385.

Agco 12 wheel high capacity rake for sale. Good condition. Can be seen at Sydenstricker-Nobbe in Macon, Missouri. Ask for Darrell. \$6,900.00. 660-676-0710.

Case 1840 skidloader, 4926 hours, 63: bucket, 54 hp auxiliary connectors, diesel. 785-893-2706.

AGCO RT95, MFWD, 5,700 hours with a TA29 Westendorf loader (self leveling) and bale spear. Call Bill 660-412-2858.

Brand new 2022 Carry-on, 76" wide x 12' treated lumber utility trailer, 3,500 pound axle, 2990 pound GVWR, 49" rear ramp gate, 15" tires on white mod wheels and lockable storage box, \$2300.00. Accelerators since "1974", Kahoka, MO. 217-257-1385.

**WE GOT YOUR NEEDS COVERED!**



**FARM TARPS TRUCK TARPS HOOP BUILDING COVERS**

**Troyer TARP MFG.**  
**660-486-3301**  
 20264 STATE HWY. VV • ETHEL, MO 63539

**Animal Housing, Hay Storage & Much More!!**

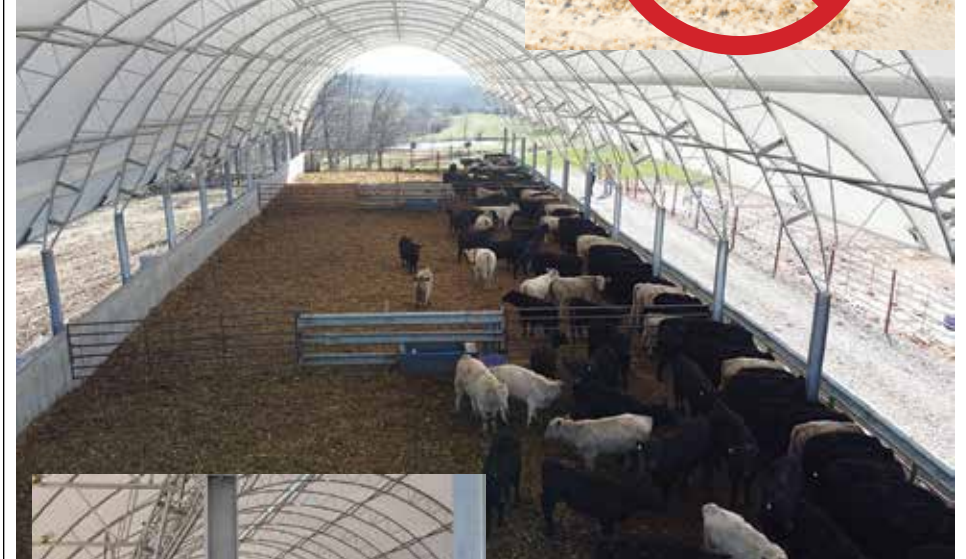

**Skylight Fabric Structures**  
 20749 State Highway VV  
 Ethel, MO 63539  
 660-486-3250  
 833-482-8862

*Your Local*  
**FARM SUPPLY SOURCE**  
 NUTRITION • MEDICAL • FARM • PET • APPAREL

*Featured Product*



**10' BUNK FEEDERS**  
**\$15 OFF**  
 THIS MONTH

Hometown Animal Health has provided quality products, expert knowledge, and friendly customer service to northeast Missouri and surrounding areas. We are a full-service nutrition, medical, and farm supply source carrying complete lines of animal feed and supplies, farming equipment, agricultural parts, lawn and garden tools, work apparel, and much more!"

*Hometown*  
 ANIMAL HEALTH

Feed • Medical • Farm & Pet Supplies • Footwear & More

website: [hometownanimalhealth.com](http://hometownanimalhealth.com)  
**660-465-2967**

18743 US Hwy, 136 Memphis, MO 63555  
 "on Hwy 136 west of Memphis"

Monday-Friday 8pm to 5pm  
 Saturday 8am to 1pm



## Golden Grain Bins-Spring Discount

Grain Bins	Floors w/12" Supp. & Flashing	
18'x18' 4,195bu. \$ 7,398	18'....\$2,065	30'....\$ 5,764
27'x21' 11,265bu. \$14,850	21'....\$2,824	36'....\$ 8,211
42'x24' 32,245bu. \$34,617	27'....\$4,710	42'....\$11,182



**GMLS Industries, Inc.**  
 PH: 660-699-2179 or 620-983-2136  
 www.gmlsindustries.com

### Equipment & Supplies

Vermeer R23 twin V rake, hydraulic drive, manual fold, adj. raking width 18'x23', ready to use \$4500. 217-257-1385

**NEMO ADS SELL!** Call for more information and specials. 660-665-8500.

### Equipment & Supplies

WANTED TO BUY: Farm Machinery and Estates. Call James L. Johnston. 573-473-4904

250 Gallon water tank, fits pickup bed, sets over wheel wells, with shut off valve. \$200. 217-257-1385

### Livestock

**Edina Livestock Sales**  
Edina, Missouri

**Friday, August 26th**  
Special Feeder Calf Sale

**Friday, September 2nd**  
No Sale - Labor Day

To Consign For Any or All Sales or For Information Call:  
 Owner - Kevin Strange • Cell: 660-341-9974  
 Ryan Strange • Cell: 660-341-9721  
 Sale Barn: 660-397-9999

**Field Reps:**  
 Bill Tom Hall 660-342-5420 Mike Bronestine 660-341-9965  
 Jason Bichsel 660-216-0373 John Powell 660-341-1717

### Sales

# JOIN OUR TEAM

## Several Positions Available

**CANTRIL**  
TRUCK & TRAILER  
319-238-7367  
101 North St. • Cantril, IA

**CONTACT CANTRIL TRUCK & TRAILER**  
**or PAUL at 641-680-9035**

### Arts & Crafts

**GET FREE GIFTS WITH PURCHASE OF BERNINA 570 QE!**

**Made especially for quilters**

- Enjoy superb fabric feed
- Handle big quilts with ease
- Your threads are cut automatically
- Precise and perfect stitches
- Patchwork foot #97 included

**FREE GIFTS WITH PURCHASE**  
Value up to \$1352.95

**Green Acres Sew & Vac**

221 W Grand Ave. Memphis, MO 660-465-7131  
 greenacressewvac.com

Valid through August 31, 2022. See store for full details.

### Industry

**CONAGRA BRANDS**

Conagra Brands in Macon is now hiring for all shifts, both full-time and part-time positions in Production, Sanitation and Maintenance.

**WEEKLY ATTENDANCE & EMPLOYEE REFERRAL BONUS**

Join the Conagra Brands team in Macon with competitive hourly starting pay of \$18.37 per hour, and an excellent benefit package that includes medical, dental, vision and life insurance.

Salary positions in Sanitation and Maintenance are also available.

Open interviews are conducted each Wednesday in the plant between 9 AM and 11 AM, and other times by appointment.

Apply online at [jobs.conagra.com/careers](http://jobs.conagra.com/careers) and follow the links to submit your application OR text Conagra to 25000.

Let us help you with all your advertising needs. Don't know what to say? Call us we can help! 660-665-8500.

**HAVE A PET OR PUPPIES TO SELL?** Call us. You can even pay over the phone. 660-665-8500.

### Services

**fb farmbank**  
Growing Together

Green City 660-951-8430 Milan 660-951-8432 Kirksville 660-951-8431  
 www.farmbank.com

### AGRI-BUSINESS

#### Hay/Feed/Seed

Hay for sale: Good quality CRP \$55 a bale, if you take 100 or more it's \$50 a bale, JD 567 baler, net wrapped. 660-651-8546 Atlanta MO

#### Livestock

10 Chicks, 2 weeks old, \$25.00 for all; 30 Quail, \$90 for all. 660-651-0424

Fish for stocking ponds. Catfish, Grass Carp, Crappie, Bluegill, Redear, Bass and minnows. Heindselman Family Farms. Call Greg 660-341-5692.

### MERCHANDISE

#### Appliances

GE 37" small chest freezer, \$135.00, 6 vintage barrel style kitchen chairs, \$9.00 each, 2 tractor rims fire pit only, \$15.00 each. 217-257-1385.

#### Building Supplies

Roof Trusses 2', 4', or 8' on center up to 80' wide Call with your size and quantity and we'll give you a quote. Shelby Supply 660-299-0615

Are you having a garage sale or rummage sale? Call us to advertise. 660-665-8500.

### ANNOUNCEMENTS

#### Notices

LOW COST HEALTH INSURANCE Plans for Every Budget Doctor Visits, Prescriptions Use Any Doctor or Hospital Inpatient, Outpatient, Surgery To Find Out More about these Affordable Health Plans Call Jim Minear 800-259-5682

Have Clutter? Need room? Call the NEMO classifieds. We can help! 660-665-8500.

**Premium Metal Roofing**

**AW Metal Inc.**  
Metal Roofing Headquarters

641-664-3990 • ammetal.net

**LAN-DOW BUILDINGS**  
 "We Build To Suit Your Needs"  
 "Custom Built"  
 Pole Barns • Garages • Utility Buildings  
 "H" Don or Dick Middleton  
**Memphis Lumber Co.**  
 1-800-337-5858 • 660-465-8595  
 Fax: 660-465-8596

# Hillside Metal, Lumber & Supplies

**NEW Full Line of LUMBER in STOCK**

**METAL CUSTOM CUT TO LENGTH**

- \*Trim, Screw and Accessories
- \*Windows & Doors
- \*Over Head Doors
- \* Rebar

**INSULATION**

- \*Blow in insulation

**COMPLETE BUILDING PACKAGES**

Stop by today to get our Best Prices

**REGULAR & TEXTURED METAL**

26, 29 Gauge Metal with 40 year paint warranty

**Customer Appreciation Day 09/23!!**

- \*Received 5% discount all Day!!
- \*Food From 4pm to 7PM
- \*Door prices

Office hours: Monday thru Friday / 7am to 5pm  
 21564 State Hwy J Brashear, Mo 63533



# SHELBY SUPPLY

## METAL • LUMBER • BUILDING PACKAGES

Great pricing on yellow pine lumber

GOOD FOR

- Horse Stalls
- Hog Buildings
- Chicken Barns
- And much more!!

Call Monday-Friday for current prices



7959 Shelby 348 • Emden, MO 63439 • From Hwy 168 go south on Hwy T 1 mile to shelby 348 on the right • Phone 660-299-0615 • Fax 660-299-0709

### LANCASTER LUMBER INC.

Lancaster, MO.

1-800-424-5071

LAN-DOW BUILDINGS

www.lancasterlumber.com



**Building Supplies**

Insulated Vinyl windows in stock up to 3'x5' with Lowe. Shelby Supply 660-299-0615

**Miscellaneous**

Amana electric stove, coils, \$125, Kitchen table, 2 leafs with chairs, \$75; Curio Cabinet, \$50; Vintage Secretary desk with drawer, \$25; Singer Sewing machine/table; Futon \$10; Desk \$10; Chest of drawers, \$10; Kitchen utility cart \$10; Much more, all will be sold. Kahoka Area 217-257-1385

**Miscellaneous**

Used guard rails, 25' sticks, 1400' \$4.00 per foot. 660-216-0618

**Sports Equipment**

Local dealer for Lazyman fiberglass deer blinds. Pricing starting at \$1,399.00. Several models to choose from Heindselman Family Farms. 660-341-5692.

**Wood & Accessories**

Wevers Outside Wood Furnaces, have an assortment of parts, line, and etc. Call 660-423-5242, cell 660-216-9885. Open 6 p.m. - 9 p.m. Monday - Friday, Saturday anytime, call first.

**Pets & Supplies**

Toy Australian Shepherds, three female red merles, 1 red tri male. been wormed and two puppy shots. 660-3412-0410.

**Pets & Supplies**

Beagle puppies for sale. Purebred, AKC Registered. Black White & Tan and Lemon & White. Good hunters and companions. Shots, wormed, ready to go. \$300. 641-233-7771

**Pets & Supplies**

Siberdoodle puppies, 2 cream, 2 white, 2 female, 2 male, blue eyes, 7 weeks old, vaccinated. 660-341-9984.

Call us for all your advertising needs. 660-665-8500.

**Pets & Supplies**

Four pure bred Rat Terriers, two males, two females, \$100.00 each. Shots up to date, dew claws pulled, tails docked, three months old. 641-895-4995.

**REAL ESTATE SALES**

**Mobile Homes For Sale**

I Buy.....used mobile homes. Call or text 573-338-6250 or email GregS.CDH@outlook.com

We Have Mobile Homes - instock new arrivals (8) homes, need to go as soon as possible! 573-499-9993 columbiadiscounthomes.com

New Mobile Home Stock - just received (5) new units, they gotta go! 573-657-2176 amegamobilehomes.com

TINY HOMES We gottem 573-881-3283

True Modulars 30 to 60 day delivery available, 3 and 4 bedroom. 573-657-7040 chateauhomes.net

**RECREATION**

**Campers & Trailers**

1999 Dutchman camper, slide out. Twenty eight foot long, salvage title. Sink, microwave, fridge, freezer. \$1800.00 or best offer. 660-342-0410.

5x10 tilt trailer, new tires. 2017 Ford F150 super cab, 55,000 miles, new tires. 785-893-2706.

**RECREATION**

**Accessories-Recreation**

Local dealer for Lazyman fiberglass deer blinds. Pricing starting at \$1,399.00. Several models to choose from Heindselman Family Farms. 660-341-5692.

**Motorcycles**

WANTED TO BUY: Harley Davidson's, any year, any condition, cash money. Days 660-263-1356 or 660-537-0068

**Other-Recreation**

Food plot, 10' AC drill, 2 boxes, Williamstown, MO. \$2750.00. Text and I will call you. 217-653-7100.

**Wanted**

WANTED TO BUY: Harley Davidson's, any year, any condition, cash money. Days 660-263-1356 or 660-537-0068

**Air Conditioning/Heating**

**The Ultimate Wood Heat.**



- **More Comfort** - Thermostatically controlled wood heat.
- **Peace of Mind** - Keep the fire outside and eliminate the dangers associated with indoor wood heating.
- **Save Money** - Wood is a renewable, inexpensive and often free energy source.

**CAMPEN**

Heating & Air Conditioning  
573-288-8966  
Canton, MO

CentralBoiler.com

**Chat/Dirt/Gravel**

**DIRT WORK** All types of excavation, reclaiming overgrown fields, including CRP and WRP. Building site preparation, creating new trails and crossings, Food plot development and maintenance. Leveling and grading, wetland construction and maintenance. Pond and lake cleaning and construction. Call for quotes. 660-342-2701

**Construction-Services**

**SPRAY FOAM INSTALLATION!** We install open and closed cell spray foam. Strengthen your building and block drafts! Over 1 Million sq. ft. applied. Contact Lester at 641-208-7071, Spray Tex LLC 16302 192nd Street Bloomfield IA 52537

D&J'S

SCREEN PRINTING  
*and embroidery*

SLINGIN' INK  
for  
OVER  
25  
YEARS

816 W NORTHTOWN RD  
KIRKSVILLE, MO

660.665.8001

let's be friends



KIRKSVILLESHIRTS.COM

# Beilstein

CAMPER SALES

573-655-2254

CALL US NOW  
for the best prices...

28248 327th Ave.  
LaGrange, MO • Hwy 61 South,  
4 Miles South of LaGrange, MO

 <p style="font-weight: bold; color: red;">#815443</p> <p style="font-weight: bold; font-size: 1.2em;">\$35,995</p> <p><b>2018 Keystone Impact 330</b> TOY HAULER, 2 Slide-Outs, Private Bedroom</p>	 <p style="font-weight: bold; color: red;">#004001</p> <p style="font-weight: bold; font-size: 1.2em;">\$13,995</p> <p><b>2006 Crossroads Crossfire 26FS TOY HAULER</b> TOY HAULER, Local Trade-in, Great Shape</p>	 <p style="font-weight: bold; color: red;">#109947</p> <p style="font-weight: bold; font-size: 1.2em;">\$21,995</p> <p><b>2022 Keystone Springdale Single Axle 1760BH</b> Slide-Out, Rear Bunkbeds, Front Queen Bed</p>
 <p style="font-weight: bold; color: red;">#089965</p> <p style="font-weight: bold; font-size: 1.2em;">\$46,995</p> <p><b>2022 Salem Hemisphere Hyper-Lyte 29XBHL</b> Luxury Super Slide-Out, 2 Queen Beds Plus Bunks</p>	 <p style="font-weight: bold; color: red;">#069758</p> <p style="font-weight: bold; font-size: 1.2em;">\$45,995</p> <p><b>2022 Salem 31KQBTS</b> 3 Slide-Outs, 2 Queen Beds and Bunks</p>	 <p style="font-weight: bold; color: red;">#109692</p> <p style="font-weight: bold; font-size: 1.2em;">\$19,995</p> <p><b>2022 Keystone Springdale Single Axle 1800BH</b> Bunkhouse, Light Weight Easy to Tow</p>

Beilstein Camper Sales

www.beilsteincampersales.com

Since 1956, family owned Beilstein Camper Sales has provided exceptional value and service to our customers. We feature a wide selection of new RVs from Forest River, Heartland and Keystone. We're on the Avenue of the Saints along side Highway 61, four miles south of La Grange, Missouri. Stop by today to get a great deal!

SMALL ADS WITH  
**BIG**  
RESULTS!

Small ads produce big results. Ask about our advertising rates to fit any budget.



### Show Me Plumbing Services



- General Mini Excavation & Skid Steer Work
- Livestock Watering
- Waterlines & Sewer Systems
- Residential Services & General Plumbing
- Utility Trenching

Stan Schrock 660-988-1163  
Greentop, MO 660-766-2636

Bush Hogging

### CUSTOM CHOPPING



ALL TYPES OF FORAGES PRESERVATIVE AVAILABLE

Devon Zimmerman 660.484.1324

### ATTENTION LAND OWNERS!

**BUYER OF STANDING TIMBER  
OWNER / OPERATOR OF SAWMILL - BUY/CUT LOGS  
CERTIFIED - BONDED - INSURED**



TRI STATE TIMBER L.L.C.  
PH. 660-341-4921 or 660-465-2975  
353 1/2 GRAND AVE. • MEMPHIS, MO 63555

Cleaning

### Scrubby Duds LAUNDROMAT

**OPEN 24/7**

Unfortunately, laundry doesn't wash itself. Might as well be comfortable while you do it.

**Scrubby Duds - Cool, Clean & Comfortable!**

311 S Baltimore St  
Phone: 660-349-8943



Home Services



### Signature Overhead Doors and Remodeling, LLC

660-785-0248

www.signatureremodelingkv.com

Residential and Commercial Installation and Service

# VICTORY Metals & Recycling

Kirkville, MO 660-665-8000  
victorymetalrecycling.com

For current scrap prices call or visit our Facebook Page

★ **Construction/Debris Recycling**

Visit Kirkville's construction & debris recycling facility and save trips to the landfill! Take advantage of this service for solid waste removal by bringing your landfill items to Victory Metals C & D recycling facility located at 3602 N. Industrial Rd.

★ **Roll-Off Container Service**

10-20-30-40 Cubic Yard Dumpsters



3602 N. Industrial Rd.,  
Kirkville, MO 63501  
djanessvmr@gmail.com  
www.victorymetalrecycling.com



### NOW RECYCLING PLASTIC and ALUM. CANS

United Way Community Partner

Community Opportunities, Inc.  
660-665-5768

Drop off at  
1001 S. Osteopathy Street  
Kirkville, MO.

Home Services

### SHOW-ME SEAMLESS GUTTERING

FREE ESTIMATES • PROMPT SERVICE

- 5" & 6" Gutters
- Siding • Soffit • Fascia

(23 colors available on Gutters & Fascia)

Tried of Cleaning your Gutters?  
**LEAFPROOF THEM!**

ELLIOTT HIX  
660-626-3447 • KIRKSVILLE, MO

Miscellaneous

### CELEBRATIONS PARTY RENTAL

KIRKSVILLE, MO

FOR RENT

- Tables & Chairs
- Tents • Bounce House
- Cotton Candy Machine & More!

660-626-5162 or 660-665-9380

### LIME SPREADING SERVICE

Equipped with variable rate



### PEAVLER TRUCKING LLC

Alan Peavler, 660-216-0618 - Jared Peavler, 660-342-7685

### JAGUAR LUMBER

Attn: Land Owners

Buyer of Timber  
\*All species also Select yard  
Trees/Logs over 40" diameter,  
\*Trees are selectively cut  
to insure optimal Forest  
Regeneration.

Certified & Bonded | Lavon Gingerich 641-664-2080

### STOMBAUGH ASPHALT

RESIDENTIAL ★ COMMERCIAL

- ★ PAVING
- ★ CHIP & SEAL
- ★ SEALING

573-406-8706



Lawn/Garden/Landscape

New 3 pt. tillers, heavy duty, gear driven, 7' to 12' starting at \$4,050. 660-874-4455.

Have Clutter? Need room? Call the NEMO classifieds. We can help! 660-665-8500.

Miscellaneous

Tomatoes \$2.00 lb, Zucchini \$ .50, Cucumbers \$ .50, Green Onions and More Produce Coming Soon. Kauffman Produce 11538 Iceberg Ave, LaPlata MO 63549

**NEED TO SELL YOUR HOUSE OR PROPERTY?** Get the best coverage around. Call the NEMO and our helpful representatives will assist you in creating your ad. You can even pay over the phone. Call 660-665-8500 for more information.

NEMOTRADER.NET



### From the Farm LLC

545 W. Hwy 6 • Trenton, MO 64683  
660-358-1509

From the Farm is a full service locker offering inspected and custom processing of livestock.

Flat rates, easy access, hauling and delivery available. Visit us for a tour and schedule your fall processing.

Our Farm raised beef and pork grown on pasture, finished on local grains, no added growth hormones or antibiotics is available for purchase as whole and halves cut to your request or as individual packages at all times.

6th generation Missouri farmer raising livestock the way our grandparents did. From our Farm to Yours



Locally grown  
Locally owned  
Dr. Dale V Alumbaugh Family

MISSOURI GROWN

### Mascots Marching for Meals

Saturday, September 17, 9 A.M.  
Kirkville YMCA Pavilion



Join area mascots for the 4th annual Mascot March, a 1.8 mile march hosted by The Food Bank. Registration is \$20 and event proceeds go toward feeding kids in Adair County. To make sure you get a t-shirt, register by September 2 at [sharefoodbringhope.org/mascotmarch](http://sharefoodbringhope.org/mascotmarch)





abc 03 KTVO STUDIOS  
KTVO.com



# TIMBER MANAGEMENT.

*Purchasing Walnut, Oak, Maple & Other Species*

**WE PAY BEFORE WE CUT**

**BONDED & INSURED** *Est. 1968*

**641-895-8209** 643286cb

**There's a better way to get noticed.**

Keep life simple. Take out an ad.



Trucks, 4x4's, SUV's

## CUSTOM NO TILL GRAIN DRILLING



**SPECIALIZING IN COVER CROPS**  
 Devon Zimmerman 660.464.1324

Miscellaneous

SCOTT HUSKEY'S HOME SERVICE R-10 Foundation Enclosure Systems for manufactured, modular, & site built homes. Saves on utilities and prevents freeze ups. General maintenance and repairs since 1972 573-696-3468 "GO DAWGS"

**NEMOTRADER.NET**

**There's a better way to get noticed.**

Keep life simple. Take out an ad.

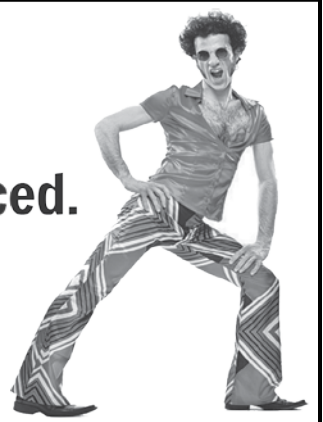

## AUTO'S UNLIMITED

660-665-8149 | 660-341-0965

No Sunday Calls! | 17406 Bob Rd • Kirksville, MO

### FEATURED VEHICLES

**White Ford Ranger FX4 XLT**  
Excellent Condition, four-wheel drive extended cab four door with 158,000 MI



**1986 Bronco 2**

with 64,000 MI cold AC excellent condition



**Trailer 16 ft with 2 ft dovetail**  
total 18 ft 12,000 lb capacity excellent condition



**\$3,850** or Best Offer

ALL VEHICLES HAVE GONE THROUGH A 60 PT INSPECTION! STATE INSPECTED! CALL FOR MORE INFO!

# BURKHOLDER



**2020 Ford F-250 XLT, 4x4, Reg Cab,**  
 Longbed, 6.2V8, Auto, 83k One-Owner Miles, Very Well Kept, Hard to Find, White

**\$46,900**

Full line of accessories  Outfit your truck here!

**Edina 660-397-2551 51001 State Hwy 15 BurkholderTruckSales.com**



**\$49,900**

**2020 Ford F-250 XL STX, 4x4**  
 Crew, 6.7 Diesel, 141k One-Owner Miles, Clean Carfax, New Tires, Nice-Clean, Red



**\$33,500**

**2019 Nissan Armada SV, FWD**  
 5.6V8, Auto, 56k Miles, Clean Carfax, Nice-Clean Ride, Come Drive, Silver



**\$26,900**

**2019 Dodge Grand Caravan GT**  
 7 Pass, 3.6V6, Auto, 49k Miles, Stow-Go, Nice-Clean, Southern Van, Come Drive, Blk



**\$18,900**

**2017 Dodge Grand Caravan SE Plus**  
 7 Pass, 3.6V6, Auto, 71k Miles, Stow-Go Seats, Local Trade, Family Ready, Silver



**\$59,900**

**2015 GMC Sierra 2500HD SLT Z71**  
 4x4, Crew, 6.6 Duramax, Allison, 58k One Owner Miles, Oklahoma Truck, Nice, Green



**\$26,900**

**2015 Chevy Traverse LTZ AWD**  
 3.6V6, Auto, 76k Mi, Clean Carfax, Excellent Service Record, Southern Ride, Blue



**\$24,900**

**2013 Ford E-350 XLT, 12 Pass**  
 5.4V8, Auto, 112k Miles, Texas Van, Hard to Find Family Van, Come See, Silver



**\$39,900**

**2013 Chevy Suburban 2500 LS**  
 9 Pass, 4x4, 6.0V8, 78k Mi, One-Owner, Southern Vehicle, Hard to Find, Nice, Silver



**\$49,900**

**2016 Chevy Silverado 3500HD WT**  
 4x4, Double Cab, 6.0V8, Auto, 76k One-Owner Mi, Knapheide Utility Bed, White

**Financing Options Available**

COVERCRAFT

## Carhartt SeatSaver Custom Seat Covers



**COVERCRAFT**  
 SINCE 1965



DON'T JUST PROTECT IT

## LINE-X IT

SLIP-RESISTANT SURFACE. PREVENTS RUST & CORROSION. IMPACT, ABRASION & CHEMICAL RESISTANT.

LIFETIME WARRANTY



**LINE-X**

Quality Brands We Carry



# AUTO & TRUCK SALES + ACCESSORIES





# MUST SELL ALL MUST GO!



1999 F250 Superduty with welder tool box loaded Also garage full of tools & Drill Press

Call 660-342-2122 or 660-216-5656

## Automobiles

1995 Ford Explorer, 4x4, Limited Edition, black, gray leather, 2nd owner, daily driver, tow package, little rust, runs and drives well, \$2700. Call or text for more details, Moulton IA 319-560-6720

**NEED TO SELL YOUR HOUSE OR PROPERTY?** Get the best coverage around. Call the NEMO and our helpful representatives will assist you in creating your ad. You can even pay over the phone. Call 660-665-8500 for more information.

NEMOTRADER.NET

# Judd Motors

Call 660-457-3700  
Hwy 63 North, Lancaster, MO

**2000 Chevy Tracker,** 2 door, 4WD, Soft Top, AT, only 125K miles, red, very nice, **only \$6,995**

**2013 GMC Sierra 1500,** SLT, crew cab, leather, 4WD, red, 140K miles, excellent, **\$21,900**

**1998 Chevy 1500,** ext. cab, 4wd, Z71 350 engine, 164K, black, runs great!! **\$4,250**

**2014 Dodge Grand Caravan,** SXT, power seat, power sliding doors, power rear hatch, Sto-N-Go, silver, only 92k miles, **now only \$13,900**

**2004 Chevy Trailblazer,** LT, 4wd, 4.2L, cloth, only 108k, charcoal, nice, **only \$6,995**

**John Deere 4720 Tractor** MFD, 58 hp, Hydrostat, cab/AC, 400CX loader, air seat, rear remotes, ONLY 960 hrs, Diesel. **\$8,995**

**2011 Chevy Suburban,** LTZ, 4WD, sunroof, DVD, leather, black, 141K miles, quad seats, **\$17,900**

**2007 Ford Freestyle Limited,** AWD, leather, sunroof, 3 row seating, 220K, black, drives great, **only \$4,250**



Cumberland Building Dealer

www.juddmotors.com

In Business Over 75 Years  
Curly and Kevin Judd

## TRANSPORTATION

### Automobiles

2004 Ford Taurus SE, recently serviced, new brakes, battery, working air, rust, light hail, \$224,000 mile. Same owner last 14 years, come and drive it home, \$900.00. Accelerators since "1974", Kahoka, MO. 217-257-1385.

**BE AN EARLY BIRD!** Place your ads before Monday and beat the rush!

### YARD SALES

#### Garage Sale

Garage and bake sale with variety. Friday and Saturday, September 2 and 3. Lots of glassware, salt/pepper shaker collection. Kitchenware, puzzles, miscellaneous. Johnnie Burkholders, 13296 State Hwy 3, LaPlata. One mile South of Hwy 156 on 3 South.

Call about our classified ad specials. 660-665-8500.

# WE HAVE YOUR DREAM CAR!



Keeping You on the Road

car-mart.com



## We Offer:

- Peace of Mind Package
- Service Contract Plus
- Accident Protection Plan
- 100% Satisfaction
- Pay Your Way
- Low Down Payments
- Quality Used Vehicles
- Flexible Financing
- Hand Selected Vehicles
- Convenient Payment Options
- Start Your Approval Online
- Over 150 Locations
- 40 Years in Business
- We Buy Cars

660-956-4849 • 2015 North Baltimore • Kirksville



2015 DODGE GRAND CARAVAN  
FWD, 6 Cyl., Black



2015 FORD ESCAPE  
4WD, 4 Cyl., Silver



2014 CHEVROLET CRUZE  
FWD, 4 Cyl., Red



2014 DODGE GRAND CARAVAN  
FWD, 6 Cyl., Maroon



2013 BUICK ENCORE  
FWD, 4 Cyl., Maroon



2012 KIA SOUL  
FWD, 4 Cyl., Silver



2015 CHRYSLER 200  
AWD, 6 Cyl., Black

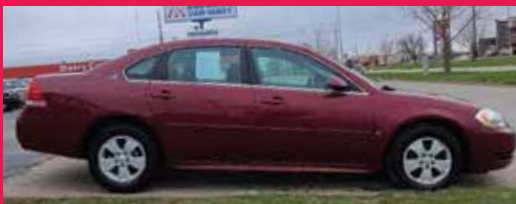

2009 CHEVROLET IMPALA  
FWD, 6 Cyl., Maroon



2012 TOYOTA RAV4  
4WD, 4 CYL., BLACK



2011 CHEVY TRAVERSE  
AWD, 6 Cyl., Silver



2016 CHEVROLET CRUZE  
FWD, 4 CYL., BLACK



2016 KIA SOUL  
FWD, 4 Cyl., Gray



2016 CHEVROLET TRAX  
FWD, 4 Cyl., Black



2015 JEEP PATRIOT  
FWD, 4 Cyl., Gray



2014 JEEP CHEROKEE  
4WD, 4 Cyl., Black



2017 NISSAN ALTIMA  
FWD, 4 Cyl., Black



2013 HYUNDAI GENESIS  
RWD, 6 Cyl., Gray



2012 GMC ACADIA  
AWD, 6 Cyl., Black



Keeping You on the Road



KYLE JENNINGS  
GENERAL MANAGER

662283jn



# Seymour Amish BENEFIT SCHOOL AUCTION

# 13<sup>TH</sup> ANNUAL SEPT 3, 2022

## SALE STARTS AT 9:00AM

QUILTS SELL APPROXIMATELY 11AM · MACHINERY 2PM

**COMMUNITY CENTER  
3010 EDISON ROAD - SEYMOUR, IA 52590**

**CONSIGNMENTS ACCEPTED UP UNTIL 9AM SALE DAY**

**Amish ladies serving Pancake Breakfast 7-9AM · Lunch will also be served**

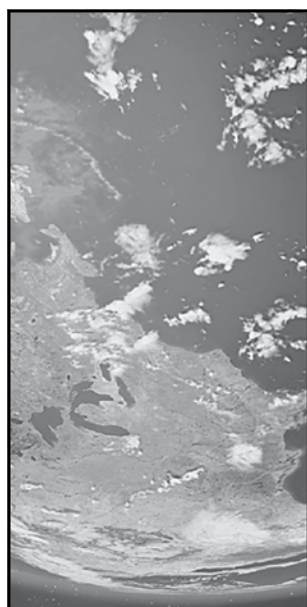
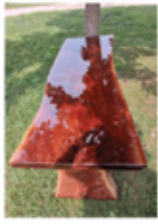

**SKID LOADERS**

259D CAT 1,900 HRS. OPEN CAB W/  
2 SPEED GOOD CONDITION 641-895-8395  
2012 259 B3 CAT 3,350 HRS. STANDARD  
FLOW 2 SPEED CAB W/ HEAT/AIR 641-898-2952  
2013 KABOTA SVL 75-2  
2,250 HRS. GOOD MAINTENANCE 641-874-5990  
2020 T66 R SERIES BOBCAT CAB  
LOADED 2 SPEED 340 HRS. 641-898-2223  
**ATTACHMENTS: HYDRAULIC BRUSHHOG  
NEW HYDRAULIC GRAPPLE**

**COMPLETE CARPENTRY SETUP**

TOOL TRAILER · LASER TRANSIT  
2 MAKITA SKILL SAW  
3 BOSTITCH SHINGLE NAILERS  
4 PASLODE FRAMING NAILERS - 1 NEW  
2 SOFFIT STAPLERS · 4 AIR DRILLS  
PASLODE JOICE HANGER NAILER  
GAS POWERED HAMMER DRILL  
2 IMPACT AIR DRILL · 2 LADDER JACKS  
PUMA TWIN TANK AIR COMPRESSOR - GAS MOTOR  
2 24' EXTENSION LADDER · VARIETY OF HAND TOOLS  
1 6' FIBERGLASS STEPLADDER  
2 ALUMINUM THREE STEP SAWHORSES  
2 COLLAPSIBLE SAWHORSES  
6 SHINGLE SHOVELS · DOUBLE BEVEL MITER  
BOSCH CHOP SAW W/ 45" CABLE & DEWALT STAND  
EVERYTHING IN WORKABLE & GOOD CONDITION  
WELL CARED FOR LINE UP  
LOTS OF HAND TOOLS  
EARTHQUAKE 18' TILLER USED 1 SEASON

**HOUSEHOLD**

NEW HACKBERRY DRESSER  
2'X6' LINE EDGE WALNUT TABLE  
CEDAR CHEST · RINSE TUBS  
NECCHI SEWING MACHINE  
1 SINGER 4 DRAWER TREADLE MACH  
1 WHITE 6 DRAWER TREADLE MACH  
SEVERAL SINGER HEADS · STORM DOORS  
3 BURNER OIL STOVE · 1 SS BAKER  
COLLAR CLOCK LIKE NEW  
2 ACOUSTIC GUITARS · 11' OAK CHURCH PEW  
3X10 SHUFFLE BOARD EXCELLENT CONDITION  
NEW KID'S, WOMEN, & MEN'S BOOTS  
1 LOT OF MEN & WOMEN'S SHOES

**BUILDINGS LUMBER & MISC.**

NEW SANDBOX W/ ROOF  
1 5X7 CHICKEN COOP W/ 10X10 PEN  
1 7X7 PLAYHOUSES  
1 RED CEDAR CHICKEN COOP  
277 2X6X10 #2 TREATED  
196 2X6X8 #2  
1 UNIT WALNUT LUMBER - VARIOUS SIZES  
300' 3/4 MAPLE CROWN MOLDING  
9' 6"X31' LOFT FLOOR W/ 3/4 OSB TNG  
2 NEW SCHWINN SCOOTERS  
18X12 MINI BARN 36' WALK DOOR 5' SLIDER

**TOOLS**

1 LOT 1/2 & 3/4 PEX HOSE - 100 ROLLS  
SQUIRREL CAGE FAN · AIR HOSE REEL  
DRYWALL LIFT · COOPER SKIL SAW  
ALLEN EDGE CEMENT TROWEL

**ANTIQUES**

1 ROW JD PLANTER · ANTIQUE DRILL  
POTATO PLOW · CREAM SEPARATOR  
ONE MAN CROSSCUT · TWO MAN CROSSCUT  
PUMP JACK · BULL LEAD SMALL ANVIL  
8' AERMOTOR WINDMILL - GOOD COND.  
MCCORMICK SALT BOX GAS ENGINE ON CART

**QUILTS**

AUTUMN SPLENDOR BLACK/WHITE  
DIAMOND TIARA CROSS · CIRCLING STARS  
TEAR IN THE WINDOW · TEAR PANEL  
PURPLE LONESTAR · TUMBLING LOG  
5 MOUNTAIN ECHOES - VARIETY OF COLORS

**FLOWERS**

400 + MUMS & SOME LARGE PLANTERS  
13 EVERESS SEEDLESS GRAPES - 16 CONCORD GRAPES  
10 ROSES · 32 FLOWERING BUSHES  
15 HYDRANGEA · 50+ FRUIT & APPLE TREES  
LARGE VARIETY OF SHADE TREES - MAPLE ETC.  
45 HIBISCUS VARIOUS COLORS · 18 LILAC & 18 SHRUBS

**MACHINERY**

JD BIG 4 MOWER W/ 6' BAR  
HENKE 32" PORTABLE ROLLERMILL  
NEW HOLLAND 456 MOWER W/ 7' BAR - GOOD SHAPE  
4 BT 3.9 LITER CUMMINS DIESEL 92 HP W/ CLUTCH  
20 H 2 CYL. KABOTA DIESEL POWER UNIT W/  
20 GAL CAP - HYD. UNIT & AIR COMPRESSOR  
10' LAWN MOWER TRAILER W/ RAMPS  
22' HAY CONVEYOR · 26' HAY CONVEYOR  
FLARE BOX WAGON ON GEAR  
2 300 FUEL BARRELS ON STAND  
FEED BUNKS / WATER TANKS  
7X8 HAY SAUER W/ ROOF  
10' FIBERGLASS BUNK HAY SAVER COMBO  
50' KEWANNEE 500 ELEVATOR  
4 500 GAL AIR TANKS · 2 1000 GAL AIR TANKS  
SHOVEL CULTIVATOR · DISC CULTIVATOR  
BOB SLED · 10 9' HEDGE CORNER POSTS  
20 9' HEDGE LINE POSTS  
2 LP TANK HEATERS

**BUGGIES**

NEW 44" SINGLE TOP BUGGY DEL. STYLE FULLY  
EQUIPPED W/ LED LIGHTS BROWN INTERIOR TORSION  
GEAR DICS BRAKES & STEEL WHEELS  
NEW SEYMOUR STYLE SINGLE BUGGY TORSION AXLE GEAR  
DISC BRAKES STEEL WHEELS LED LIGHTS GRAY INTERIOR  
NEW SEYMOUR STYLE SURREY BUGGY TORSION AXLE GEAR  
W/ DISC BRAKES - STEEL WHEELS LED LIGHTS GRAY INTERIOR  
NEW WOOD SHAFTS NEW FIBERGLASS SHAFTS  
2 USED SEYMOUR STYLE SINGLE TOP BUGGIES  
USED SEYMOUR STYLE SINGLE TOP BUGGY GOOD  
SHAPE W/ RUBBER MOUNTS & LIGHTS  
3 USED SEYMOUR STYLE SURRIES 1 W/ NEW  
PAINT WOODEN COB SIZED SHOW CART  
COVERED WAGON PEOPLE HAULER

**HUNTING**

2020 VISION EZ HUNTING BLIND ON TRAILER  
EZ RIFLE BLIND ON 8' TOWER  
BOWS: HOYT CARBON G3 WOODS READY  
2017 HALON MATHEWS 32" ATA FULLY LOADED  
MATHEWS NO CAM ST - FULLY LOADED W/ ARROWS  
2 COMPOUND BOWS - MULTIPLE TREE STANDS  
10' FLAT BOTTOM ALUMINUM BOAT  
CANOE W/ TROLLING MOTOR  
2 INFORMATIONAL HUNTING BOOKS

**HARNESSES**

SEVERAL GOOD USED COLLARS & HARNESSES  
16" CIRCLE Y TRIAL SADDLE  
16" HERFORD ROPING SADDLE  
HORSE MUZZLE  
NEW BIO BUGGY HARNESSES SS HANES & HARDWARE

**LAWN & GARDEN**

NEW 12 VOLT LAWN SPRAYER - WALK BEHIND WEEDWATER  
32" DIXON DECK MOWER W/ NEW MOTOR WORKS GOOD  
48" SWISHER LAWMOWER W/ SHAFTS GOOD CONDITION  
DR 34" BRUSH MOWER  
DR 30" BRUSH MOWER  
RR 26" BRUSH MOWER  
BCS TILLER EXCELLENT COND.  
NEW 37 TON BRAVE PRO SPLITTER WHONDA GX 270  
VARIETY OF GARDEN TOOLS ECT.

**MORE HORSES EXPECTED BY SALE DATE!**

**THIS ONLY A PARTIAL LISTING,  
MORE EXPECTED BY SALE DATE.**

FOR MORE INFO CALL: ADEN 641-203-6680  
ERVIN MILLER 641-898-2223 · RAYMOND MAST 641-898-2808

**HORSES**

LEVI YODER  
2 YR OLD REG. BAY STB GELDING  
SIRE MACDUFFY BROKE  
10 YR OLD REG. BAY STB  
BROODMARE IN FOAL TO MORGAN  
27 YR OLD BLACK STB MARE  
IN FOAL TO MORGAN  
BLACK WEANLING MORGAN  
X STB CROSS FILLY  
BAY WEANLING PONY FILLY  
DARK BUCKSKIN WEANLING PONY FILLY  
BLACK WEANLING PONY STUD COLT  
DANIEL MULLET  
OLLIE 2 YR OLD REG. ROAN AQHA GELDING  
HAS BEEN ON LOTS OF TRAILS. VERY  
CALM & GENTLE. LOVES ATTENTION  
LEON WEAVER  
ROCKY IS A 2 YR OLD BLUE ROAN  
PERCHERON STALLION. WELL STARTED TO RIDE QUIET &  
GENTLE WELL MANNERED WE HAVE MARE'S ULTRA-  
SOUNDED IN FOAL TO HIM - CHECK HIM OUT 319-677-0653  
JONATHAN STUTZMAN  
TEAM OF SMOOTH MOUTH BELGIAN  
GELDINGS 18 HH - BROKE ANYWAY SINGLE & DOUBLE  
THOMAS HELMUTH  
4 YR OLD CHESTNUT 1/2 MORGAN 1/4  
PONY 1/4 QTR HORSE GELDING  
BROKE TO RIDE & DRIVE. MORE INFO SALE DAY  
EDWIN JR. GINGERICH  
MARE 2 YR OLD 47" SORREL MARE  
WELL BROKE TO RIDE  
EDWIN GINGERICH  
WEANLING MINI BUCKSKIN STUD COLT  
WEANLING BLUE ROAN PAINT STUD COLT  
SHOULD MATURE TO 52"  
FRED YODER  
3 YR OLD PONY GELDING BROKE TO RIDE  
AND DRIVE - NOT FOR BEGINNERS  
HENRY BYLER  
2 YR OLD 44" BAY FILLY BROKE  
2 YR OLD 34" RED ROAN  
MINI FILLY STARTED  
2 YR OLD 34" BLUE ROAN  
MINI FILLY STARTED  
MAHLON STUTZMAN  
11 YR OLD BAY STB CROSS  
GELDING BROKE TO RIDE & DRIVE TSS  
REUBEN TROYER  
WEANLING BLUE ROAN 1/2 PERCHERON  
3/8 STB 1/8 PONY FILLY HALTER BROKE  
WEANLING BLACK 1/2 PERCHERON 1/4 FERSIAN  
1/8 STB 1/8 PONY STUD COLT BROKE  
5 YR OLD RED /WHITE GYPSY GELDING 13.2HH  
3 WEEKS OF TRAINING REG AVAILABLE  
CLARENCE HELMUTH  
4 YR OLD 50" BLACK QTR PONY GELDING W/  
2 WHITES & STAR BROKE TO RIDE & DRIVE - SHARP!  
2 YR OLD BLUE ROAN PERCH X QTR CROSS  
GELDING W/ 30 DAYS TRAINING - QUITE & GENTLE  
VERNON YODER  
5 YR OLD BLACK QTR PONY BROKE  
TO RIDE - NICE QTR PONY  
MERVIN GRABER  
ALL COLTS FROM REG PULLING BRED STALLION  
3 BELGIAN FILLIES - SIRE DUKE'S DUBILLE  
BELGIAN STUD COLT - SIRE DUKE'S DUBILLE  
BELGIAN CROSSBRED W/ STRIP 2 WHITES  
SAM MILLER  
SMOOTH MOUTH BELGIAN GELDING  
JOE BORNTRAGER  
36" BAY PONY GELDING BROKE GOOD TO  
RIDE/DRIVE - BEGINNERS PONY  
ADEN HELMUTH  
WEANLING BLACK QTR PONY STUD COLT  
4 YR OLD BAY MINI MARE  
RIDE & DRIVE QUIET/GENTLE  
CHESTER WILLIAMS  
16 YR OLD REG BELGIAN STALLION  
16.2HH - BROKE GOOD TO DRIVE SIRE  
CD'S CRACKERJACK

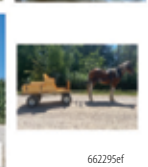
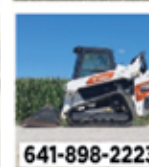
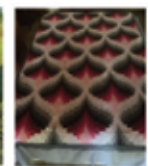

**SPACE AVAILABLE**  
ASK ABOUT OUR OUT-OF-THIS-WORLD PRINT ADVERTISING RATES THAT FIT ANY BUDGET!

# There's a better way to get attention.

Keep life simple.  
Take out an ad.





## Mid-States Horse & Tack Auction

**Saturday September 24, 2022**  
Tack @ 10:00 A.M. Horses @ 2:00 P.M.

KIRKSVILLE LIVESTOCK MARKET  
HWY 63 NORTH KIRKSVILLE MO.

**Taking early consignments now!**  
**Check us out and like us on**  
**Facebook @ Mid-States**

**Livestock Sales for our early**  
**listings and videos. Guest**  
**Consigners only on tack.**



**FOR MORE INFO:**  
Josh Weaver (660)341-7964 • Jeb Weaver (660)341-1866

### Macon County, Missouri LAND AUCTION

SATURDAY SEPTEMBER 17, 2022

AUCTION 1: 1:00 PM  
AUCTION 2: 2:00 PM

**AUCTION 1**  
Splitting into 7 tracts. Tracts 1-7 for identification purposes only. Stretching 1,156.45 surveyed acres almost all contiguous. From the magnificent location, beautiful views, crop land, timber, gorgeous lake, multiple ponds, this ranch reflects the dream of large land ownership at its finest.

- HIGHLY TILLABLE
- MATURE WHITETAIL

**AUCTION 2**  
Splitting into 3 tracts. They'll be Tracts 8-10 for identification purposes only! Farms are east of Lapata and Atlanta Mo. Properties represent highly usable crop land, ROI, and recreation opportunities.

**TRACTS 1-7**  
1,156.45 ACRES  
10 TRACTS

**TRACT 8**

**TRACT 9-10**

ANDY BOYER AGENT 656-295-1476    JASON COURTNEY BROKER 816-654-2144

## SULLIVAN AUCTIONEERS, LLC

A FAMILY OWNED BUSINESS SINCE 1979

  
MATT

  
MICHAEL

  
LUKE

  
JOHN

  
DAN

  
JOE

  
JIM

  
BILL

Headquartered in Hamilton, Illinois, Sullivan Auctioneers, LLC is one of the largest Real Estate and Farm Machinery Auctioneers in the nation. For more than 40 years we have been conducting professional auctions. We connect our sellers with thousands of interested buyers around the world.

**Considering an Auction?**  
CALL OR EMAIL TODAY FOR A NO OBLIGATION CONSULTATION!  
Toll Free (844) 847-2161 | Sold@SullivanAuctioneers.com  
www.SullivanAuctioneers.com | Lic. #444000107

## FIND THE RIGHT RIDE FOR THE RIGHT PRICE

*Find the stuff you want. Sell the stuff you don't.  
Save time and money with your  
local newspaper classifieds.*



## ED'S MACHINERY LLC

QUALITY MACHINERY SINCE 1997

**660-628-4454**

[www.edsmachinery.com](http://www.edsmachinery.com)

 <p><b>2016 JOHN DEERE 6125M</b> 538 Hrs, 24 Speed Power Quad Trans, MFWD...<b>\$129,000</b></p>	 <p><b>2008 JOHN DEERE 8530</b> 8,516 Hours, IVT, MFWD, Big 1000 Pto...<b>\$114,900</b></p>	 <p><b>2005 JOHN DEERE 9320T</b> 4762 Hours, Power Shift, 4 Scv's, Buddy Seat...<b>\$97,500</b></p>
 <p><b>2012 CASE IH MAGNUM 235</b> 1,069 Original Hours!, Power Shift, MFWD...<b>\$165,000</b></p>	 <p><b>2014 CASE IH FARMALL 120A</b> 421 Hrs, Power Quad Trans w/ Lft. Hand Rev., MFWD...<b>\$79,500</b></p>	 <p><b>2006 CASE IH MX285</b> 6,545 Hours, Power Shift, MFWD...<b>\$68,500</b></p>
 <p><b>2019 JOHN DEERE 9600</b> 3639/1828 Hours, Pro Drive 40 KPH Trans, 4x4 ..... <b>\$229,500</b></p>	 <p><b>2018 JOHN DEERE S780</b> 1381/947 Hours, 4X4, Con-tour Master...<b>\$322,500</b></p>	 <p><b>2010 CASE IH 8120</b> 4223/3208 Hrs, 2WD, Bin Ext, Pro 600 Screen... <b>\$59,900</b></p>
 <p><b>2013 JOHN DEERE 612C</b> 12 Row, 30", Poly Snouts, Hyd Deck Plates... <b>\$38,500</b></p>	 <p><b>2014 JOHN DEERE 635FD</b> 35 Ft Cut, Single Point, Hyd Fore/Aft...<b>\$57,500</b></p>	 <p><b>2015 CASE IH 4412</b> 12 Row, 30" Spacing, Head Height, Knife Rolls... <b>\$59,500</b></p>

**17920 US Hwy 136 • Memphis MO 63555**

## ANNUAL FALL FARM MACHINERY / EQUIPMENT AUCTION

**SATURDAY OCTOBER 8, 2022 9 AM**

ITS TIME TO LIST YOUR EQUIPMENT  
**EQUIPMENT COMING IN !**

FARM EQUIPMENT, POSTS, FENCING, ATV'S, TOOLS, HAY,  
LAWN/GARDEN, CONSTRUCTION, FARM RELATED ITEMS

### DEMRY AUCTION, LLC

1916 S 18th St, (Hwy 5 SOUTH) CENTERVILLE, IOWA

Tom Demry: 641-895-2508  
Janet Demry: 641-895-4310 641-856-6408  
Kristy Demry: 641-895-2509 661788cb  
Junior Lawson: 641-895-0037 Randy Mulay: 641-436-1521

## Farm Equipment & Collectible Auction

**Saturday, September 10, 2022 at 10:00 a.m.**  
**The Late Spencer Dwiggin's**

**Directions:** 28626 Sunset Drive, Macon, Missouri. From US Highway 36 West of Macon, take the Long Branch Lake Road exit and turn South on Long Branch Lake Road to the Outer Road South. Turn West to the auction location. Look for signs the day of the auction.

**Machinery and Equipment:** John Deere General Purpose tractor, starts and runs; GB Minneapolis Moline diesel; Z Minneapolis Moline; Case 1070 shows 8,300 hours; John Deere B parts tractor; Allis Chalmers C parts tractor; 18.4 x 34 set of duals; Massey Harris 44; John Deere A slant dash; John Deere B; John Deere B unstyled; John Deere A; John Deere MT with add on hydraulics; Minneapolis Moline thrasher; John Deere 112; John Deere 110, original tires; John Deere 110; John Deere 100; John Deere 60 with 237 mounted corn picker; John Deere side deliver rake; John Deere corn sheller; John Deere 1460 Mower conditioner; John Deere 400 grinder mixer; portable cattle chute; Case 930 Comfort King, 2 remotes, should start and run; John Deere parts tractor; John Deere 316 mower; Ford front end loader; Vermeer V450 trencher, motor is no good; older motorized roller; 15" bat wing brush mower; John Deere 7" sickle mower; 3 point seeder; John Deere 14" manual fold disc with 9" spacing; 12 wheel V rake; pickup bed trailer; pull-type sweeper machine; Massey Ferguson 6", 3 point blade; semi trailer caddy; John Deere mounted sickle mower; John Deere 9", 3 point blade; John Deere pull-type seeder; Davis Bradley wagon running gear; several miscellaneous John Deere antique pull-type plows; 10 shank, 3 point chisel plow; John Deere 4 bottom plow; John Deere front end loader with trip bucket; John Deere mounted disc; 2 wheel trailer 10" x 69"; Drott parts dozer; John Deere wire tire square baler; older horizontal boring machine; 3 point 160 rotary tiller; several suitcase weights;

**Vehicles and Trailers:** 74" x 15" single wide mobile home with tongue and axles; Insulated enclosed trailer; 1986 Ford 5 speed dump truck, single axle, steel bed, good solid truck; 1984 SI900 International 5 speed metal flatbed; Ford 700 dump truck, does not run; Ford F350 custom parts; 3 point carry-all; full size van, does not run; 2002 Freightliner F250 with Mercedes Benz engine, shows 300,000+ miles, 1 fuel tank has a leak, 8'W x 16'L refrigerated box, has title; 1993 F250 XL 4x4 flatbed, 5 speed, needs clutch; 8" x 18" enclosed trailer; three 8" x 16" CONEX containers; 1970 F250 4x4 parts; 1974 Pontiac Catalina parts car; pickup bed trailer; 1975 or 76 Chevy Nova 2 door parts car; older Ford parts truck; 1963 1/2 Ford Galaxy 500 2 door; 1974 Nova;

**Livestock, Farm and Animal Supplies:** woven wire and chain link fence; hay ring; trailer house frame; mineral feeder; several culvert tubes 15' x 20'; light poles;

**Building supplies:** aluminum frame windows and doors; miscellaneous barn lumber and barn doors; treated bridge planks; miscellaneous pipe threading materials; a lot of PVC pipe; miscellaneous cinder blocks; lots of scrap iron and usable steel; lots of building materials; lots of PVC fittings and pipe;

**Antiques and Collectibles:** Pepsi sign; old feed scale; two 14" Western saddles; Black Jack approximately 155 pound anvil has been welded; antique items; Mac's Ice House sign; nail kegs

**Tools and Outdoor Equipment:** Hyundai 3000 pressure washer; Magnum LT 17 airless painter; Troybilt mini tiller; trash pump with hose; snow fence; walk behind concrete cutter; motorized ditch digging machine parts; water pipe reel trailer; power trowel; 2500 PSI power washer; NHA 6-12 200 amp battery charger; double headed electric grinder; Dewalt chop saw; Sears horizontal air compressor; There will be more items at this auction too numerous to mention.

**SEE MORE PHOTOS ON SCOTTY'S WEBSITE**

## SCOTTY'S AUCTION SERVICE



573-356-4405

Michael Cunningham 660-651-2288 • Paxton Pittman 660-346-1956  
[WWW.SCOTTSAUCTIONSERVICE.COM](http://WWW.SCOTTSAUCTIONSERVICE.COM)

## The Dale Owens No Reserve COLLECTOR CAR AUCTION

**SATURDAY, SEPTEMBER 3 • 10:30 AM**  
**PHYSICAL ADDRESS: 115 Pershing Dr., Brookfield, MO**

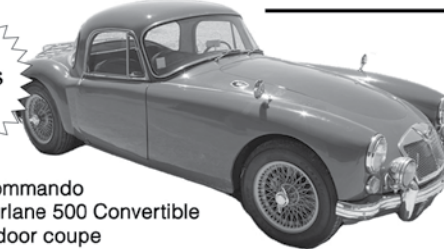
Full details and photos online!

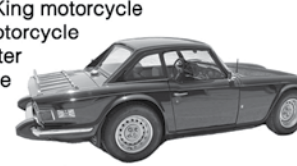
- 1973 Jeep Commando
- 1957 Ford Fairlane 500 Convertible
- 1960 MGA 2 door coupe
- 1974 Chevrolet Corvette Stingray coupe
- 1963 Ford Galaxie 500XL
- 1957 Ford Fairlane
- 1936 Nash custom sedan
- 1975 Triumph TR6
- 1935 Ford sedan
- 1928 Oldsmobile
- 1969 MG kit car
- 1974 Jeep DJ-5C Postal Carrier
- 1985 Dodge Ram Prospector pickup
- 1972 Porsche 914
- 1981 Chevrolet LUV pickup
- 1967 Chevrolet C10 pickup
- 1998 BMW 740IL
- 1988 BMW
- 1972 Opel GT project car
- 1996 Chevrolet Silverado 3500 dually pickup
- 1956 "Gottawoodie" boat
- 2002 Harley Davidson Road King motorcycle
- 2009 Ultima Street custom motorcycle
- 1988 Harley Davidson Sportster
- 1996 Suzuki LS650 motorcycle
- Hyosung Sunny scooter
- Sense scooter
- Motorcycle side car
- 1962 John Deere 4010 2wd tractor, diesel
- John Deere 260 front end loader
- 2002 PJ 518D car hauler trailer
- Allis Chalmers 5020 2wd tractor
- Massey Ferguson 5' finish mower
- Vermeer 605 Model Super G baler
- Pull type steel road grader

Can't make it to the auction?  
Internet bidding is available

Online Bidding **proxibid**

**DALE & LAVERNE OWENS**  
VEHICLE QUESTIONS CALL DALE: (660) 412-1556

**www.TeterAuction.com**

**TETER** TETER AUCTION COMPANY, LLC  
(660) 963-2461  
AUCTIONEERS:  
Josh Teter, David May, Tyler Keenan



## LOLLI LIVESTOCK MKT, INC.

**Special Calf & Yearling Sale**  
**Tuesday, August 30 - 11am**

160 hrs 650-700 (2 pots)	31 str/hfrs 500-700lbs
160 hrs 625-650 (2pots)	30 str/hfrs 500-700lbs
45 str/hfrs 400-600lbs	25 str/hfrs 600-700lbs
40 str/hfrs 400-500lbs	20 str 600-650lbs
37 str/hfrs 500-700lbs	8 str 500-600lbs

*This is only a partial listing, many more by sale date.*

Cafe Open **Lolli Livestock Market, Inc.** Cafe Open  
 704 Main st \* Macon, MO \* 660-385-2516 www.lollilivestock.com  
 Frankie 660-651-4040 \* Tim 660-651-3496 \* Joseph 660-346-9711  
 Jordan 660-346-0410 \* Cody 660-676-9392 Cattle accepted on Sundays

## Land Auction

**Thursday Sep 8th, 2022 at 5:00 p.m.**  
**Owner: Greenwood Farms**

**Directions:** Property is located approximately 3 miles West of Highway 151 and Shelby County Road 410, South of Clarence, Missouri. (the West property line begins on the corner of Ostrich and Mahogany, 0.5 miles from Highway V on Mahogany) Look for signs on the property. Auction to be held at Scotty's Auction Barn and Event Center.

**Directions to Auction Location:** 28251 US Highway 63 North, Macon, Missouri. From US Highway 36 travel approximately 2 miles North of Macon to Scotty's Auction Barn and Event Center on the West side of the road. Watch for signs the day of the sale.

**Real Estate:** We will be selling at auction 164.5 acres more or less, with 100 acres tillable, offering amazing hunting. The farms lays nice and will be sold as one tract. The acreage is currently planted in beans, with the tenant reserving the right to harvest the crop.

**DOWN PAYMENT:** 10% of the contract purchase price will be due upon acceptance of the Sales Contract. Personal or Cashier's Checks will be accepted. This is "AS IS, WHERE IS" and is non-refundable. **CLOSING:** Closing shall be within 30 days of the auction date.

SEE MORE PHOTOS ON SCOTTY'S WEBSITE

**SCOTTY'S AUCTION SERVICE**  
 573-356-4405

Michael Cunningham 660-651-2288 • Paxton Pittman 660-346-1956  
 WWW.SCOTTSAUCTIONSERVICE.COM

## VIRTUAL ONLINE LEWIS COUNTY, MISSOURI LAND AUCTION

**Wednesday, September 21, 2022 at 1:00 PM**



**357 ACRES± • 5 TRACTS (Subject to Survey)**

OPEN HOUSE: SAT., SEPT. 10 • 10:00 AM - 12:00 PM  
 19245 STATE HWY H • LEWISTOWN, MO 63452

- ✓ HIGHLY PRODUCTIVE TILLABLE CROPLAND!
- ✓ IMPROVED PASTURELAND & HAY PRODUCTION!
- ✓ COUNTRY HOME WITH BLACKTOP FRONTAGE!
- ✓ QUALITY FACILITIES & FENCING!
- ✓ PRIME RURAL BUILDING SITES!

Farm is located approximately 2.8 miles north of Lewistown, MO or approximately 7.8 miles northeast of LaBelle, MO in Section 31, T62N•R8W and Section 6, T61N•R8W in LaBelle Township, Lewis County, MO.

**DeVonna Larsen**

**Representing Attorney:** Tyler S. Phillips | Hawk & Owens  
 811 Main Street | Quincy, IL 62301 | (217) 214-2757

**Title Work:** Oak Hills Title Co.  
 307 Lewis Street | Canton, MO 63435 | (573) 288-4461

**Auction Managers:**  
 Bill Fretwell (660) 341-7735 & Jennifer Wood (217) 257-8812

**SULLIVAN AUCTIONEERS, LLC** (844) 847-2161  
 www.SullivanAuctioneers.com License #444000107

## Keen Kutter & Winchester Collectible Auction

**Tuesday, August 30, 2022 at 4:00 p.m.**  
**Owner: Pete Burmeister**

**Directions:** 28251 US Highway 63 North, Macon, Missouri. From US Highway 36 travel approximately 2 miles North of Macon to Scotty's Auction Barn and Event Center on the Westside of the road. Watch for signs the day of the sale.

This is going to be a large Keen Kutter and Winchester collector auction. This collection was started many years ago but as health issues have arisen, we will offer this amazing collection at auction.

Keen Kutter wood tool cabinet full of Keen Kutter tools, very hard to find; various Keen Kutter displays; Keen Kutter levels, Keen Kutter pipe wrenches, hatchets, hammers, hand planes, hand saws, sheep shears, meat grinders, padlocks, pocket knives, scissors, clocks, straight razors, flatware; Simmons hardware, flatware; Simmons tools; Keen Kutter long handled tools.

**Winchester:** flashlights; scales; clocks; rare Winchester fishing poles; padlocks; Winchester tools

Shapleigh items including antique order catalog; lantern; Keen Kutter toy gun; antique wood ammo boxes; bullet molds; antique ammo never opened; glass minnow trap; wood decoys; miscellaneous antiques and tools; metal tractor seats; tap and die sets; sockets and ratchets; 7? Milwaukee angle grinders; battery charger; horizontal air compressor; lots of miscellaneous gun books; modern and antique ammo, guns and hunting prints.

SEE MORE PHOTOS ON SCOTTY'S WEBSITE

**SCOTTY'S AUCTION SERVICE**  
 573-356-4405

Michael Cunningham 660-651-2288 • Paxton Pittman 660-346-1956  
 WWW.SCOTTSAUCTIONSERVICE.COM

## Absolute Land Auction of the KLC Farm

August 30th, Noon at the Caldwell Building



Farm is located approx. 1 mile north of Lewistown, Mo and consists of 830 acres (subject to survey) that will be sold in 11 tracts. Approx. 450 acres tillable, 145 acres pasture and the balance in timber Live auction to be held at 30200 Hwy 16 Canton, Mo.

**MEYER & COMPANY AUCTIONS**

Online bidding will be available on our website.  
 Meyerlistings.bidwangler.com

For more information call:  
**636-462-7777**

## HIGH QUALITY ANTIQUE FURNITURE AUCTION

**Saturday, August 27, 2022 at 10:00 a.m.**  
**Twisted W Arena**  
**7180 Quarter Horse Lane, Hannibal, Missouri**



**SELLERS: RONNIE AND MIKE WEAR**  
 More pictures and information at:  
 www.hammondwatsonauctionservice.com

**Hammond & Watson AUCTION SERVICE**  
 Lionel Hammond & Kirk Watson  
 573-406-3877  
 PALMYRA MO

## Randolph County REAL ESTATE & PERSONAL PROPERTY AUCTION

**• SATURDAY, SEPT. 17, 2022 AT 10 AM •**

**Auction & Property Location:**  
**1488 County Road 1825 at Cairo, MO 65239**

**Directions:** From Moberly, MO take Hwy. 63 north 6 miles to Highway K (Cairo, MO), turn right on Hwy. K and go 3 miles east to Hwy. CC, turn left and go north 1/2 mile to Hwy. FF, turn right and go east 2 miles to Randolph County Road 1825, turn right in the curve and go 1/2 mile east to the Green property on the right.

**THE REAL ESTATE IS LOCATED IN TOWNSHIP 55N, RANGE 13W, SECTION 26 OF RANDOLPH COUNTY MO. THE PROPERTY CONSISTS OF 122.90 TOTAL SURVEYED ACRES TO BE OFFERED IN TWO TRACTS, RANGING FROM TRACT ONE OF 20 +/- ACRES WITH A BEAUTIFUL RANCH STYLE LATE MODEL HOME WITH 6,000 SQ. FT. OF LIVING SPACE, A SHED/WORKSHOP BUILDING AND A 3+ ACRE WELL-STOCKED LAKE AND TRACT TWO IS 100 +/- ACRES OF CRP, WOODS, OPEN GRASS FIELDS AND A CREEK.**



**PRE-AUCTION PROPERTY VIEWING**  
**Saturday, September 3 from 2 PM to 4 PM**

**PERSONAL PROPERTY INCLUDES:**  
 2012 JOHN DEERE 5093E TRACTOR, 2011 JOHN DEERE 329D SKID STEER, SHOP EQUIPMENT & TOOLS, FARM EQUIPMENT, MOWER & MISC., TRAILERS, DEER STAND & DOG PEN



Visit [wheelerauctions.com](http://wheelerauctions.com) for more information!

**SELLER: JANE A. GREEN TRUST**

**Wheeler AUCTIONS & REAL ESTATE**  
 For more information call Charlie Nordwald at 636-795-4552 or visit [wheelerauctions.com](http://wheelerauctions.com).

## VIRTUAL ONLINE ADAIR COUNTY, MISSOURI LAND AUCTION

**Wednesday, September 21, 2022 at 10:00 AM**



**358 ACRES± • 5 TRACTS (Subject to Survey)**

- ✓ PRODUCTIVE CROPLAND!
- ✓ IMPROVED PASTURELAND/HAY PRODUCTION!
- ✓ PRIME RURAL BUILDING SITES!
- ✓ EXCELLENT HUNTING/RECREATIONAL ACREAGE!

The farm is located approximately 4 miles northeast of Kirksville, MO and approximately 8.7 mi southeast of Greentop, MO in Sections 14 & 23, T63N•R15W, Benton Township, Adair County, MO.

**Charles C. Alexander & Judy K. Alexander**

**Representing Attorney:** David Rouner | Rouner Law Office LLC  
 400 N. Franklin Street | Kirksville, MO 63501 | (660) 665-7515

**Title Work:** Pickell Abstract Company  
 115 S. Franklin | Kirksville, MO 63501 | (660) 665-8324

**Auction Managers:**  
 Bill Fretwell (660) 341-7735 & Jennifer Wood (217) 257-8812

**SULLIVAN AUCTIONEERS, LLC** (844) 847-2161  
 www.SullivanAuctioneers.com License #444000107

## Randolph County REAL ESTATE & PERSONAL PROPERTY AUCTION

**• SATURDAY, SEPT. 17, 2022 AT 10 AM •**

**Auction & Property Location:**  
**1488 County Road 1825 at Cairo, MO 65239**

**Directions:** From Moberly, MO take Hwy. 63 north 6 miles to Highway K (Cairo, MO), turn right on Hwy. K and go 3 miles east to Hwy. CC, turn left and go north 1/2 mile to Hwy. FF, turn right and go east 2 miles to Randolph County Road 1825, turn right in the curve and go 1/2 mile east to the Green property on the right.

**THE REAL ESTATE IS LOCATED IN TOWNSHIP 55N, RANGE 13W, SECTION 26 OF RANDOLPH COUNTY MO. THE PROPERTY CONSISTS OF 122.90 TOTAL SURVEYED ACRES TO BE OFFERED IN TWO TRACTS, RANGING FROM TRACT ONE OF 20 +/- ACRES WITH A BEAUTIFUL RANCH STYLE LATE MODEL HOME WITH 6,000 SQ. FT. OF LIVING SPACE, A SHED/WORKSHOP BUILDING AND A 3+ ACRE WELL-STOCKED LAKE AND TRACT TWO IS 100 +/- ACRES OF CRP, WOODS, OPEN GRASS FIELDS AND A CREEK.**



**PERSONAL PROPERTY INCLUDES:**  
 2012 JOHN DEERE 5093E TRACTOR, 2011 JOHN DEERE 329D SKID STEER, SHOP EQUIPMENT & TOOLS, FARM EQUIPMENT, MOWER & MISC., TRAILERS, DEER STAND & DOG PEN



Visit [wheelerauctions.com](http://wheelerauctions.com) for more information!

**SELLER: JANE A. GREEN TRUST**

**Wheeler AUCTIONS & REAL ESTATE**  
 For more information call Charlie Nordwald at 636-795-4552 or visit [wheelerauctions.com](http://wheelerauctions.com).

## Excello Real Estate & Personal Property Auction

**Thursday, September 15, 2022 at 5:00 p.m.**  
**Estate of Randy Boulware**

**Directions:** 38144 Owatonna Street, Excello, Missouri. From US Highway 63, turn East on State Highway Y for approximately 7.6 miles, turn left on Owatonna Street. The property will be on your left. Please look for signs the day of the sale.

**Real Estate:** 28251 US Highway 63 North, Macon, Missouri. From US Highway 36 travel approximately 2 miles North of Macon to Scotty's Auction Barn and Event Center on the West side of the road. Watch for signs the day of the sale.

**Real Estate:** We will be selling at auction 0.74 acres m/l with a 12' x 52' mobile home and a 25' x 32' metal building with electricity and concrete floor. See Real Estate Terms and Conditions below.

**The real estate will sell promptly at 6:00 p.m.** Please contact Scotty at 573-356-4405 to set up your personal showing.

**DOWN PAYMENT:** 10% of the contract purchase price will be due upon acceptance of the Sales Contract. Personal or Cashier's Checks will be accepted. This is "AS IS, WHERE IS" and is non-refundable. **CLOSING:** Closing shall be within 30 days of the auction date.

**Building:** 8' x 8' cabin/storage building to be sold after real estate sells Farm Equipment: 2015 Kubota L4060, four wheel drive tractor, L805 loader with 279 hours, like new, very nice tractor; Caterpillar 303 CR mine EX, 1500 hours, needs cylinder rebuilt; 20' Low Pro gooseneck trailer; 3 point long wood hydraulic wood splitter; 3 point 5? Agri Fab brushhog; 48? quick attach pallet forks; quick attach grapple; mini ex grapple; 3 point 4? box blade; 3 point 2 bottom plow; Land Pride 747 3 point tiller; school bus storage container; 3 point 6? blade

**Vehicles and trailers:** 2001 Chevy Duramax 2500 HD, single cab 4x4 pickup with 195,647 miles; 1998 Chevy S-10 pickup, 2 wheel drive, 5 speed, 113,000 miles; 12? bumper hitch trailer with ramps

**Tools and Outdoor Equipment:** Grasshopper 721 60? front deck, zero turn mower; Campbell Hausfeld 6HP 60 gallon upright air compressor; shop on stand; Woods front mount lawnmower, needs work; MS490 Stihl chainsaw; MS290 chainsaw; MS460 chainsaw; HT 131 Stihl pole saw; miscellaneous long handled tools; appliance dolly; K&F floor model drill press; Hoover garage utility vacuum; miscellaneous lumber

**Household Items and Collectible:** Big Bite new meat grinder; 330 pound digital scale; Fender Stratocaster made in Mexico MNS55439; Lespaul 14091510787 electric guitar; Behringer 300 watt amp; 2 Marshall speakers; Bose wave radio

SEE MORE PHOTOS ON SCOTTY'S WEBSITE

**SCOTTY'S AUCTION SERVICE**  
 573-356-4405

Michael Cunningham 660-651-2288 • Paxton Pittman 660-346-1956  
 WWW.SCOTTSAUCTIONSERVICE.COM



**BID NOW @ IMAUCTION.COM**

**MAUPIN TRUCKING  
ONLINE AUCTION**

IMAN AUCTION CENTER | 34614 HWY 24 - SALISBURY, MO

**FIRST LOT CLOSES SUNDAY, AUGUST 28, 2022 @ 7 PM**

Maupin Trucking, LLC has decided to liquidate their over the road trucking operation. With passing of Raymond Maupin in December of 2020, Josh and Linda Maupin will sell their Semis, Cattle and Semi Trailers, as well as Trucking Supplies and Tools at Online Auction.



IMAN AUCTION COMPANY | 660-388-6235 | ImanAuction.com

**PUBLIC AUCTION**

We will sell the following items for the La Plata R-II School District located at the La Plata Elementary parking lot at 402 West Moore Street, La Plata, MO on

**WED. EVE., AUGUST 31ST, 2022 @ 5:30 P.M.**

**SURPLUS ITEMS:** 142 plastic back chairs of various sizes and colors (some have rollers) - wooden cube organizer - wooden shelves - portable dishwasher - folding lunch table on wheels - 18 medium center pocket student desks - 30 medium plastic & wooden top side pocket student desks - 8 adult office/lounge chairs - large rectangle wooden & plastic top tables (some are adjustable) - various sizes of trapezoid tables - 2 teacher computer desks - metal cart on wheels - 5 student desks - display racks - portable white board on cart w/wheels - grey stools - various sizes of Rubbermaid trash cans (some w/wheels) - 4 drawer filing cabinets - mail box on pole - 19 large wooden top rectangle tables - 35 large red cushioned rolling computer chairs (some have water stains) - 9 new small/medium center pocket plastic top student desks - 4 new medium wooden top side pocket student desks - 14 new small red plastic back student chairs - View Lex V25 projector - metal office desk - office desk w/hutch - small Magic Chef refrigerator - stainless steel medical cabinet - 8 original chalkboards from 1988 - three benches that seat 3 - blue recliner - full size bed w/frame - 2 metal carts w/baskets - odd & end plastic and wooden chairs - Emerson microwave - various other items too numerous to mention.

**AUCTIONEER'S NOTE:** Please plan to attend this auction with a variety of items. **TERMS:** Cash/Check w/ID - Lunch on Grounds

**OWNERS: LA PLATA R-II SCHOOL DISTRICT**

**Christy's Auction Service**

La Plata, MO 63549 660-341-4531  
See Website for Photos: [www.dchristyauctions.com](http://www.dchristyauctions.com)  
& Christy's Auction Service on Facebook & AuctionZip.com  
Auctioneers - David Christy 660-341-4531  
Jason Wood - 660-341-7884 Greg Smoot - 660-341-5175

**There's a better way to get noticed.**

Keep life simple. Take out an ad.

**LET us HELP you SELL your ITEMS!**

PLACE A CLASSIFIED IN THE **Nemo Trader** TODAY!

**NEMO Trader Classified COUPON**

**2 Classified Ads for \$5.00**

20 cents per word over 20 words

For an additional \$1.00 run in the Kirksville Daily Express one time.

For an additional \$2.00 run in the Saturday Kirksville Daily Express and Kirksville Crier one time each.

Must be Mailed in or brought in along with payment

*Picture Ads Not Included with Coupon!*

**Choose Classification**

- Agri-Business
- Announcements
- Employment
- Financial
- Merchandise
- Real Estate
- Rentals
- Real Estate Sales
- Recreation
- Services
- Transportation
- Yard Sales
- Auctions & Estate Sales

**Ad No. 1 Each Box Represents a Word (20 words or less)**

**Ad No. 2 Each Box Represents a Word (20 words or less)**

Name \_\_\_\_\_

Mailing Address \_\_\_\_\_

Phone Number \* \_\_\_\_\_  
this is required\*

**PO Box 809 Kirksville, MO 63501 • 660-665-8500**







# Clark County, MO LAND AUCTION

**THURSDAY, SEPTEMBER 8<sup>TH</sup> - 6 PM**  
Sale conducted at the VFW located at 123 W. Monroe St, Memphis, MO

## 217+/- ACRES/ 4 TRACTS

(SUBJECT TO FINAL SURVEY)

### GENERAL INFORMATION

The Jones tracts of land are located on the Scotland County and Clark County line lying along Hwy. 136. Tracts offer 120.8 +/- acres of open tillable cropland, 20 +/- acres of pasture / hay, balance in wooded areas for hunting, 2 bedroom home and outbuildings. The Jones property is located in the Scotland County School District. Physical address 10272 Hwy. 136 Arbela, MO. Lying in Sect. 7 and 18, Twp. 65N, R9W Clark County MO.

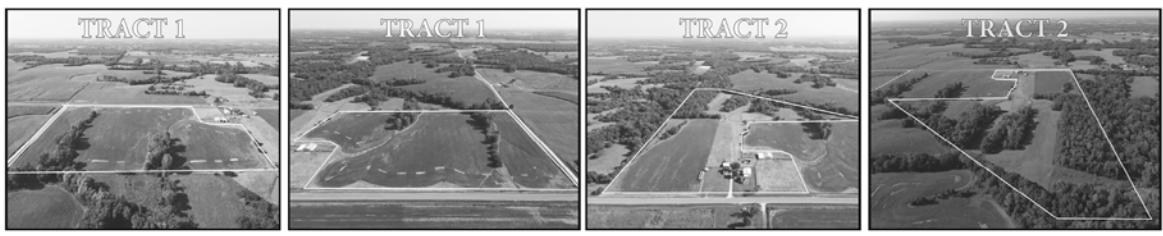

### TRACT 1: 22+/- ACRES

- Offers 21.4 +/- acres of tillable cropland
- Access: Hwy. 136 frontage, Clark Rd. running along the West side.
- Predominant soil types: Armstrong, Edina

### TRACT 2: 37+/- ACRES

- Offers 20.3 +/- acres of open land currently (7 +/- acres n alfalfa), pond, wooded areas
- Access Hwy. 136 frontage.
- Improved by a 1088 sq' 2 bedroom home, attached 2 car garage and other outbuildings.



### TRACT 3: 95+/- ACRES

- Offers 63.1 +/- acres of tillable cropland, balance in recreational / hunting woods.
- Access: Clark Rd. running along the West side.
- Soil types: Armstrong, Edina, Vesser and Lindley.

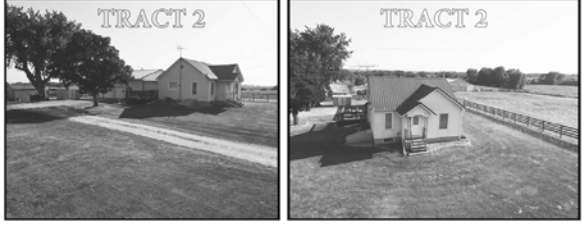

### TRACT 4: 63+/- ACRES

- Offers 36.3 +/- acres of tillable cropland, balance in recreational/hunting woods.
- Access: Clark Rd. running along the West and South sides.
- Soil types: Armstrong, Edina, Vesser and Lindley.
- 20x750' easement granted to Aaron Small dated July 17, 2019 for a period of ten (10) years.



**OPEN HOUSE:**  
SAT, AUG 27<sup>TH</sup> 10AM - NOON

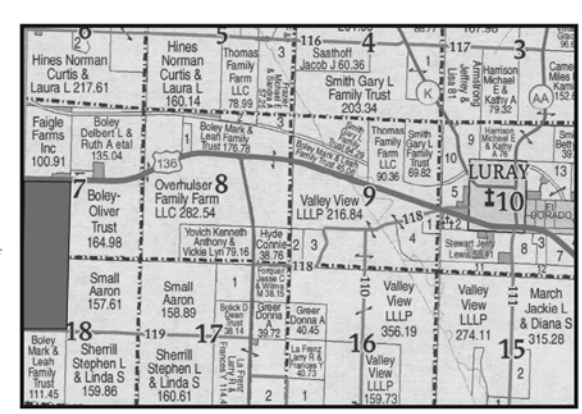

### TIMED ONLINE ONLY PERSONAL PROPERTY ESTATE AUCTION

LOTS START ENDING  
THURS SEPTEMBER 8<sup>TH</sup> AT 10 AM



**COMPLETE DETAILS ONLINE!**  
PREVIEW: SAT, AUG 27<sup>TH</sup> 10AM - NOON

### TERMS & CONDITIONS

Tracts will be sold on a price per acre basis, based on final surveyed acreage. Tracts will be offered through the method of "Buyer's Choice", giving the successful bidder the opportunity to take any single tract, any combination or all four tracts in its entirety. This method will be used until all tracts are sold. Tracts DO NOT sell contingent to financing or any other buyer contingencies. Immediately following the bidding, the successful buyer(s) will be required to pay 10% down evening of sale payable to Oak Hill Title Company Escrow and sign into a written contract with the seller. The balance of the purchase price will be due at closing on or before October 4, 2022. Tracts 1, 3 and 4 sell subject to row crop tenant (Troy Alexander) for 2022 crop season, possession after full harvest. All tracts sell subject to hunting lease (Dyson Bertelli) until April 1, 2023. Tract 2 sells subject to pasture tenant (Shane Gregory) until October 31, 2022. All lease income will be retained by the sellers. Possession will be given on the home at closing. Real estate conveyed subject to any assessments of record in effect at date of closing. The 2022 real estate taxes will be prorated at closing. A sellers policy of title insurance in the full amount of the purchase price will be provided by seller. All additional closing cost will be divided in equal shares between the buyer(s) and seller. Closing conducted by Oak Hill Title Company located at 309 Lewis Street Canton, MO. All lines on maps are for identification purposes only, these lines may or may not be accurate. A boundary survey will be completed prior to sale. Sale contracts, title work and survey will be available day of sale for review.

AUCTIONEER'S NOTE: Prospective buyers are welcome to view the land at their own leisure. A public open house will be held on the home and structures on Saturday August 27th. Not responsible in case of accident. Terms cash or check with proper ID. Announcements made sale day take precedence over any advertisement. The above information is believed to be accurate; however, no liability for its accuracy, errors or omissions are assumed by the seller or auction service.

## THE FAMILY OF TERRY JONES

Oak Hill Title Company, Closing Agent

**McAfee Auction Service, LLC**  
660-727-3796  
www.mcafeeauctionservice.com

**McAfee Auction Service, LLC**  
375 S Johnson • Kahoka, MO  
660-727-3796  
www.mcafeeauctionservice.com

### MARION CO, MO RESIDENTIAL REAL ESTATE AND PERSONAL PROPERTY AUCTION

**SATURDAY OCTOBER 1<sup>ST</sup> - 10 AM**

Sale conducted onsite located at 3930 County Road 329, Palmyra



**TRACT 1:**  
2344 sq' 3 bedroom, 3 1/2 bath brick ranch built in 1999. Other improvements include a 24 x 36' shop building.

**TRACT 2:** Corner lot located at 709 N Spring Street, Palmyra, MO. (Single wide mobile home does not convey) Improvements include mobile home hook up and single car garage.



Also selling a nice selection of personal property to include a 2001 Forest River 5th wheel camper, 2001 24' Party Bandit pontoon, lawn equipment,



carport, tools, guns, clocks, collectibles, household furniture, appliances and various common household items.

**COMPLETE DETAILS ONLINE!**  
**THE FAMILY OF BILL AND ELSIE EAGAN, SELLERS**  
CASEY J. WELCH REP. ATTN.

**McAfee Auction Service, LLC**  
375 S Johnson • Kahoka, MO  
660-727-3796  
www.mcafeeauctionservice.com

### Clark County, MO LAND AUCTION

Sale conducted at the CARE Building  
located at 451 N. Vine Street, Kahoka, MO  
**21 +/- ACRES/ 1 TRACT**  
Lying in Sect. 23, Twp 66N, R8W Clark County, MO

- Excellent Building Site
- Established Utilities
- Shop Building
- Hunting

**Thursday,  
September  
1<sup>ST</sup>  
at 6 PM**

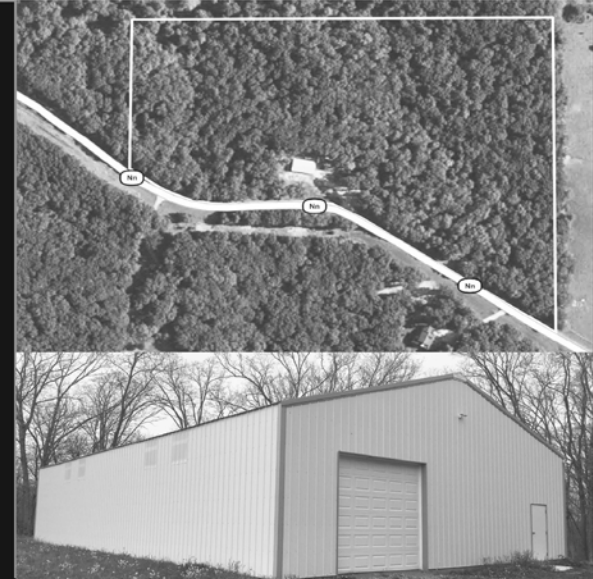

**DAN LAGE ESTATE**