



Fort Pierce Utilities Authority  
Water Reclamation  
403 Seaway Drive (PO Box 3191)  
Fort Pierce, FL 34949 (34948)

October 21, 2022

This permit is issued by Fort Pierce Utilities Authority (FPUA) under the provisions of Chapter 403.087, Florida Statutes (F.S.) Florida Administrative Code (F.A.C.) Rules 62-4, 62-520, 62-522, 62-528, 62-550 and 62-660.

PERMITTEE:	FACILITY:
Allied New Technologies, Inc.	Allied New Technologies, Inc.
3901 NW 115 Avenue	9545 Range Line Road
Miami, FL 33178	Fort Pierce, FL 34987

INJECTION WELL USE PERMIT NO: ALLIED 171331-002-UO

The Permittee named is hereby authorized to deliver hauled industrial brine reject solution from the commercial manufacture of sodium hypochlorite to FPUA Gahn Water Treatment Plant brine reject receiving facility located at 715 South 25<sup>th</sup> Street for onsite storage and subsequent disposal into Industrial Injection Well, IW-1, in accordance with the conditions set forth in this permit. Compliance with this permit does not relieve the Permittee of the obligation to comply with any or all applicable regulations, standards, or requirements under local, state and federal laws, including any such regulations, standards, requirements, or laws that may become, effective during the term of this permit. Noncompliance with any term or condition of this permit may result in the Permittee being issued a cease delivery order until the condition of noncompliance is resolved.

This permit shall become effective on, November 9, 2022, and shall remain in force for a period of one year expiring November 8, 2023.

The Permittee shall provide FPUA written notification of the intent to renew this permit ninety (90) calendar days prior to expiration of the permit (August 12, 2023).

A handwritten signature in blue ink, appearing to read 'Bowdoin G Hutchinson', is written over a horizontal line.

Bowdoin G Hutchinson, P.E.,  
DIRECTOR W/WW SYSTEMS

**Part 1 General Conditions:**

- 1) The terms, conditions, requirements, limitations and restrictions set forth in this permit are "permit conditions" and are binding and enforceable pursuant to Section 403.141, F.S.
- 2) This permit is valid only for the delivery, onsite storage and subsequent disposal of the specific process waste stream applied for and indicated in the approved drawings, documents or exhibits. Any unauthorized deviation from the approved drawings, exhibits, specifications, or conditions of this permit may constitute grounds for revocation and enforcement action against the Permittee.
- 3) This permit does not relieve the Permittee from liability for harm to human health or welfare, animal, or plant life, or property caused by the construction or operation of this permitted source, or from resulting penalties, nor does it allow the Permittee to cause pollution in contravention of Florida Statutes.
- 4) The Permittee shall properly deliver and discharge the brine reject to the disposal facility. This provision also includes the implementation of spill control and countermeasure plans sufficient to prevent the introduction of other contaminants that could alter the chemical characteristics of brine reject.
- 5) The Permittee, by accepting this permit, specifically agrees to allow authorized FPUA personnel, upon presentation of credentials or other documents as may be required by law and at reasonable times, access to the premises where the permitted brine reject is generated to:
  - a) Have access to, audit and copy any records that must be kept under the conditions of this permit;
  - b) Inspect the facility, equipment, practices, chemical inventories and storage areas or operations regulated or required under this permit;  
and
  - c) Sample or monitor any substances or parameters at any location reasonably necessary to assure compliance with this permit.
- 6) In accepting this permit, the Permittee understands and agrees that all records, notes, monitoring data and other information relating to the operation of this permitted source submitted may be used as evidence in any enforcement case involving the permitted source.
- 7) This permit or a copy thereof shall be kept at the AT plant site which is the source of the brine reject.
- 8) Any permit noncompliance may be grounds for enforcement action; for permit termination, revocation and reissuance, or modification; or for denial of permit renewal.
- 9) It shall not be a defense for the Permittee, in an enforcement action, that it would have been necessary to halt or reduce the permitted activity in order to maintain compliance with the conditions of this permit.

- 10) The Permittee shall take all reasonable steps to minimize or correct any adverse impact on the environment resulting from noncompliance with this permit.
- 11) The Permittee shall retain all records of all monitoring information concerning the nature and composition of injected fluid for the most recent 24 month period.
- 12) The Permittee shall give 90-days advance notice to FPUA of any planned changes in the permitted facility which may result in noncompliance with permit requirements.
- 13) The Permittee shall report any noncompliance which may endanger health or the environment
- 14) FPUA maintains the right to reopen this permit for revision due to the development or discovery of conditions or information that warrants a change or changes in permit conditions. FPUA will, in such case, provide the Permittee thirty (30) calendar days written notice of the intent to revise stating the proposed change and reason for the change.

## **Part 2 Brine Delivery Requirements**

- 1) **Authorized Deliveries and Discharges**  
Starting, November 9, 2022, the Permittee is authorized to deliver up to twenty one thousand six hundred (21,600) gallons per day of hauled industrial brine reject solution produced as a waste product from the commercial manufacture of sodium hypochlorite to the FPUA Gahn Water Treatment Plant brine reject disposal facility for onsite storage and subsequent injection into Well, IW-1.
- 2) **Restrictions**
  - a) Brine reject solution delivered to FPUA for onsite storage and disposal into injection Well, IW-1 shall be restricted to consist exclusively of non-hazardous waste solution at all times as defined in 40 CFR, Part 261 and as adopted in 62-630 F.A.C.
  - b) Brine reject solution deliveries will be accepted into the FPUA brine reject disposal facility during daylight hours only.
  - c) Each load of brine reject solution delivered to FPUA for onsite storage and disposal into injection Well, IW-1 shall be accompanied by a waste manifest. Each waste manifest shall contain the information contained under Appendix A of this permit.
  - d) The Permittee shall test the pH of the brine reject prior to discharge to the onsite storage tanks/system to ensure that the pH of the brine reject solution delivered (each delivery) is within the pH acceptance range, 5.0 to 10.0 S.U. the test results shall be noted on the manifest.

- e) At no time will FPUA allow a delivery of brine reject solution to be discharged to the onsite storage tanks/system for onsite storage and disposal into injection Well, IW-1 that is outside of the pH acceptance range, 5.0 to 10.0 S.U.
- f) The Permittee shall take the necessary steps to prevent cross contamination of brine reject facility piping, storage tanks/system and the FPUA injection Well, IW-1 by providing one (1) or more tankers to be used for the sole purpose of transporting and delivering brine reject solution to FPUA for disposal into injection Well, IW-1 or non-recoverable effluent for disposal to the FPUA Sanitary sewer system under a separate permit.
- g) At no time will the Permittee allow a Tanker used for the transport and delivery of brine reject solution to FPUA for disposal into injection Well, IW-1 to be used to hold or haul any other type of waste, material or solution except for non-recoverable effluent which is delivered to an alternate site for disposal to the FPUA Sanitary sewer system..
- h) Discharges to injection Well, IW-1 are restricted under the operating conditions and based upon the design and current configuration of injection Well, IW-1 as approved and permitted by the Florida Department of Environmental Protection (FDEP) and shall not exceed the minimum or maximum allowable discharge limits in Table 1.

Table 1 Brine Reject Limits	
Water Quality Indicator or Property:	Allowable Discharge Limits:
Maximum Daily Delivery and Disposal Volume	21,600gpd
Maximum Temperature	99.0°F
Allowable pH Range	Not Less than 5.0 or Higher than 10.0 S.U.

3) Prohibited Discharges

At no time may the Permittee deliver to the brine reject disposal facility for discharge into injection Well, IW-1 wastes that present any of the following characteristics:

- a) Pollutants which create a fire or explosion hazard
- b) Pollutants delivered by the Permittee, which alone or in combination with other pollutants or wastes have a deleterious effect on any part of injection Well, IW-1 associated monitoring equipment or other appurtenances
- c) Pollutants which cause corrosive damage to any part of injection Well, IW-1, associated monitoring equipment or other appurtenances. In no case may pollutants be introduced to injection Well, IW-1 having a pH level lower than 5.0 S.U. or higher than 10.0 S.U.

- d) Solid or viscous pollutants which have the potential to clog or obstruct injection Well, IW-1
- e) Pollutants having a temperature measured at the head of injection Well, IW-1 that compromises the structural integrity of injection Well, IW-1, or, that interferes with associated monitoring equipment or other appurtenances. In no case may waste solutions be discharged to injection Well, IW-1 that present temperatures higher than 99.0 degrees F
- f) Petroleum oil, non-biodegradable cutting oil, or products of mineral oil origin
- g) There shall be no discharge of polychlorinated biphenyl compounds such as those used for transformer fluid
- h) The Permittee shall make no delivery of brine reject solution which causes FPUA to violate any water quality standard, or, injection Well, IW-1 permit condition.

**Part 3 Monitoring and Reporting Requirements**

- 1) Offsite Brine Reject Stream Monitoring
  - a) Pre-Permit Baseline Monitoring

The Permittee shall provide FPUA with the results of analytical testing of brine reject solution for Primary and Secondary Drinking Water Standards annually as provided in Table 2. *(A list of Primary and Secondary Drinking Water Standards is contained in Appendix F.)*

Table 2 Self-Monitoring Periods with Report Due Dates		
Monitoring Periods:		Report Due Dates
1	Annually August or September	October 1 <sup>st</sup>

- b) Description of Monitoring Point

Sampling point is from the tankers that haul the brine reject solution to FPUA. Sampling is to be performed annually by Permittee’s contract laboratory. Report is to include all field documentation from contract laboratory field personal.

## 2) Monitoring and Reporting General Requirements

## a) Representative Samples

All samples shall be representative of the actual conditions and or chemical character of the brine reject solution delivered to FPUA for disposal.

## b) Record Contents

- 1) The Permittee shall provide to FPUA all documentation required to demonstrate compliance with the limits, requirements and restrictions delineated in this permit.
- 2) All samples collected and analyzed as required in this permit shall be representative of the brine reject solution being delivered for disposal, to the FPUA Gahn Water Treatment Plant brine reject solution disposal facility for injection into Well, IW-1.

## c) Records of sampling and analysis shall include:

- 1) The date, exact place, time, methods of sampling or measurements, sample preservation techniques or procedures, Chain-of-Custody documentation for samples required by permit.
- 2) The person performing the sampling or measurement.
- 3) The date(s) analyses were performed.
- 4) The analytical techniques or methods used.
- e) The results of such analysis.

## 3) Noncompliance with a Permit Condition

- a) If, for any reason, the Permittee does not comply with or will be unable to comply with any condition or limitation specified in this permit, the Permittee shall immediately provide FPUA with the following information:
  - 1) A description of and cause of noncompliance; and
  - 2) The period of noncompliance, including dates and times; or, if not corrected the anticipated time the noncompliance is expected to continue, and steps being taken to reduce, eliminate, and prevent the recurrence of the noncompliance. The Permittee shall be responsible for any and all damages

which may result and may be subject to enforcement action by FPUA for penalties or for revocation of this permit.

- b) The Permittee shall be responsible for any and all damages which may result from any condition of noncompliance with this permit and may be subject to enforcement action by FPUA and other regulatory agencies for penalties or for revocation of this permit.
- 4) Signatory Requirements
- a) All reports and other submittals required to comply with this permit shall be signed by a person authorized under Rules 62-528.340(1) or (2), F.A.C. All reports shall contain the certification required in Rule 62-528.340(4), F.A.C.
  - b) In accordance with Rule 62-528.340(4), F.A.C., all reports shall contain the following certification:  
"I certify under penalty of law that this document and all attachments were prepared under my direction or supervision in accordance with a system designed to assure that qualified personnel properly gather and evaluate the information submitted. Based on my inquiry of the person or persons who manage the system, or those persons directly responsible for gathering the information, the information submitted is, to the best of my knowledge and belief, true, accurate, and complete. I am aware that there are significant penalties for submitting false information, including the possibility of fine and imprisonment for knowing violations."
- 5) Report Submittal  
Reports or other information required by this permit shall be delivered to:

Samantha Rowland, Pretreatment Supervisor  
Fort Pierce Utilities Authority  
403 Seaway Drive  
Fort Pierce, FL 34949  
Phone, (772) 466-1600, ext. 5526  
Fax, (772) 589-5907  
E Mail, [srowland@fpua.com](mailto:srowland@fpua.com)

**Part 4 Injection Well, IW-1 Integrity**

## 1) Quarterly Injectivity Testing

Quarterly Injectivity testing shall be performed by FPUA in accordance with Rule 62-528.430(2) (d), F.A.C.

## 2) Mechanical Integrity

- a) Rule 62-528 FAC requires injection wells to undergo periodic mechanical integrity testing to demonstrate the mechanical integrity of the well. Mechanical Integrity Tests (MIT) require periods of zero well use. The next mechanical integrity test of injection Well, IW-1 is scheduled to take place in 2027. During this period the Permittee may need to make alternate storage or disposal arrangements.
- b) If at any time during the operation of injection Well, IW-1, the FDEP determines that the injection well lacks mechanical integrity, written notice shall be given by FDEP to FPUA and subsequently to the Permittee. Within 48 hours of receiving written notice that the injection well lacks mechanical integrity, unless the FDEP requires immediate cessation of injection, the Permittee shall cease injection into injection Well, IW-1 unless the FDEP allows continued injection as follows: It shall be permissible to continue the operation of injection Well, IW-1 although it lacks mechanical integrity if a satisfactory demonstration can be made to the FDEP that fluid movement into or between underground source of drinking water is not occurring.

**Part 5 Emergency Disposal**

Alternate disposal is the sole responsibility of the Permittee. FPUA shall have no financial responsibility and shall bear no obligation to provide alternate disposal for brine reject solution.



Check Report Period			
<input type="checkbox"/> -Nov 2022	<input type="checkbox"/> -Dec 2022	<input type="checkbox"/> -Jan 2023	<input type="checkbox"/> -Feb 2023
<input type="checkbox"/> -Mar 2023	<input type="checkbox"/> -Apr 2023	<input type="checkbox"/> -May 2023	<input type="checkbox"/> -June 2023
<input type="checkbox"/> -July 2023	<input type="checkbox"/> -Aug 2023	<input type="checkbox"/> -Sep 2023	<input type="checkbox"/> -Oct 2023

Report submittal checklist. This report includes:

- Appendix A. Self-Monitoring Report Cover Sheet
- Appendix B. Self-Monitoring Report Results Form
- Appendix C. Discharge Volume Report Form  
(Done at Gahn WTP)
- Appendix D. Daily pH & temperature Report Form
- Appendix E. Instrument Calibration Form
- Hauled Wastes Receipts and Waste Manifests
- Copies of Email Correspondence

Reminders:

- A. The Permittee must notify FPUA of intent to renew permit no later than, August 12, 2023.

FPUA Use						
Report Submittal Compliance Review			Sample Collection and Preservation:			
Due Date:	Date Received:		Proper Sample Collection Procedures?	<input type="checkbox"/> -Yes	<input type="checkbox"/> -No	<input type="checkbox"/> -N/A
Is Report Complete?	<input type="checkbox"/> -Yes	<input type="checkbox"/> -No	Preserved Properly?	<input type="checkbox"/> -Yes	<input type="checkbox"/> -No	<input type="checkbox"/> -N/A
Is Report On-time?	<input type="checkbox"/> -Yes	<input type="checkbox"/> -No	Data Qualifiers?	<input type="checkbox"/> -Yes	<input type="checkbox"/> -No	<input type="checkbox"/> -N/A
If not on-time is report >30 days late?	<input type="checkbox"/> -Yes	<input type="checkbox"/> -No	Effluent Compliance Review			
Does report meet 62-625.600(11) FAC Signature Requirements?	<input type="checkbox"/> -Yes	<input type="checkbox"/> -No	Were all pollutants monitored?	<input type="checkbox"/> -Yes	<input type="checkbox"/> -No	<input type="checkbox"/> -N/A
			Results Compliant?	<input type="checkbox"/> -Yes	<input type="checkbox"/> -No	<input type="checkbox"/> -N/A
			Enforcement Required?	<input type="checkbox"/> -Yes	<input type="checkbox"/> -No	
			Do Surcharges Apply?	<input type="checkbox"/> -Yes	<input type="checkbox"/> -No	
Reviewed By:			Date: _____			

Reporting Month:				Compliant?	
Pollutant:	Permit Limit:	Date	Results	Yes	No
pH	5.0 – 10.0 S.U.			<input type="checkbox"/>	<input type="checkbox"/>
temperature	0 – 99.0 F			<input type="checkbox"/>	<input type="checkbox"/>

**Instructions for completing Self-Monitoring Report Results Form:**

1. Enter reporting Month.
2. Enter under Results column, each pH and temperature result and date for results that are **not** within permit limits from each Appendix D – Daily pH & Temperature Report Form. If there are no entries under the results column, enter none.
3. If you have entered none under the Results column, check the Yes box under Compliant and No box below.
4. If you have entered any results other than none under the Results column, check the No box under Compliant and the Yes box below and then contact FPUA Pretreatment within 24 hours of becoming aware of the violation.

<input type="checkbox"/> -NO	Follow normal reporting procedure	<input type="checkbox"/> -YES	Notify FPUA within 24-hours
------------------------------	-----------------------------------	-------------------------------	-----------------------------

**Certification Statement:**

I certify under penalty of law that this document and all attachments were prepared under my direction or supervision in accordance with a system designed to assure that qualified personnel properly gather and evaluate the information submitted. Based on my inquiry of the person or persons who manage the system, or those persons directly responsible for gathering the information, the information submitted is to the best of my knowledge and belief, true, accurate, and complete. I am aware that there are significant penalties for submitting false information, including the possibility of fine and imprisonment for knowing violations. I affirm that the collection, preservation and sample analysis were performed in strict accordance with the State of Florida, Department of Environmental Protection Standard Operating Procedures for Laboratory Operations and Sample Collection Activities, DEP-SOP-001/01.

Only a responsible corporate officer or duly authorized individual or position may sign this report under the provisions of Chapter 62.625.600(11) FAC.

Permittee Signatory Section – Responsible corporate officer or duly authorized position		
Title	Name	Signature

<b>Delivery date: MM/DD/YYYY</b> /      /			
<b>Delivery #</b>	<b>Manifest Doc #:</b>	<b>pH</b>	<b>Temperature</b>
1			
2			
3			
4			
5			
6			
7			
8			
9			
10			
11			
12			
13			
14			
15			
16			
17			
18			
19			
20			
21			
22			
23			
24			
25			
26			
27			
28			
29			
30			
31			

**You must complete a separate form for each day.**



## Appendix F

### PRIMARY & SECONDARY DRINKING WATER STANDARDS & MINIMUM CRITERIA

Updated May 6, 2002

#### PRIMARY DRINKING WATER STANDARDS

##### PARAMETER

Alachlor (Polychlorinated Biphenyl or PCB)  
Aldicarb  
Aldicarb sulfoxide  
Aldicarb sulfone  
Aroclors (Polychlorinated Biphenyls or PCBs)  
Alpha, Gross  
Antimony  
Arsenic  
Atrazine  
Barium  
Benzene  
Benzo(a)pyrene  
Beryllium  
Bis(2-ethylhexyl) adipate (Di(2-ethylhexyl) adipate)  
Bis(2-ethylhexyl) phthalate (Di(2-ethylhexyl) phthalate)  
Cadmium  
Carbofuran  
Carbon Tetrachloride (Tetrachloromethane)  
Chlordane  
Chlorobenzene (Monochlorobenzene)  
Chloroethylene (Vinyl Chloride)  
Chromium  
Coliforms, Total  
Cyanide  
2,4-D (2,4-Dichlorophenoxyacetic acid)  
Dalapon (2,2-Dichloropropionic acid)  
Dibromochloropropane (DBCP)  
1,2-Dibromoethane (EDB, Ethylene Dibromide)  
1,2-Dichlorobenzene (o-Dichlorobenzene)  
1,4-Dichlorobenzene (p-Dichlorobenzene or Para Dichlorobenzene)  
1,2-Dichloroethane (Ethylene dichloride)  
1,1-Dichloroethylene (Vinylidene chloride)  
1,2-Dichloroethylene (cis-1,2-Dichloroethylene or trans-1,2-Dichloroethylene)  
cis-1,2-Dichloroethylene (1,2-Dichloroethylene)  
trans-1,2-Dichloroethylene (1,2-Dichloroethylene)  
Dichloromethane (Methylene chloride)  
1,2-Dichloropropane  
Di(2-ethylhexyl) adipate (Bis(2-ethylhexyl) adipate)  
Di(2-ethylhexyl) phthalate (Bis(2-ethylhexyl) phthalate)  
Dinoseb  
Diquat  
EDB (Ethylene dibromide, 1,2-Dibromoethane)  
Endothall  
Endrin  
Ethylbenzene  
Ethylene dichloride (1,2-Dichloroethane)  
Fluoride  
Glyphosate (Roundup)  
Gross Alpha  
Heptachlor  
Heptachlor Epoxide  
Hexachlorobenzene (HCB)  
gamma-Hexachlorocyclohexane (Lindane)  
Hexachlorocyclopentadiene  
Lead

## **PRIMARY & SECONDARY DRINKING WATER STANDARDS & MINIMUM CRITERIA**

Updated May 6, 2002

### **PRIMARY DRINKING WATER STANDARDS, CONT'D**

#### **PARAMETER**

Lindane (gamma-Hexachlorocyclohexane)  
Mercury  
Methoxychlor  
Methylene chloride (Dichloromethane)  
Monochlorobenzene (Chlorobenzene)  
Nickel  
Nitrate (as N)  
Nitrite (as N)  
Total Nitrate + Nitrite (as N)  
Oxamyl  
p-Dichlorobenzene or Para Dichlorobenzene (1,4-Dichlorobenzene)  
Pentachlorophenol  
Perchloroethylene (Tetrachloroethylene)  
Picloram  
Polychlorinated biphenyl (PCB or Aroclors)  
Radium  
Roundup (Glyphosate)  
Selenium  
Silver  
Silvex (2,4,5-TP)  
Simazine  
Sodium  
Styrene (Vinyl benzene)  
Tetrachloroethylene (Perchloroethylene)  
Tetrachloromethane (Carbon Tetrachloride)  
Thallium  
Toluene  
Toxaphene  
2,4,5-TP (Silvex)  
1,2,4-Trichlorobenzene  
1,1,1-Trichloroethane  
1,1,2-Trichloroethane  
Trichloroethylene (Trichloroethene, TCE)  
Trihalomethanes, Total  
Vinyl Chloride (Chloroethylene)  
Xylenes (total)

### **SECONDARY DRINKING WATER STANDARDS**

#### **PARAMETER**

Aluminum  
Chloride  
Color  
Copper  
Ethylbenzene  
Fluoride  
Foaming Agents (MBAS)  
Iron  
Manganese  
Odor  
pH  
Silver  
Sulfate  
Toluene  
Total Dissolved Solids (TDS)  
Xylenes  
Zinc



Fort Pierce Utilities Authority  
Water Reclamation  
403 Seaway Drive (PO Box 3191)  
Fort Pierce, FL 34949 (34948)

July 12, 2022

In the Matter of a Permit Application by: Allied New Technologies, Inc.  
3901 NW 115 Avenue  
Miami, FL 33178

For Discharge Storage Facility location: Allied New Technologies, Inc.  
821 S. Kings Highway – Unit D-111  
Ft. Pierce, Fl. 34945

Classification:	Minor Industrial User
Categorical Process:	N/A
Applicable Pretreatment Standard:	40 CFR Part 403
Production Activity	Water de-ionizing process
SIC No.:	325181
Permit No.:	FPUA-022

In accordance with the provisions of the Pretreatment Regulations Promulgated by the United States Environmental Protection Agency (EPA) in 40 CFR, Part 403, The State of Florida Pretreatment Regulations under Rule 62-625 Florida Administrative Code (F.A.C.) and The City of Ft. Pierce Ordinance, L-296, which governs the use of The Fort Pierce Utilities Authority (FPUA) Wastewater System, hereinafter may be called the "Ordinance," Allied New Technologies, Inc. hereafter referred to as the "Permittee," is hereby authorized to discharge process wastewater from the above discharge storage facility through Outfall-001 identified herein, into the FPUA Wastewater System in accordance with applicable Pretreatment Water Quality Standards and the conditions set forth in this permit.

Compliance with this permit does not relieve the Permittee of its' obligations to comply with any or all applicable pretreatment regulations, standards, or requirements under local, state (DEP Rule 62-625 F.A.C.), and federal laws, including any such regulations, standards, requirements, or laws that may become effective during the term of this permit.

Noncompliance with any term or condition of this permit is a violation of City of Ft. Pierce Ordinance, L-296. This permit shall become effective on, August 1, 2022 and shall remain in force for a period of one-year expiring, July 31, 2023. The sixty-day cutoff date for permit reapplication is June 1, 2023.

A handwritten signature in blue ink, appearing to read "Bowdoin G Hutchinson", is written over a horizontal line.

Bowdoin G Hutchinson, P.E.,  
DIRECTOR WWW SYSTEMS

## PART 1 - EFFLUENT LIMITATIONS

During the period of August 1, 2022 to July 31, 2023, the Permittee is authorized to discharge 21,600 gallons per day (GPD) to the WWS from the outfall listed below. Discharge will be limited to between the hours of 06:00 and 18:00.

1. **Description of Outfall:** Outfall-001 consists of a sample valve in the 2" drain line connected to the five storage tanks inside the discharge storage building, at the address listed on page 1 of this document. **(See Appendix-A, attached site drawing for location of Outfall-001)**
2. **Discharge from Outfall-001** is permitted to consist of pH Neutralized discharge wastewater from water de-ionizing process before Bleach production.

Table 1-1 Effluent Limits, Monitoring-Reporting Requirements

Effluent Limits			Monitoring-Requirements	
Pollutant or Pollutant Property:	Daily Maximum Limit:	Daily Maximum Limit Origin (FPN):	Sample Type:	Monitoring Location:
Sodium Chloride (NaCl)	2.5%	Permit	Grab	Sample Port *(Foot Note 3)
Conductivity	N/A	N/A	Continues 15 minute increments	Sample Port *(Foot Note 2)
pH	5-10 S.U.	FPUA Local Limit	Continues 15 minute increments	Before Sample Port *(Foot Note 2)
Discharge Volume	21,600 GPD	Volume Allocation	Continues with Daily Totalizer	Before Sample Port *(Foot Note 2)

- Footnotes:
1. If any Waters or Wastewaters are discharged, or are proposed to be discharged to the FPUA Wastewater System which contain substances in excess of the Daily Maximum Limit, as defined under Section V-II of the Ordinance, are subject to penalties and liable to FPUA for any expenses, loss, or damage caused by such violation or Discharge.
  2. Permittee shall install and maintain equipment to continuously monitor pH, Conductivity and Discharge Volume. (See Appendix-A, attached site drawing for location of Outfall-001)
  3. Sampling will be conducted at the designated sample valve. (See Appendix-A, attached site drawing for location of Outfall-001)

## PART 2 - MONITORING REQUIREMENTS

- A. **Monitoring Location:** The sample location will be in the exact location described in Part 1.
- B. **Monitoring Frequency:** Sodium Chloride samples shall be collected at the rate of 1 sample per month of discharge during the permit period. Effluent pH and Conductivity shall be monitored and recorded continuously and reported in Fifteen (15) minute increments. The Permittee shall report the results of all self-monitoring activities monthly, as described in Part 3 of this permit.



**PART 2 - MONITORING REQUIREMENTS CONTINUED**

- C. Discharge Volume: The Permittee shall monitor Flow continuously and record Totalizer Volume readings daily. The Permittee shall report the results of all self-monitoring activities monthly as described in Part 3 of this permit.
- D. pH and Conductivity Measurement:
1. The Permittee shall record effluent pH and Conductivity using permanently installed instruments.
  2. The pH and Conductivity sensor probes shall be mounted in a location that measures representative pretreated effluent discharged to the FPUA Wastewater System.
- E. pH and Conductivity Meter Calibration: Permanently installed pH and Conductivity instruments shall undergo annual certification by the manufacturer or an authorized representative of the manufacturer. Calibration of the permanently installed pH and Conductivity instrument shall be checked in accordance with the manufacturers recommendations at a minimum frequency of once per week. Calibration checks may be performed by the Permittee. Portable instruments for pH analysis shall be calibrated onsite immediately before pH analysis is performed. Instrument calibration shall be documented at each calibration interval using the Instrument Calibration form under Appendix D.
- F. Standard Operating Procedures: Sample collection, handling, preservation and laboratory analysis methods must follow EPA standards contained in 40 CFR 136 and the State of Florida, Department of Environmental Protection Standard Operating Procedure DEP-SOP-001/01 and subsequent revisions. Contents of DEP-SOP-001/01 are accessible at [www.dep.state.fl.us/labs/qa/sops/htm](http://www.dep.state.fl.us/labs/qa/sops/htm).

**PART 3 - REPORTING AND RECORD KEEPING REQUIREMENTS**

The Permittee shall at regular intervals, demonstrate compliance with FPUA Water Quality Standards as set forth herein.

- A. Self-Monitoring Report Submittal: Self-Monitoring Reports shall be submitted to FPUA according to the schedule outlined in Table 3-1.

Table 3-1 Reporting Schedule for Self-Monitoring Activities				
Monitoring Period:	August 1- 31	Sept 1 – 30	Oct 1 – 31	Nov 1 – 30
Report Due Date:	Oct 15	Nov 14	Dec 15	Jan 14
Monitoring Period:	Dec 1- 31	Jan 1 – 31	Feb 1 – 28	Mar 1 – 31
Report Due Date:	Feb 14	Mar 17	Apr 14	May 15
Monitoring Period:	Apr 1- 30	May 1 – 31	June 1 – 30	July 1 – 31
Report Due Date:	Jun 14	July 15	Aug 14	Sep 14

**PART 3 - REPORTING AND RECORD KEEPING REQUIREMENTS CONTINUED**

- B. Self-Monitoring Report Forms: Self-Monitoring Reports shall be submitted to FPUA using the forms contained in the Appendices section of this permit as outlined in Table 3- 2. Records including paid receipts and waste manifests for hauled waste produced during any monitoring period shall be submitted with the respective Self-Monitoring Report.

Report Submittal Form	Appendices	Permit Page No.
Outfall 001 Diagram	A	13
Self-Monitoring Results Form	B	14
Self-Monitoring Report Cover Sheet	C	15
Instrument Calibration Form	D	16
Discharge Volume Report Form	E	17

- C. Retention of Records: The Permittee shall retain records onsite of all monitoring information including all calibration and maintenance records and all original strip chart recordings for continuous monitoring instruments, copies of all reports required by this permit, and records of all data used to complete the application for this permit for a period of at least three years from the date of the sample, measurement, report, or application.
1. All records that pertain to matters that are the subject of special orders or any other enforcement or litigation activities brought by the FPUA shall be retained and preserved by the Permittee until all enforcement activities have been concluded and all periods of limitation with respect to any and all appeals have expired.
- D. Signatory Requirements: Self-Monitoring Reports must meet the signatory requirements of Chapter 62-625.600(11) FAC.
- E. Record Contents: Records of sampling and analysis shall include:
1. The date, exact place, time, methods of sampling or measurements, sample preservation techniques or procedures, Chain-of-Custody documentation and Instrument Calibration Log sheets.
  2. The person performing the sampling or measurement.
  3. The date(s) analyses were performed.
  4. The analytical techniques or methods used.
  5. The results of such analysis.

**PART 3 - REPORTING AND RECORD KEEPING REQUIREMENTS CONTINUED**

F. Emergency Reporting: In the event of a pretreatment system malfunction, chemical spill that reaches or threatens the FPUA wastewater system or other abnormal event where the Permittee is temporarily unable to comply with any of the conditions of this permit, FPUA shall be notified in person or by telephone within 24 hours of the incident. A written report describing the incident shall also be submitted to FPUA within five days of the time the Permittee becomes aware of the circumstances. The written report shall contain a complete description of and discuss the cause of the emergency, the period of noncompliance including exact dates and times. If the noncompliance has not been corrected include in the report the anticipated time the discharge is expected to continue. The report shall also describe the steps being taken to reduce, eliminate, and prevent recurrence of the event, and all other information deemed necessary by FPUA. A listing of contacts to which emergencies must be reported is contained in Part 5.

G. Reports required by this Permit shall be delivered to:

Fort Pierce Utilities Authority  
C/O Samantha Rowland  
403 Seaway Drive  
Fort Pierce, FL 34949

**PART 4 - SPECIAL CONDITIONS**

A. Compliance Schedule: NONE

B. Pretreatment system operation and maintenance: Pretreatment system operation and maintenance shall be performed in a manner that provides maximum protection of the WWS to which the Permittees effluent is discharged.

C. Prohibited Discharges:

1.0 General prohibitions:

a. The Permittee will not introduce into the WWS any pollutant which causes pass through or interference.

2.0 Specific prohibitions: The following pollutants shall not be introduced into the WWS:

a. Pollutants which create a fire or explosion hazard in the WWS;

b. Pollutants which will cause corrosive structural damage to the WWS, but in no case discharges with pH lower than 5.0, unless the WWS is specifically designed to accommodate such discharges;

c. Solid or viscous pollutants in amounts which will cause obstruction to the flow in the WWS resulting in interference;

**PART 4 - SPECIAL CONDITIONS CONTINUED**

- d. Any pollutant, including oxygen-demanding pollutants, released at a flow rate or pollutant concentration which will cause interference with the WWS;
- e. Heat in amounts which will inhibit biological activity in the WWS resulting in interference, but in no case heat in such quantities that result in the discharge from treatment plant having a temperature that exceeds 40° C (104°F) unless the approval authority, upon request of the control authority, approves alternate temperature limit in accordance with Rule 62.302.520, F.A.C.;
- f. Petroleum oil, non-biodegradable cutting oil, or products of mineral oil origin in amounts that will cause interference or pass through.
- g. Pollutants which result in the presence of toxic gases, vapors, or fumes within the WWS in a quantity that will acute worker health and safety problems;
- h. Any trucked or hauled pollutants, except at discharge points designated by the control authority.
- i. Dilution prohibited as a substitute for treatment except where expressly authorized to do so by an applicable pretreatment standard or requirement. No industrial user shall ever increase the use of process water, or in any other way attempt to dilute a discharge as a partial or complete substitute for adequate treatment to achieve compliance with a pretreatment standard or requirement. The control authority shall impose mass limitations on industrial users which are using dilution to meet applicable pretreatment standards or requirements.
- j. There shall be no discharge of polychlorinated biphenyl compounds such as those used for transformer fluid, 40 CFR Part 423.16 (a).
- k. The Permittee will abide by Florida Department of Environmental Protection Rule 62-625.400 F.A.C. concerning general and specific prohibitions.

**PART 5 - STANDARD CONDITIONS****A. Bypass:**

- 1. A User may allow a bypass to occur which;
  - a. Does not cause Water Quality Standards or requirements to be violated and is for essential maintenance to assure efficient operation;

**PART 5 - STANDARD CONDITIONS CONTINUED**

- b. Was unavoidable to prevent loss of life, personal injury, or severe property damage; or
- c. Was unavoidable because there were no feasible alternatives to the bypass, such as the use of auxiliary treatment facilities, retention of untreated wastes, or maintenance during normal periods of equipment downtime.

**B. Notice:**

- 1. If the Permittee knows in advance of the need for a bypass, it shall submit a notice to FPUA at least ten days before the date of the bypass. If the Permittee does not know of the need for a bypass ten days prior to the bypass then the Permittee shall notify FPUA immediately upon knowledge of the need for the bypass.
- 2. The Permittee shall submit oral notice of an unanticipated bypass to FPUA within 24 hours from the time it becomes aware of the bypass. A written submission shall also be provided within 5 days of the time the Permittee becomes aware of the bypass. The written submission shall contain:
  - a. A description of the bypass and its cause;
  - b. The duration of the bypass, including exact dates and times, and, if the bypass has not been corrected, the anticipated time it is expected to continue; and
  - c. Steps taken or planned to reduce, eliminate, and prevent recurrence of the bypass

C. Duration: This permit is issued for a period of one year.

D. Severability: The provisions of this permit are severable, and if any provision of this permit, or the application of any provision of this permit to any circumstance, is held invalid, the application of such provision to other circumstances and the remainder of this permit shall not be affected thereby.

E. Duty to Comply: The Permittee must comply with all conditions of this permit. Failure to comply with the requirements of this permit may be grounds for administrative action or enforcement proceedings including civil or criminal penalties, injunctive relief, and summary abatements.

**PART 5 - STANDARD CONDITIONS CONTINUED**

- F. Duty to Mitigate: The Permittee shall take all reasonable steps to minimize or correct any adverse impact to the public treatment plant or the environment resulting from noncompliance with this permit, including such accelerated or additional monitoring as necessary to determine the nature and impact of the non-complying discharge.
- G. Non-transferability: Wastewater Discharge Permits are issued to a specific user for a specific operation and are not assignable to another user or transferable to any other location without the prior written approval of the Director of Utilities. Sale of the source company shall obligate the purchaser to seek a new permit prior to discharge to the WWS.
- H. Civil and Criminal Liability:
1. Nothing in this permit shall be construed to relieve the Permittee from administrative, civil and/or criminal penalties for noncompliance with Ordinance L-296, or state or federal laws or regulations.
  2. Section 20-242 and 20-242.5 of Ordinance L-296 provides that any person, firm or corporation violating the provisions of the Ordinance shall be punished as provided under Section 403.151 Florida Statutes and Florida Administrative Code Section 62-625.500 for each act of violation, for each day of violation. Each day is a new violation. FPUA has the authority to assess penalties starting at \$1,000 per day for each willful violation. The Permittee may also be subject to sanctions under other state and federal laws. Standard penalties and surcharge schedules reflected in Tables 5-1, 5-2, 5-3 and 5-4 are taken from FPUA's approved Enforcement Response Plan. These tables are included to communicate the magnitude of penalties that can be assessed for violations.

**PART 5 - STANDARD CONDITIONS CONTINUED****TABLE 5-1**

Industrial Pretreatment Fine Table for pH  
(Allowable pH Limits – 5.00 to 10.00)

Low pH Violation	High pH Violation	Fine Amount
4.50 to 4.99	10.00 to 10.49	\$250
4.00 to 4.49	10.50 to 10.99	\$375
3.50 to 3.99	11.00 to 11.49	\$500
3.00 to 3.49	11.50 to 11.99	\$625
2.50 to 2.99	12.00 to 12.49	\$750
2.00 to 2.49	12.50 to 12.99	\$875
Less than 2.00	13.00 and above	\$1,000

Note: Violation is determined by:

1. Grab sample in excess of limits.
2. If continuous monitor, exceeding limits by 15 minutes or longer.
3. Fines may be assessed on a per day basis.

**TABLE 5-2**

Industrial Pretreatment Penalty Fine Level

Fine Category	Fine Level					
	A	B	C	D	E	F
Late Report Submittals	5 days	10 days	15 days	20 days	25 days	30 days
TTO, mg/L	2.13	4.26	6.39	8.52	10.65	12.78
Derived Local Limit	C	2XC	3xC	4xC	5xC	6xC

Note:

Total Toxic Organic (TTO) shall be the total amount of regulated organics defined for the individual industry.

Derived Local Limit shall be the enforceable limit specifically derived for regulating industry and approved by the State of Florida Department of Environmental Protection.

Refer to Table 5-3 to determine fine amount, based upon the factor by which a measured sample result exceeds the Derived Local Limit Concentration (C) under "Fine Level."

Derived Local Limit for pollutants of concern are contained in Section 3 of the FPUA Industrial Pretreatment Program Manual.

**PART 5 - STANDARD CONDITIONS CONTINUED****TABLE 5-3**

Industrial Pretreatment Fine Table

*(For Maximum Concentration Limits Other Than BOD, TSS, pH and Temperature)*

<b>Fine Level</b>	<b>Violation Level</b>	<b>Fine Amount</b>
A	Results less than or equal to the limit.	None
B	Violations greater than the limit but less than two times the limit.	\$250
C	Violations equal to two times the limit but less than three times the limit.	\$375
D	Violations equal to three times the limit but less than four times the limit.	\$500
E	Violations equal to four times the limit but less than five times the limit.	\$750
F	Violations equal to or greater than a slug discharge (five times the limit).*	\$1,000

\*A slug discharge may also be subject to further penalties and enforcement actions as determined by the director or his/her designee.

**I. Operating Upsets and Slug Loading**

1. Any user that experiences an upset in operations that places the user in a temporary state of noncompliance with these Rules and Regulations or a Wastewater Discharge Permit issued pursuant hereto shall inform FPUA within 24 hours of first awareness of the commencement of the upset.
2. Where such information is given orally, a written follow-up report shall be filed by the user with the FPUA within 5 calendar days providing the following information:
  - 2.1 Description of the upset, the cause thereof and the impact on the user's compliance status.
  - 2.2 Duration of noncompliance including exact dates and times of noncompliance and if the noncompliance continues the time by which the compliance is reasonably expected to occur.
  - 2.3 All steps taken or to be taken to reduce, eliminate and prevent recurrence of such an upset or other conditions of noncompliance. The report must also demonstrate that the treatment facility was being operated in a prudent and workmanlike manner.



**PART 5 - STANDARD CONDITIONS CONTINUED**

2.4 A documented and verified operating upset shall be an affirmative defense to any enforcement action brought against the Permittee for violations attributable to the upset event.

- J. Automatic Resample: If the results of the Permittee's wastewater analysis indicate a violation has occurred, the Permittee must notify the FPUA within 24 hours of becoming aware of the violation and repeat the sampling and pollutant analysis and submit, in writing, the results of this repeat analysis within 30 days after becoming aware of the violation.
- K. Slug Discharge Control Plan: If the potential for a slug discharge is identified by the FPUA to exist the Permittee may be required to develop a slug control discharge plan.
- L. Planned Changes: The Permittee shall give notice to the FPUA ninety days prior to any facility expansion, production increase, or process modifications resulting in new or substantially increased discharges or a change in the nature of the discharge.
- M. Emergency Contacts: The Permittee shall give notice to the FPUA in the event of accidental discharge, pretreatment system bypass, pretreatment system malfunction, or any instance of noncompliance according to the notification requirements for the condition being reported under Parts 3 and 5 of this permit.

Table 5-4

Column-1 Permit Section - Incident Description:	Column-2	Column-3
Part 3E. ABNORMAL EVENT	YES	NO
Part 4B. PRET. SYSTEM MALFUNCTION	YES	NO
Part 5A. BYPASS	YES	YES
Part 5H. OPERATING UPSET	YES	YES
Part 5I. ACCIDENTAL DISCHARGE	YES	YES
Emergency Contact:	Samantha Rowland FPUA	Mark Kobbe, FPUA
Title:	Pret. Coordinator	WW. Superintendent
Phone/Extension:	(772) 466-1600, 5526	(772) 466-1600, 5525
Cell phone:	(772) 302-0565	
Fax:	(772) 489-5907	(772) 489-5907
Email:	srowland@fpu.com	mkobbe@fpu.com

## Instructions:

- Determine what type of incident is occurring at your facility under Column-1
- Review the section of your permit that pertains to that type of incident
- Contact each person in Columns 2 and 3 having **YES** above their name for the particular type incident listed under Column 1

**PART 5 - STANDARD CONDITIONS CONTINUED**

Appendices:

Appendix	Page No.	Description:
A	13	Outfall 001 Diagram
B	14	Self-Monitoring Report
C	15	Self-Monitoring Report Cover Page
D	16	Calibration Log
E	17	Discharge Volume Report

Appendix A, Allied New Technologies, Inc. Outfall 001 Diagram

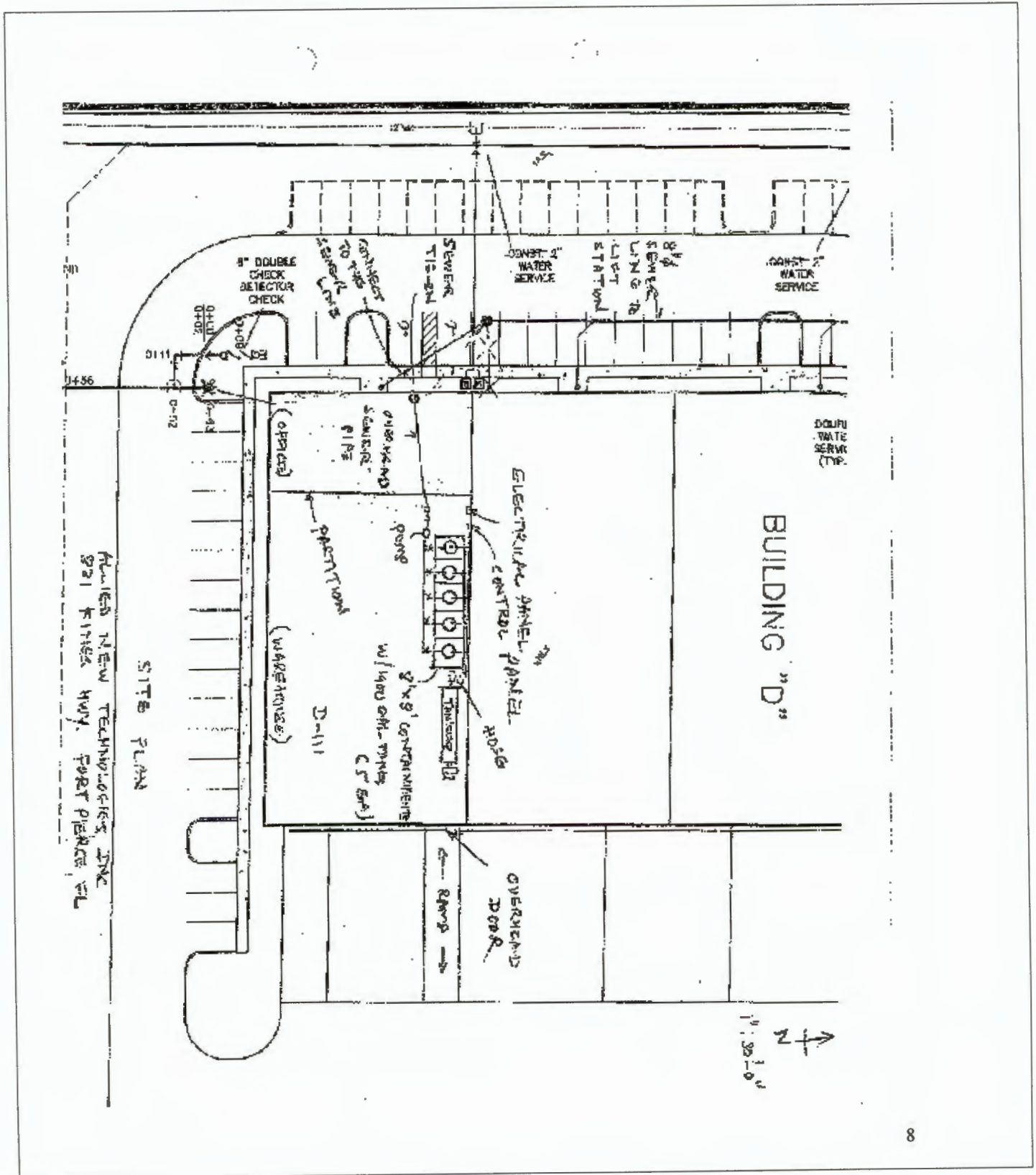

**Appendix B, Allied New Technologies, Inc. Self-Monitoring Report**

Self-Monitoring Report Results Form			Outfall-001	
Sample collection date: MM/DD/YYYY ____/____/____			Compliant?	
Pollutant:	Permit limit:	Results	Yes	No
NaCl	2.5%		<input type="checkbox"/>	<input type="checkbox"/>
Chloride	(Informational Only)		<input type="checkbox"/>	<input type="checkbox"/>
Sodium	(Informational Only)		<input type="checkbox"/>	<input type="checkbox"/>
pH	5.0 – 10.0 S.U.		<input type="checkbox"/>	<input type="checkbox"/>

Instructions for completing Self-Monitoring Report Results Form:

1. Record sample collection date.
2. Record analytical results.
3. Compare analytical results with permit limit for each pollutant.
4. Were violations detected?

<input type="checkbox"/> -NO	Follow normal reporting procedure	<input type="checkbox"/> -YES	Notify FPUA within 24-hours
------------------------------	-----------------------------------	-------------------------------	-----------------------------

Certification Statement:

I certify under penalty of law that this document and all attachments were prepared under my direction or supervision in accordance with a system designed to assure that qualified personnel properly gather and evaluate the information submitted. Based on my inquiry of the person or persons who manage the system, or those persons directly responsible for gathering the information, the information submitted is to the best of my knowledge and belief, true, accurate, and complete. I am aware that there are significant penalties for submitting false information, including the possibility of fine and imprisonment for knowing violations. I affirm that sample collection, preservation and analysis were performed in strict accordance with the State of Florida, Department of Environmental Protection Standard Operating Procedures for Laboratory Operations and Sample Collection Activities, DEP-SOP-001/01.

Only a responsible corporate officer or duly authorized individual or position may sign this report under the provisions of Chapter 62.625.600(11) FAC.

Permittee Signatory Section – Responsible corporate officer or duly authorized position		
President	Jim Palmar	
Title	Name	Signature

**Appendix C. Allied New Technologies, Inc. Self Monitoring Report Cover Sheet**

Report Date, Select Month , Select Year

Check Report Period			
<input type="checkbox"/> -Aug 2022	<input type="checkbox"/> -Sept 2022	<input type="checkbox"/> -Oct 2022	<input type="checkbox"/> -Nov 2022
<input type="checkbox"/> -Dec 2022	<input type="checkbox"/> -Jan 2023	<input type="checkbox"/> -Feb 2023	<input type="checkbox"/> -Mar 2023
<input type="checkbox"/> -April 2023	<input type="checkbox"/> -May 2023	<input type="checkbox"/> -June 2023	<input type="checkbox"/> -July 2023

Report Submittal checklist: This Report includes:

- Appendix A. Outfall 001 diagram with sample locations
- Appendix B. Self-Monitoring Report Results Form
- Appendix C. Self-Monitoring Report Cover Sheet
- Appendix D. Instrument Calibration Form
- Appendix E. Discharge Volume Report Form
- Chain-of-Custody forms for samples collected
- Laboratory analytical reports
- Hauled Wastes Receipts and Waste Manifests
- Copies of pH Graphs
- Copies of Conductivity Graphs
- Copies of Email Correspondence

Reminders:

The Permittee must re-apply for this permit no later than, June 1, 2023.

Permit limit violations must be reported to FPUA within 24-hours of the first awareness followed by written notification within 5-calendar days.

FPUA Use					
Report Submittal Compliance Review			Sample Collection and Preservation:		
Report Due Date: ____-____-____	Date Received: ____-____-____		Proper Sample Collection Procedures?	<input type="checkbox"/> -Yes	<input type="checkbox"/> -No
Is Report Complete?	<input type="checkbox"/> -Yes	<input type="checkbox"/> -No	Preserved Properly?	<input type="checkbox"/> -Yes	<input type="checkbox"/> -No
Is Report On-time?	<input type="checkbox"/> -Yes	<input type="checkbox"/> -No	Data Qualifiers?	<input type="checkbox"/> -Yes	<input type="checkbox"/> -No
If not on-time is report >30 days late?	<input type="checkbox"/> -Yes	<input type="checkbox"/> -No	<b>Effluent Compliance Review</b>		
Does report meet 62-625.600(11) FAC Signature Requirements?	<input type="checkbox"/> -Yes	<input type="checkbox"/> -No	Were all pollutants monitored?	<input type="checkbox"/> -Yes	<input type="checkbox"/> -No
SMR Entered into Database	<input type="checkbox"/> -Yes	<input type="checkbox"/> -No	Results Compliant?	<input type="checkbox"/> -Yes	<input type="checkbox"/> -No
			Enforcement Required?	<input type="checkbox"/> -Yes	<input type="checkbox"/> -No
			Do Surcharges Apply?	<input type="checkbox"/> -Yes	<input type="checkbox"/> -No
Reviewed By:				Date: ____-____-____	



**Appendix E** Allied New Technologies, Inc. Discharge Volume Report Form

Month:		Year:			
Day:	Effluent pH:	Sample Collection Agency/Time:	Totalizer reading:	Totalizer reading:	Gallons discharged:
31			31		
30			30		
29			29		
28			28		
27			27		
26			26		
25			25		
24			24		
23			23		
22			22		
21			21		
20			20		
19			19		
18			18		
17			17		
16			16		
15			15		
14			14		
13			13		
12			12		
11			11		
10			10		
9			9		
8			8		
7			7		
6			6		
5			5		
4			4		
3			3		
2			2		
1			1		
End			End		